

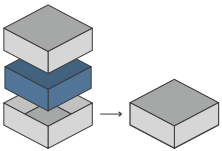

ACCESSORY - COMPATIBLE WITH
ONE CARD DUNGEON
 (BASE GAME OR WITH M'GUF-YN RETURNS EXP)



Designed to fit into the game box; flush closure is guaranteed. Progettato per inserirsi all'interno della scatola del gioco; garantisce chiusura a filo*

Designed for both sleeved and unsleeved cards. Adatto sia per carte imbustate che non imbustate*



* Any doubt?
 Check out our FAQ page or download the digital version of the instructions on our website!

All trademarks and copyrights are the property of their respective owners. This product is not a toy. Contains small parts that can be swallowed or inhaled. 14+



ACCESSORY - COMPATIBLE WITH
ONE CARD DUNGEON
 (BASE GAME OR WITH M'GUF-YN
 RETURNS EXP)



INSTRUCTIONS

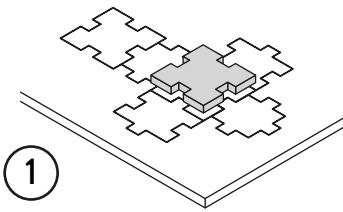

1

Gently take off
all the pieces.
Stacca delicatamente
dal foglio tutti i pezzi.

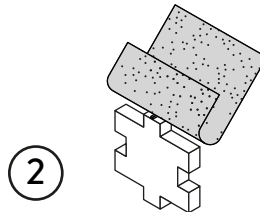

2

If necessary, use sand paper to
smoothen the borders.
Se necessario rifila con carta
vetrata per legno eventuali
imperfezioni dei pezzi.

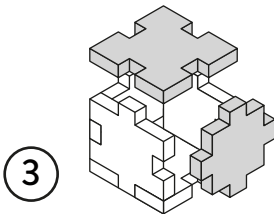

3

Get familiar with
all the pieces
and check the correct assembly
sequence.
Prendi familiarità con tutti
i pezzi, per assicurarti
che la sequenza di assemblaggio sia
corretta.

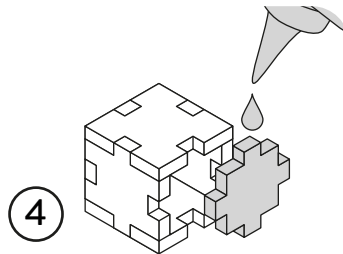

4

Once verified the correct assembly
sequence, just add a small quantity
of PVA glue on every joint.
Dopo aver verificato
la sequenza di assemblaggio
aggiungi una piccola quantità di
colla vinilica su tutti
gli incastri per garantirne
la durata nel tempo.

A



DT-167

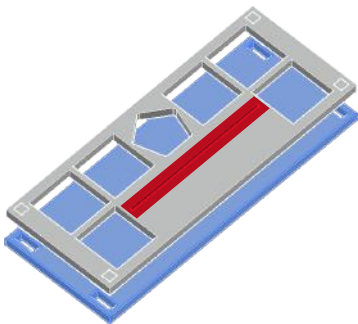
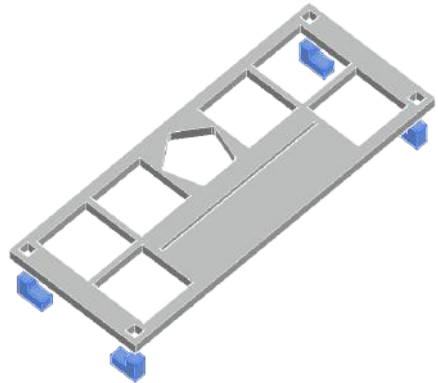
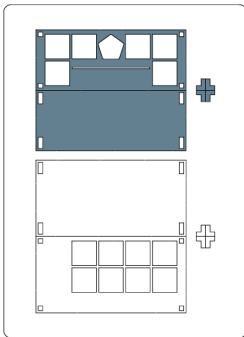

NOTE: Don't use glue under the area marked in red so as not to invalidate the use of the card holder. Non usare colla sotto l'area segnalata in rosso per non invalidare l'utilizzo del portacarte.

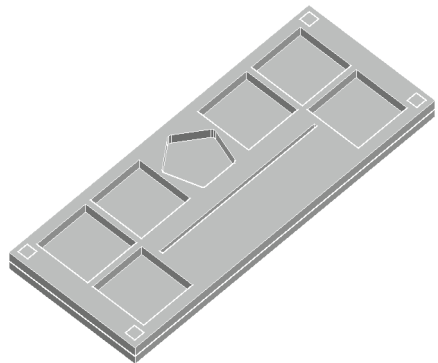

B



DT-167

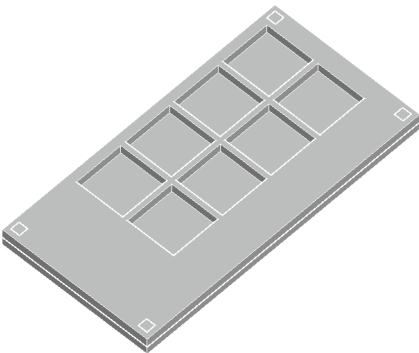
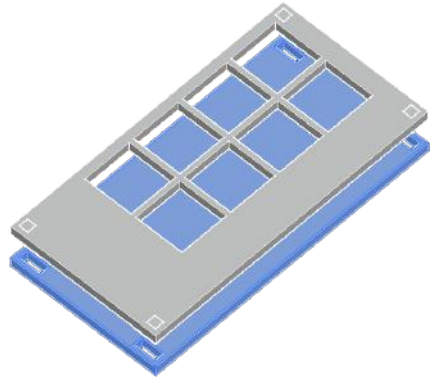
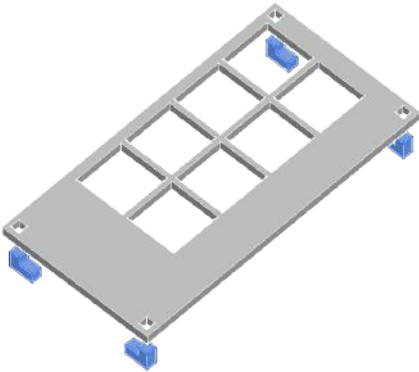
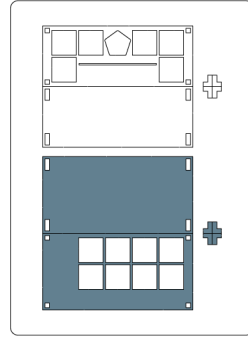

REBOXING SEQUENCE!



Non-recyclable waste.
Smaltire i materiali di scarto
nell'indifferenziata.

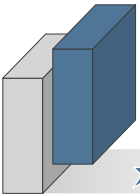

**VERTICAL
STORAGE
SAFETY**



Every piece will stay in its slot. Follow the reboxing sequence to properly store your organizer. We recommend using a h-band to avoid accidental box opening. Don't shake. Ogni componente rimarrà al suo posto. Segui la sequenza di reinserimento per riporre nella maniera corretta il tuo organizer. Consigliamo l'utilizzo di una h-band per evitare aperture accidentali. Non scuotere.

All trademarks and copyrights are the property of their respective owners.
This product is not a toy. Contains small parts that can be swallowed or inhaled. 14+