

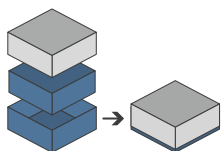

ORGANIZER - COMPATIBLE WITH WINGSPAN ALL IN + WINGSPAN DICE TOWER



The provided lifted base will replace the original box base and will allow a perfect closure using the lid from the original game. La base alzata inclusa sostituisce la base della scatola del gioco permettendo la chiusura a filo utilizzando il coperchio originale del gioco*



Designed for both sleeved and unsleeved cards. Adatto sia per carte imbustate che non imbustate*

29.6 x 29.6 x 11.8 cm



Size of assembled organiser
Dimensioni organizer assemblato

ORGANIZER CAPACITY

1x card holder, with dedicated slots; 1x egg tray, with dedicated slots; 2x food and nectar boxes, with dedicated slots; 1x player cubes tray, with dedicated slots; 1x objective tokens tray. Drawer for setup tokens; 1x cubes and meeples tray, from Asia exp; 1x dice holder for expansion sets; 1x lifted base; 1x dice tower. 1x portacarte, con slot dedicati; 1x contenitore uova con slot dedicati; 2x contenitori cibo e nettare con slot dedicati; 1x tray cubi giocatore, con slot dedicati; 1x contenitore per token obiettivo. Cassetto inferiore per token setup; 1x contenitore cubi e meeple esp Asia; 1x portadadi per set espansioni; 1x base alzata; 1x torre lanciadadi.



* Any doubt?
Check out our FAQ page or download the digital version of the instructions on our website!

All trademarks and copyrights are the property of their respective owners.
This product is not a toy. Contains small parts that can be swallowed or inhaled. 14+





ORGANIZER - COMPATIBLE WITH WINGSPAN ALL IN + WINGSPAN DICE TOWER



TUTORIAL - THE DICETROYERS DICE!

Among the pieces to assemble, you'll find a dice. This is not part of the organizer, but it can be a good starting point to practice!

Tra i materiali da assemblare troverai un dado. Questo componente non fa parte dell'organizer, né del gioco, ma è un ottimo punto di partenza per fare un po' di pratica.

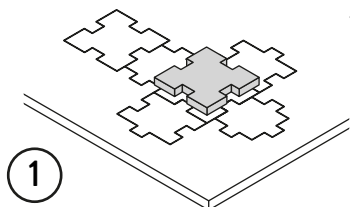

1

Gently take off
all the pieces.
Stacca delicatamente
dal foglio tutti i pezzi.

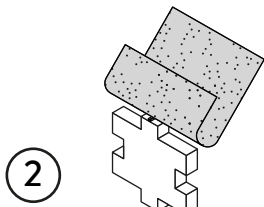

2

If necessary, use sand paper to
smoothen the borders.
Se necessario rifila con carta
vetrata per legno eventuali
imperfezioni dei pezzi.

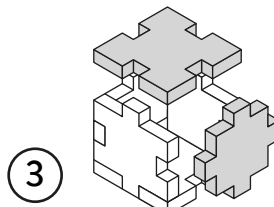

3

Get familiar with
all the pieces
and check the correct assembly
sequence.
Prendi familiarità con tutti
i pezzi, per assicurarti
che la sequenza di assemblaggio sia
corretta.

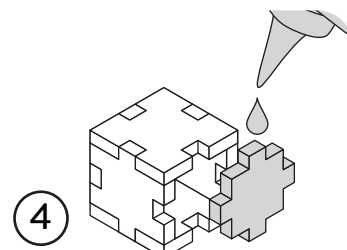

4

Once verified the correct assembly
sequence, just add a small quantity
of PVA glue on every joint.
Dopo aver verificato
la sequenza di assemblaggio
aggiungi una piccola quantità di
colla vinilica su tutti
gli incastri per garantirne
la durata nel tempo.

INSTRUCTIONS

A

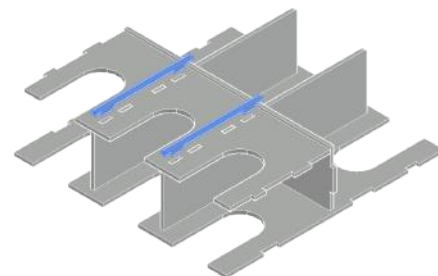
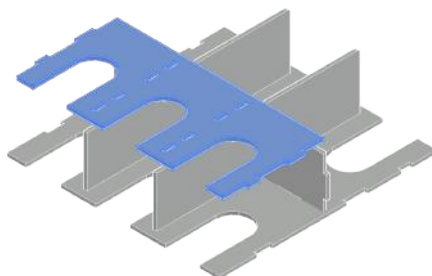
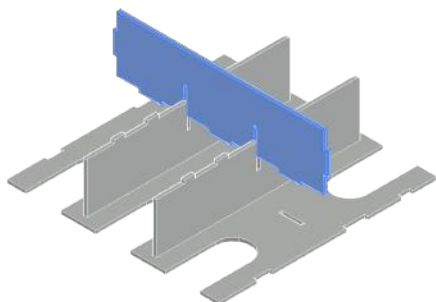
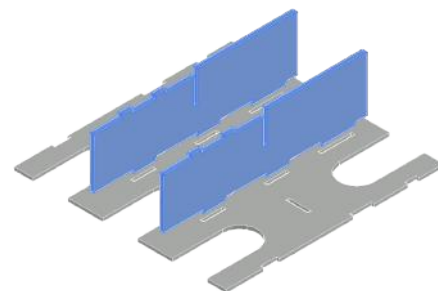
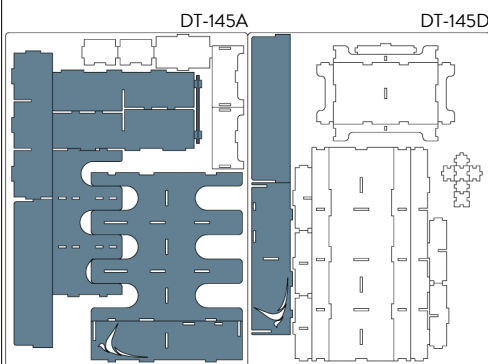

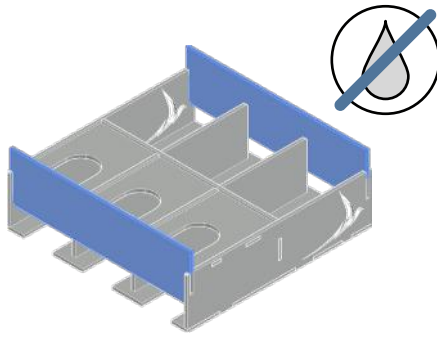
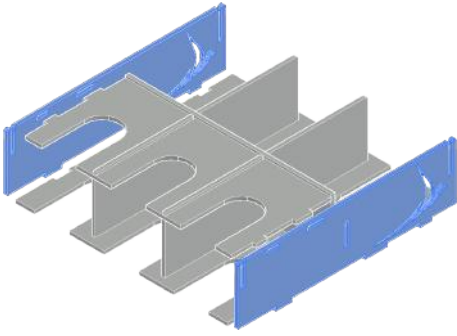

NOTE: Don't use glue on these joints; these pieces can be removed during the game.
 Non usare colla su questi incastrati, pezzi rimovibili durante il gioco.

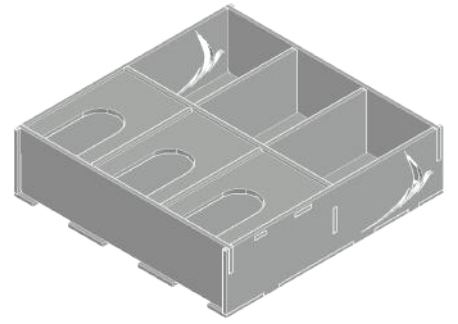

NOTE: Use the top layer during the game for the 3 revealed cards. Utilizza la parte superiore durante il gioco per le 3 carte scoperte.

B

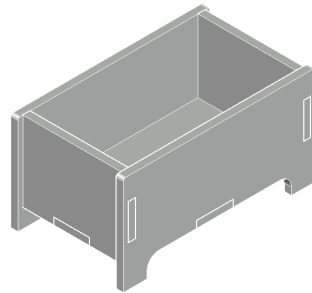
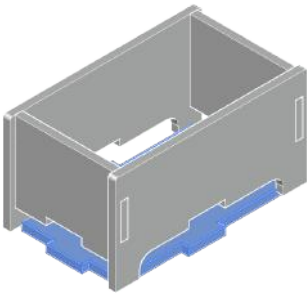
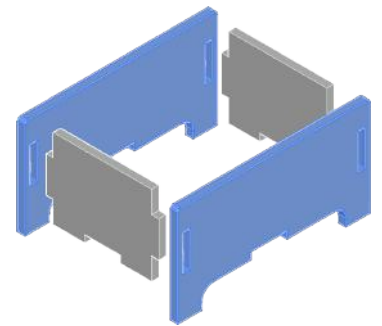
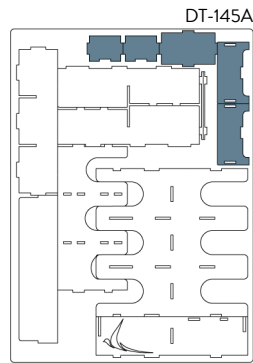

C

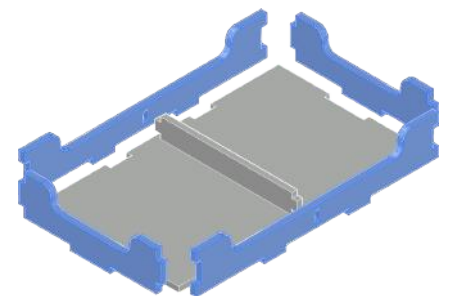
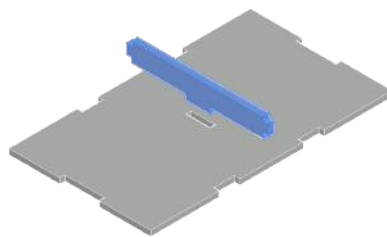
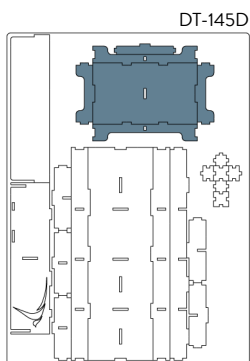

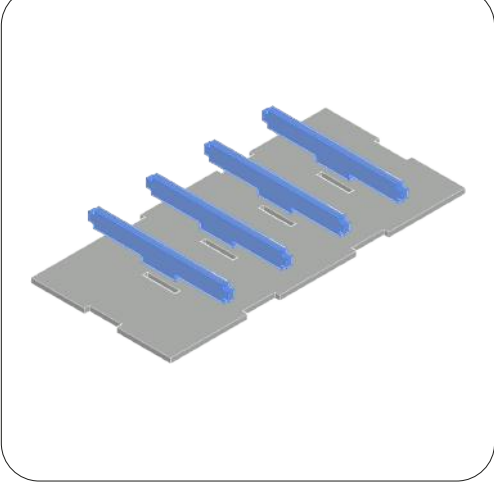
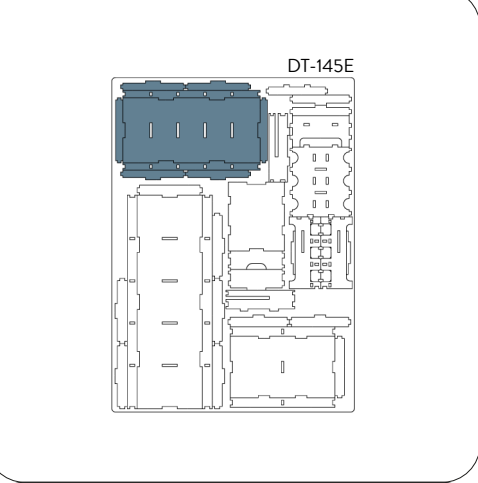
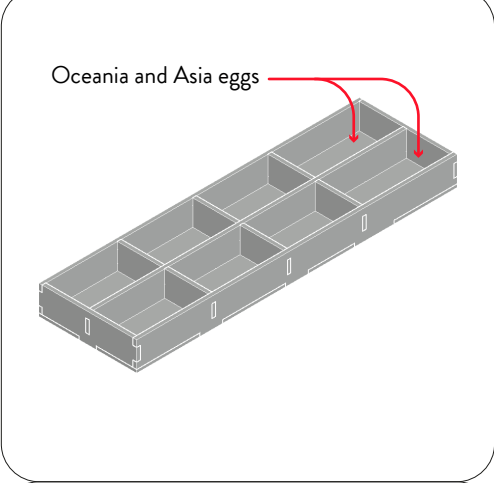
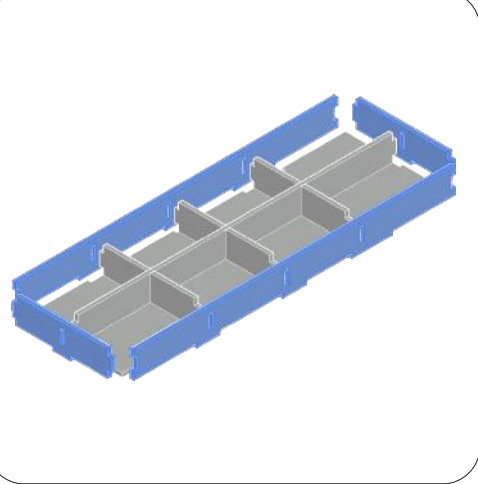
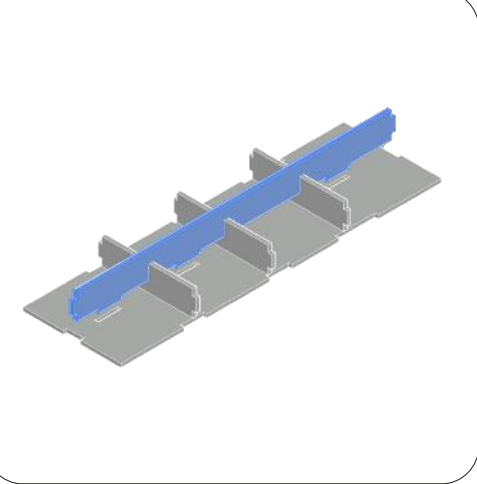
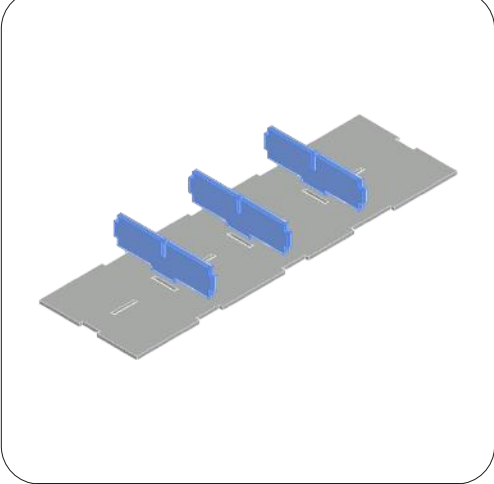
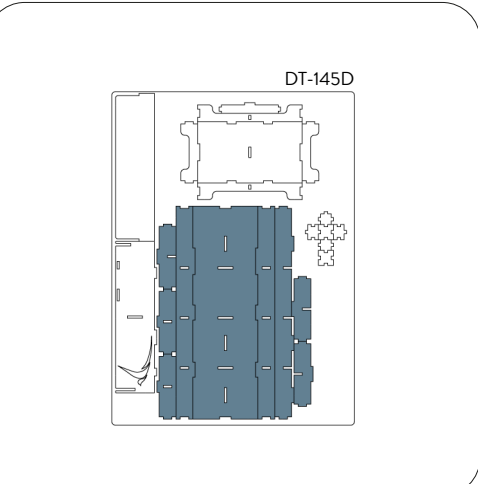
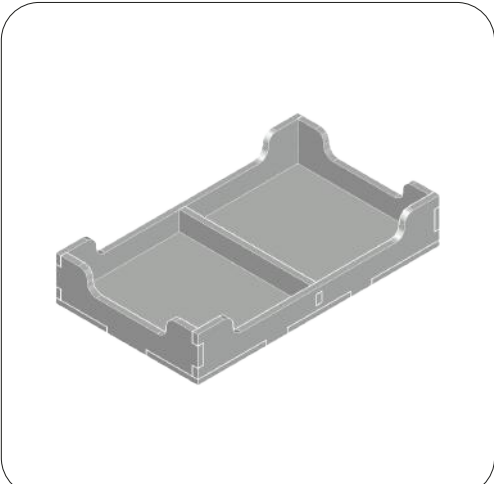

F



DT-145E

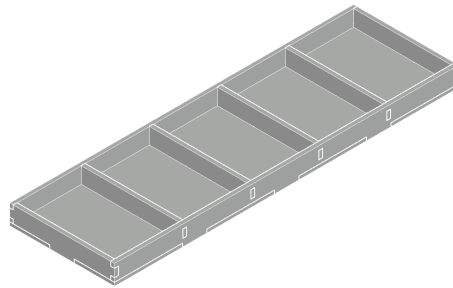
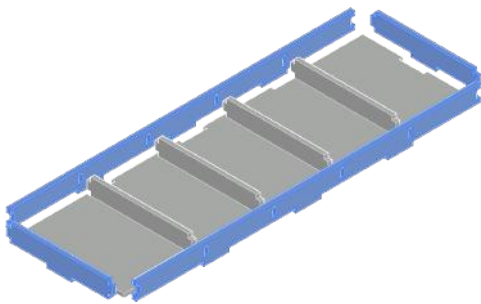
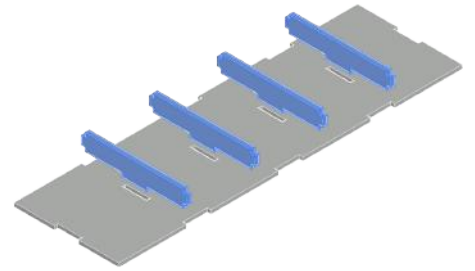
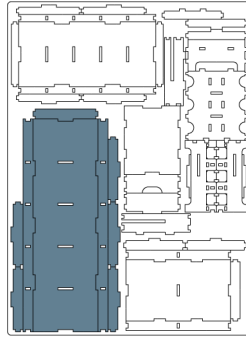

G



DT-145E

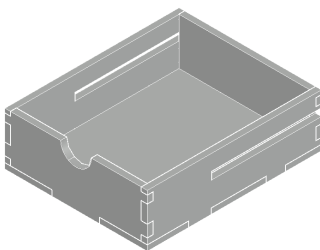
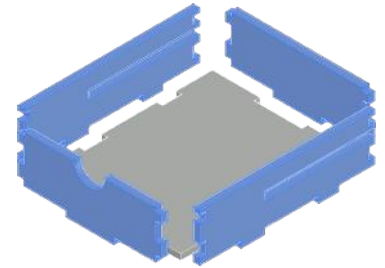
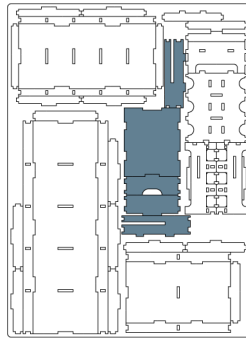

DT-145E

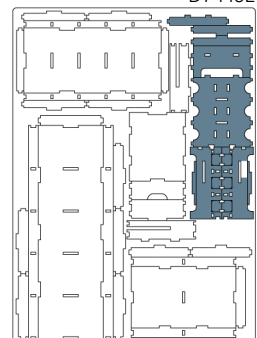

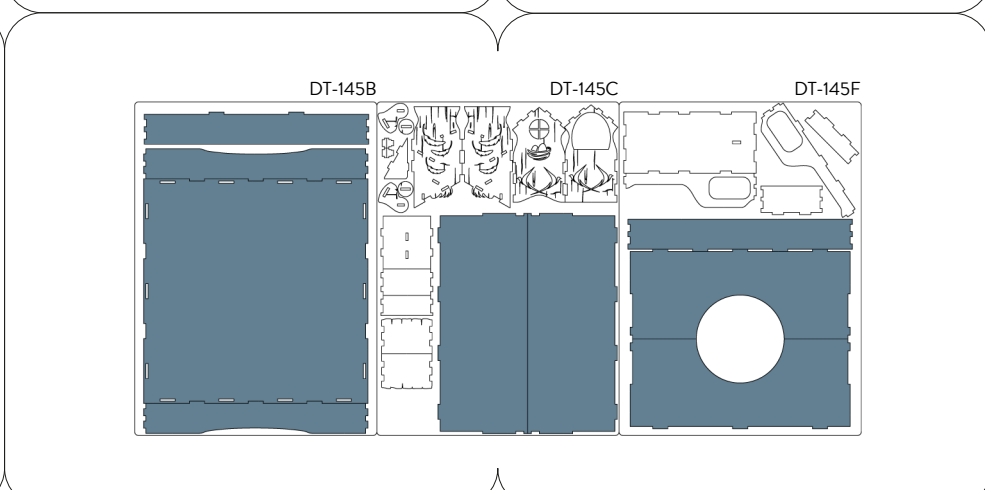
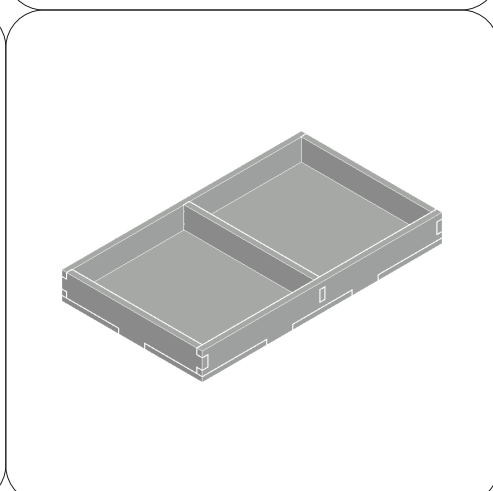
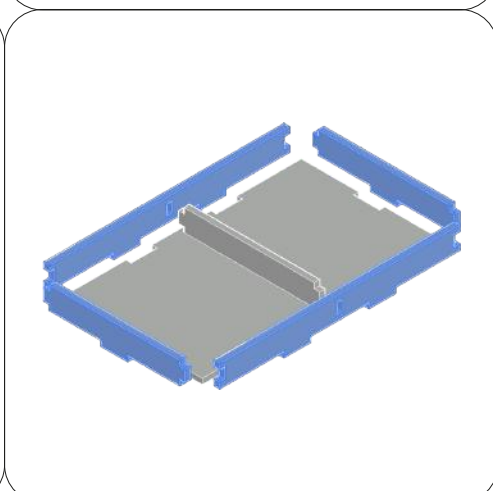
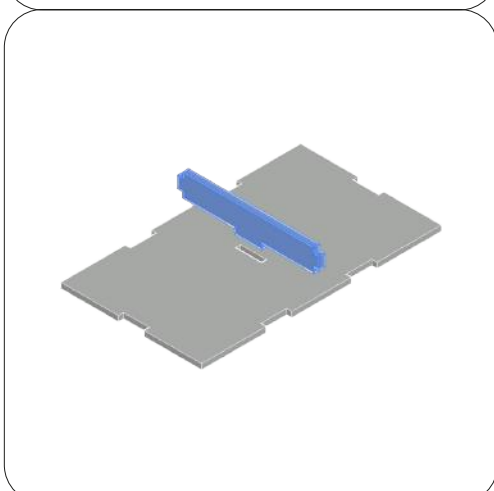
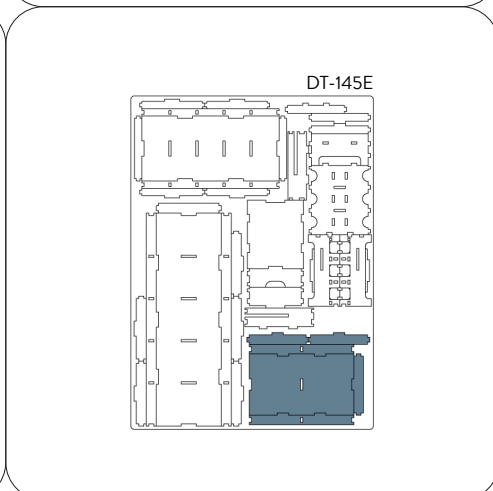
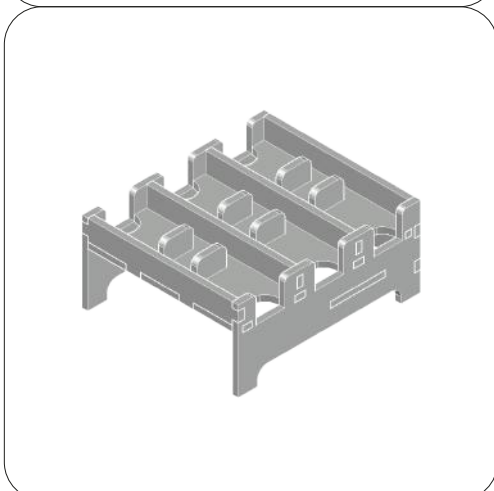
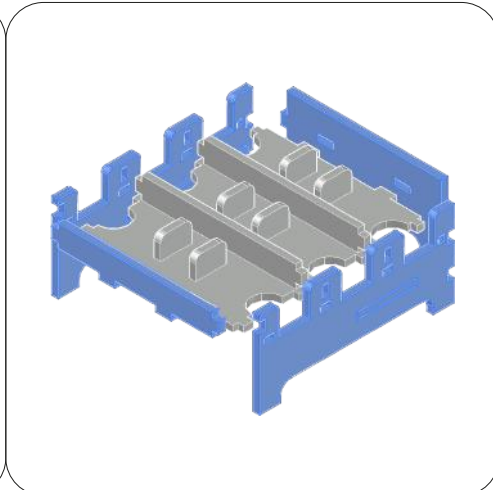
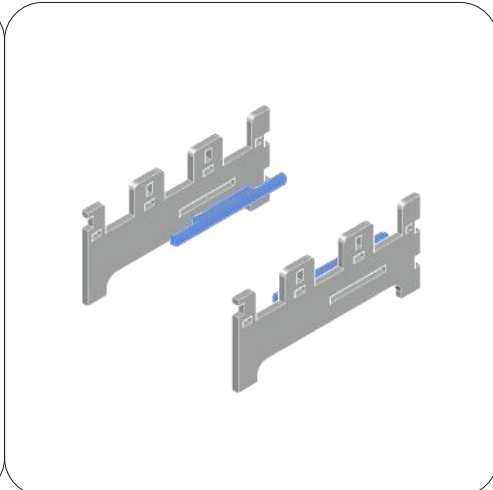
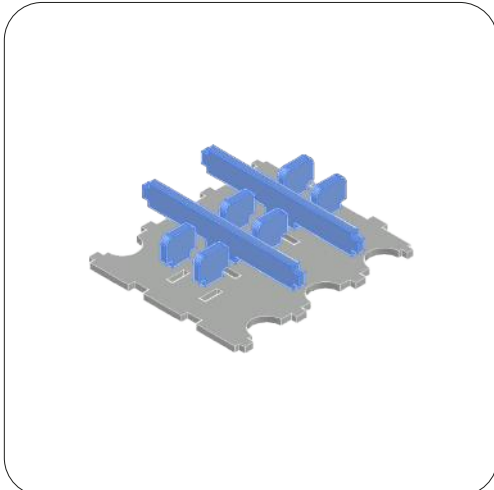

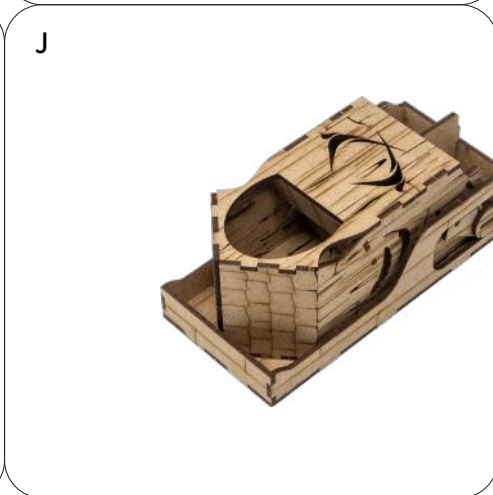
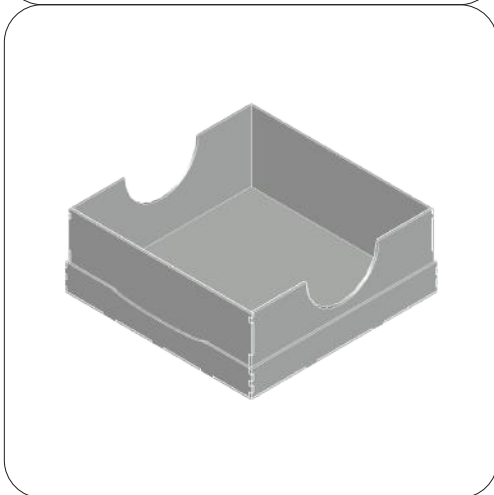
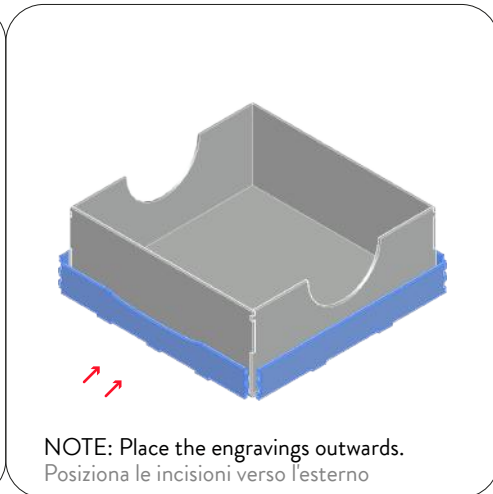
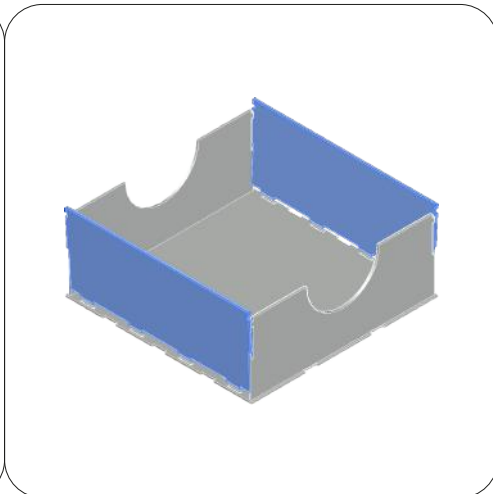
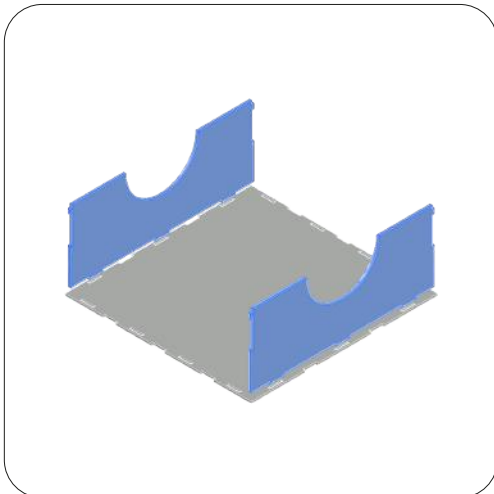

NOTE
While assembling remember that the engraved sides must be facing outwards.
Mentre assembli ricorda che i lati incisi vanno rivolti verso l'esterno.

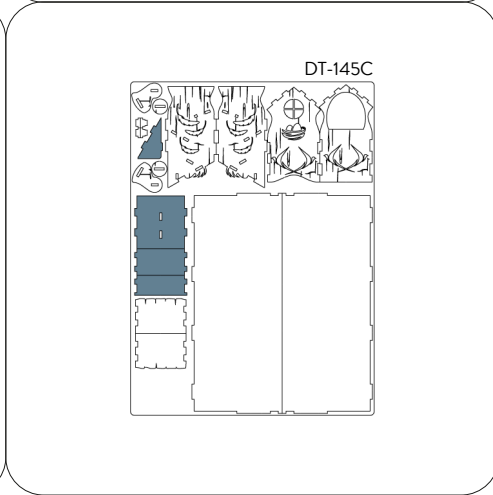
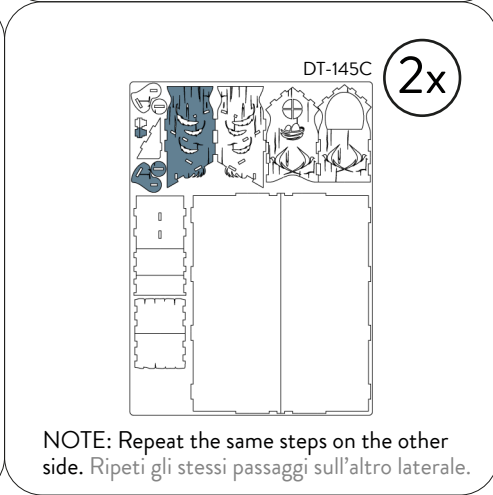
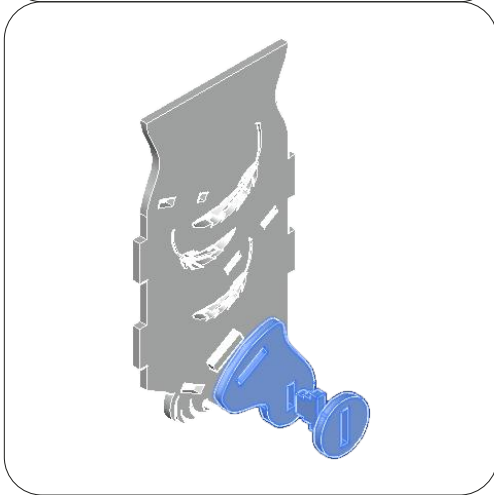
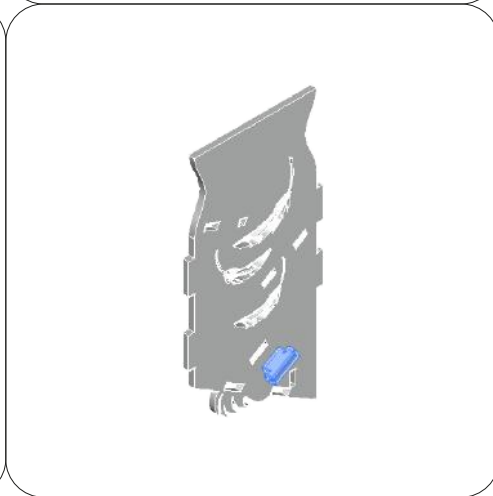
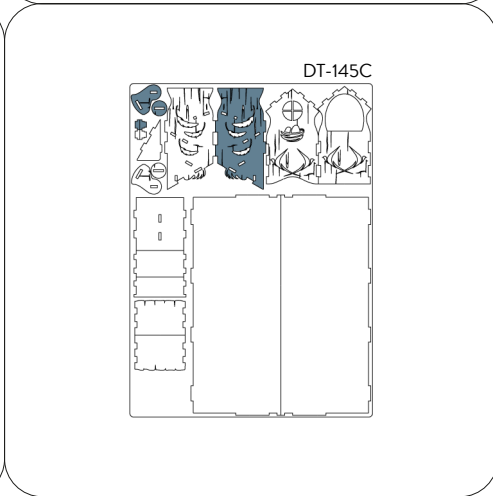

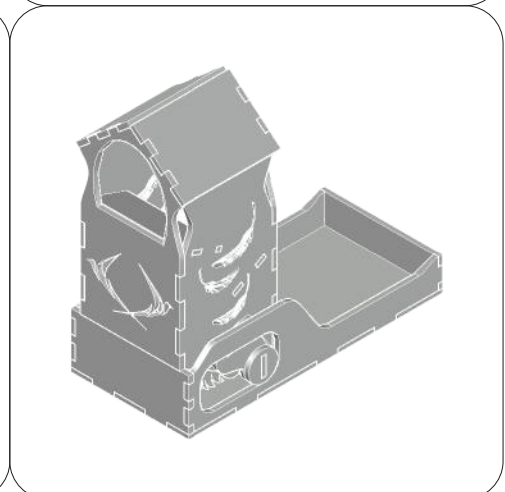
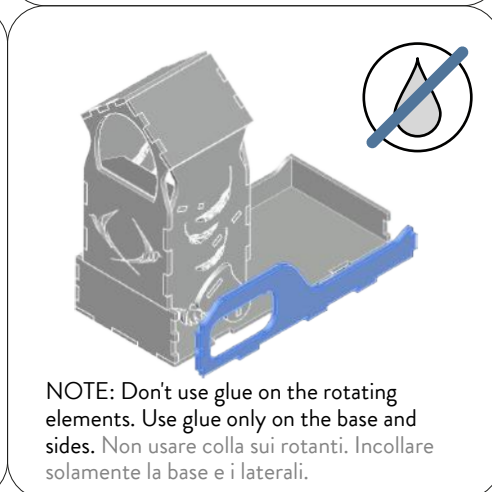
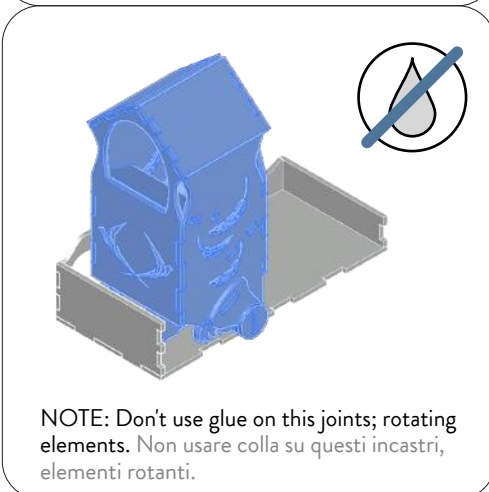
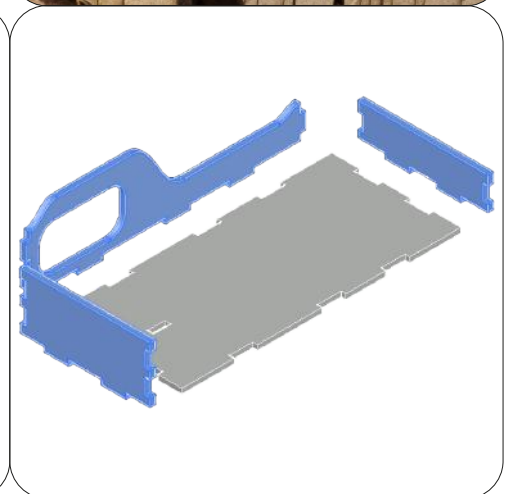
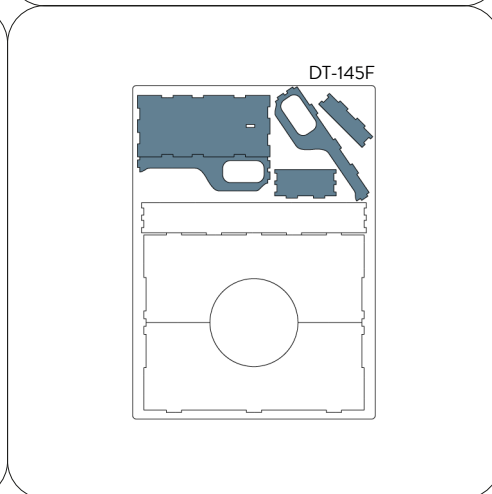
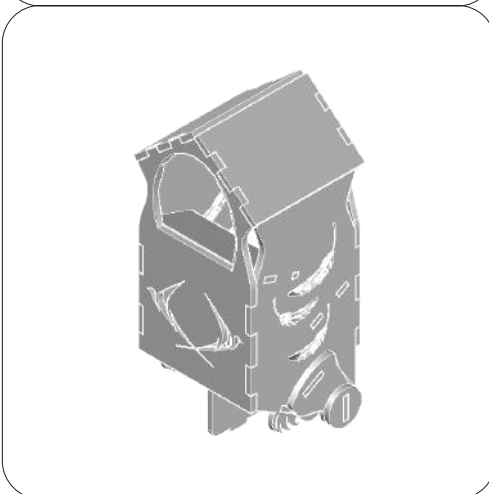
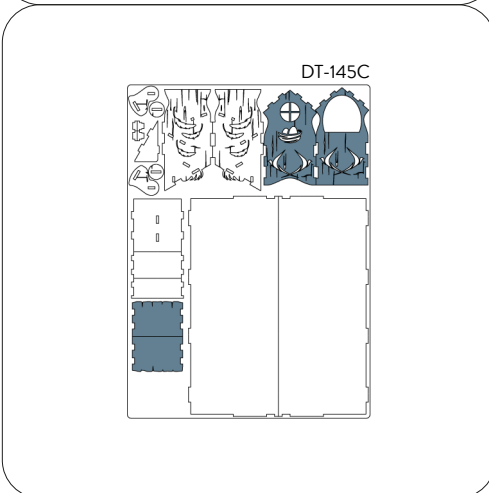
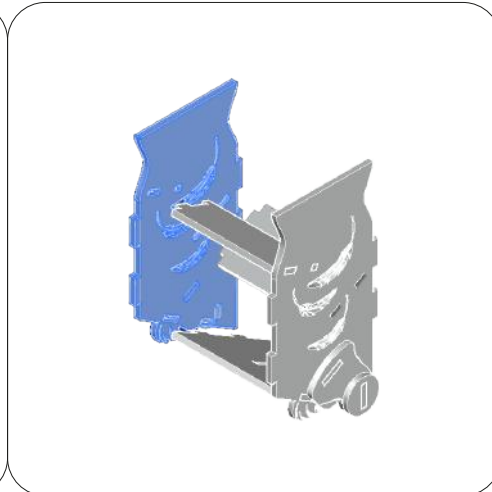
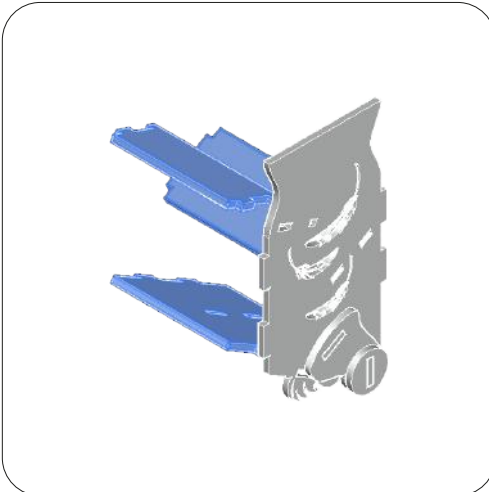

REBOXING SEQUENCE!



**VERTICAL
STORAGE
SAFETY**

Every piece will stay in its slot. Follow the reboxing sequence to properly store your organizer. We recommend using a h-band to avoid accidental box opening. Don't shake. Ogni componente rimarrà al suo posto. Segui la sequenza di reinserimento per riporre nella maniera corretta il tuo organizer. Consigliamo l'utilizzo di una h-band per evitare aperture accidentali. Non scuotere.



Non-recyclable waste.
Smaltire i materiali di scarto nell'indifferenziata.

All trademarks and copyrights are the property of their respective owners.
This product is not a toy. Contains small parts that can be swallowed or inhaled. 14+