

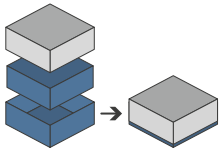

## ORGANIZER - COMPATIBLE WITH WINGSPAN ALL IN - LIFTED BASE

NOTE: Accessory compatible with our organizer for Wingspan All In. Accessorio compatibile con il nostro organizer per Wingspan All In.



This accessory will replace the original box base and will allow a perfect closure using the lid from the original game. Questo accessorio sostituisce la base della scatola del gioco permettendo la chiusura a filo utilizzando il coperchio originale del gioco\*

29.6 x 29.6 x 11.8 cm



Size of assembled organiser  
Dimensioni organizer assemblato

### ORGANIZER CAPACITY

1x lifted base to house the whole organizer and game components and closing everything flush with the original game's lid; the double layered base guarantees strength, stability and a perfect closure of the box. 1x base con alzata per alloggiare l'intero organizer e chiudere con il coperchio originale del gioco chiudendo tutto a filo; il doppio strato della base garantisce robustezza, stabilità e una chiusura perfetta della scatola



\* Any doubt?  
Check out our FAQ page  
or download the digital  
version of the instructions  
on our website!

All trademarks and copyrights are the property of their respective owners.  
This product is not a toy. Contains small parts that can be swallowed or inhaled. 14+





## ORGANIZER - COMPATIBLE WITH WINGSPAN ALL IN - LIFTED BASE

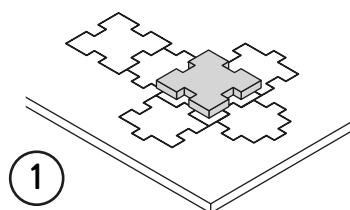

1

Gently take off  
all the pieces.  
Stacca delicatamente  
dal foglio tutti i pezzi.

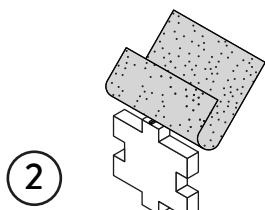

2

If necessary, use sand paper to  
smoothen the borders.  
Se necessario rifila con carta  
vetrata per legno eventuali  
imperfezioni dei pezzi.

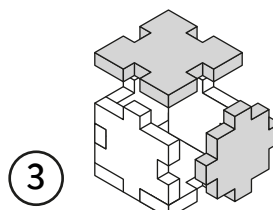

3

Get familiar with  
all the pieces  
and check the correct assembly  
sequence.  
Prendi familiarità con tutti  
i pezzi, per assicurarti  
che la sequenza di assemblaggio sia  
corretta.

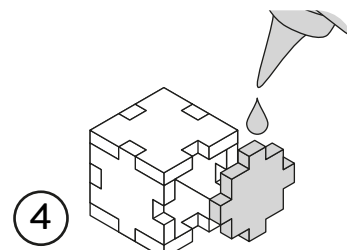

4

Once verified the correct assembly  
sequence, just add a small quantity  
of PVA glue on every joint.  
Dopo aver verificato  
la sequenza di assemblaggio  
aggiungi una piccola quantità di  
colla vinilica su tutti  
gli incastri per garantirne  
la durata nel tempo.

## INSTRUCTIONS

A



DT-144 A

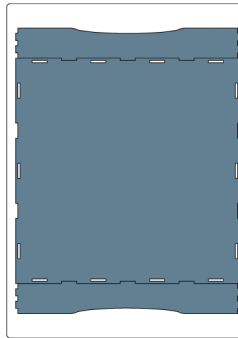

DT-144 B

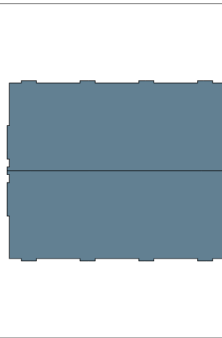

DT-144 C

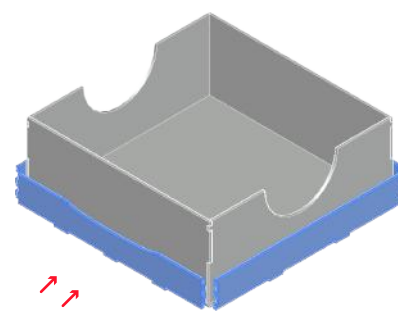
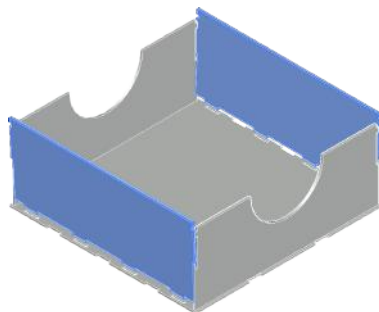
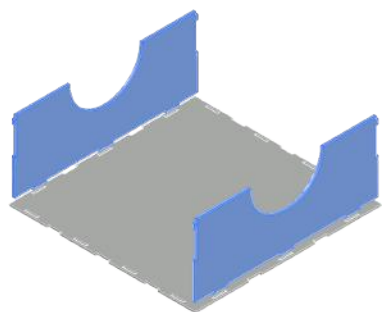
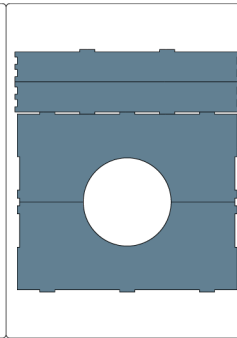

**NOTE:** Place the engravings outwards.  
Posiziona le incisioni verso l'esterno

## REBOXING SEQUENCE!



Every piece will stay in its slot. Follow the reboxing sequence to properly store your organizer. We recommend using a h-band to avoid accidental box opening. Don't shake. Ogni componente rimarrà al suo posto. Segui la sequenza di reinserimento per riporre nella maniera corretta il tuo organizer. Consigliamo l'utilizzo di una h-band per evitare aperture accidentali. Non scuotere.

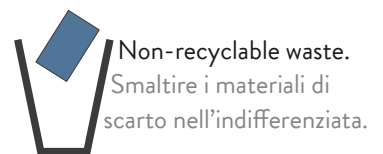

All trademarks and copyrights are the property of their respective owners.  
This product is not a toy. Contains small parts that can be swallowed or inhaled. 14+