

ORGANIZER - COMPATIBLE WITH FROSTPUNK (BASE GAME OR WITH FROSTLANDER EXP)

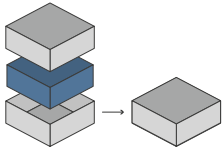

Designed to fit into the game box; flush closure is guaranteed. Progettato per inserirsi all'interno della scatola del gioco; garantisce chiusura a filo*

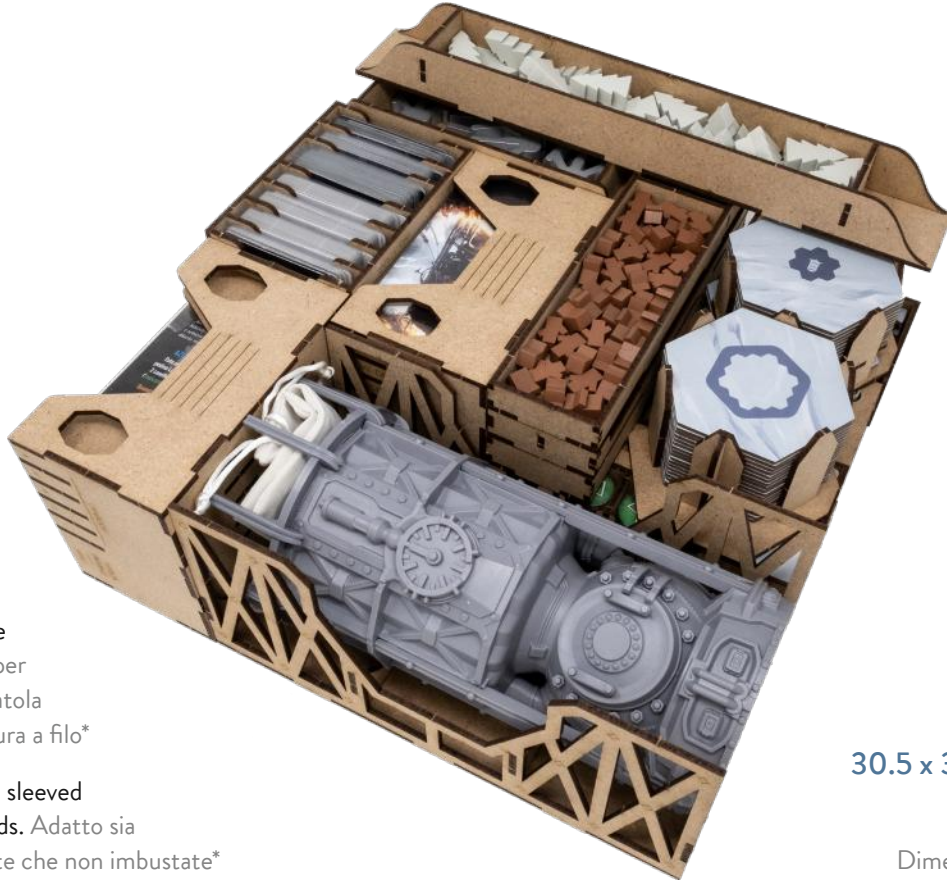

Designed for both sleeved and unsleeved cards. Adatto sia per carte imbustate che non imbustate*

30.5 x 30.5 x 10.5 cm



Size of assembled organiser
Dimensioni organizer assemblato

ORGANIZER CAPACITY

4x base building trays which can be placed directly on the game board; 2x special building trays; 3x card holders, with dedicated slots; 1x generator box; 2x map tile trays; 4x resource holders, with dedicated slots; 1x citizen and children meeple trays; 3x trays for generator, citizen, hope/discontent boards with single slots for wooden components; 1x tray for generator, citizen, hope/discontent cardboard tokens; 1x setup token tray; 1x unused citizen tray, with dedicated slots. 4x tray edifici base, da posizionare direttamente sulla plancia di gioco; 2x tray edifici speciali; 3x portacarte, con slot dedicati; 1x contenitore per il Generatore; 2x contenitori per tile mappa, con slot dedicati; 4x portarisorse, con slot dedicati; 1x tray per meeple cittadino e bambini; 3x vassoi per plancia generatore, cittadini, speranza/malcontento con slot singoli per componenti in legno; 1x vassoio per token plancia generatore, cittadini, speranza/malcontento in cartone; 1x contenitore token setup; 1x contenitore token cittadino, con slot dedicati.

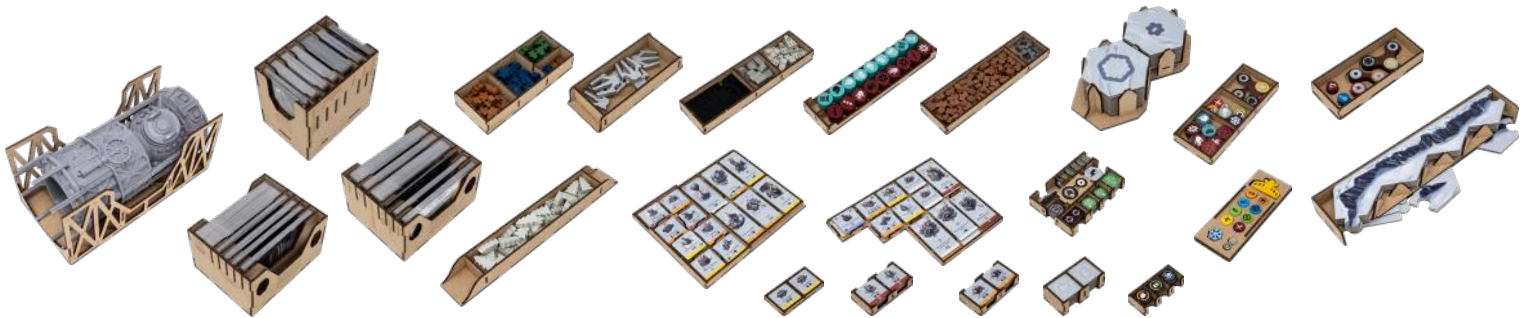

* Any doubt?
Check out our FAQ page
or download the digital
version of the instructions
on our website!

All trademarks and copyrights are the property of their respective owners.
This product is not a toy. Contains small parts that can be swallowed or inhaled. 14+



ORGANIZER - COMPATIBLE WITH FROSTPUNK (BASE GAME OR WITH FROSTLANDER EXP)



TUTORIAL - THE DICETROYERS DICE!

Among the pieces to assemble, you'll find a dice. This is not part of the organizer, but it can be a good starting point to practice!

Tra i materiali da assemblare troverai un dado. Questo componente non fa parte dell'organizer, né del gioco, ma è un ottimo punto di partenza per fare un po' di pratica.

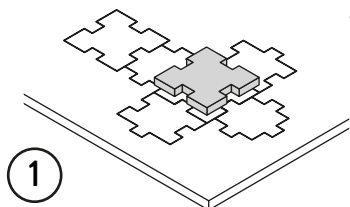

1

Gently take off
all the pieces.
Stacca delicatamente
dal foglio tutti i pezzi.

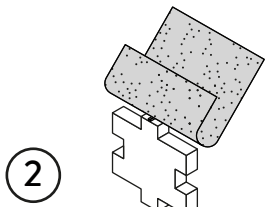

2

If necessary, use sand paper to
smoothen the borders.
Se necessario rifila con carta
vetrata per legno eventuali
imperfezioni dei pezzi.

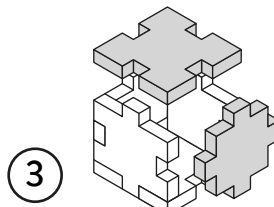

3

Get familiar with
all the pieces
and check the correct assembly
sequence.
Prendi familiarità con tutti
i pezzi, per assicurarti
che la sequenza di assemblaggio sia
corretta.

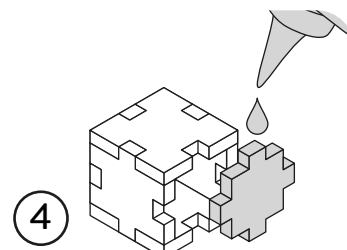

4

Once verified the correct assembly
sequence, just add a small quantity
of PVA glue on every joint.
Dopo aver verificato
la sequenza di assemblaggio
aggiungi una piccola quantità di
colla vinilica su tutti
gli incastri per garantirne
la durata nel tempo.

INSTRUCTIONS

A



DT-134A

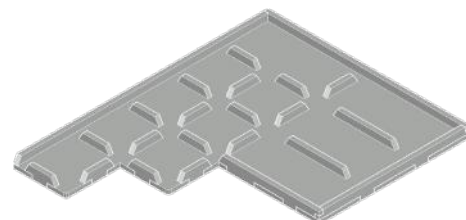
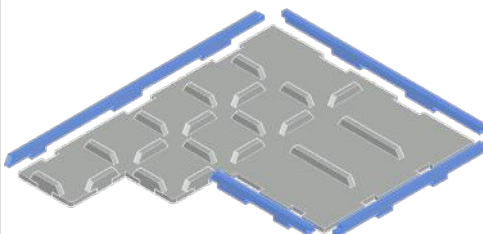
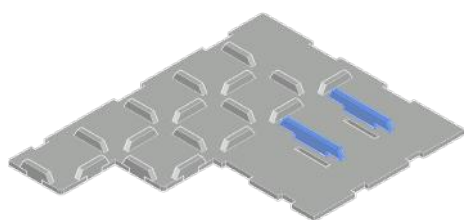
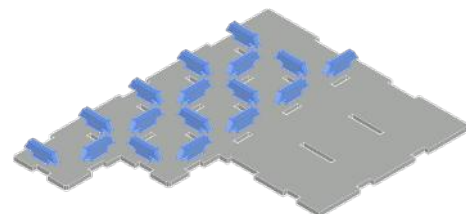
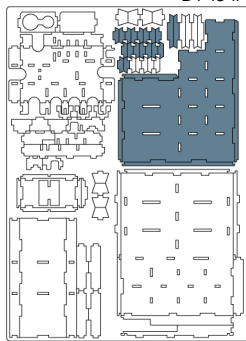

B



DT-134A

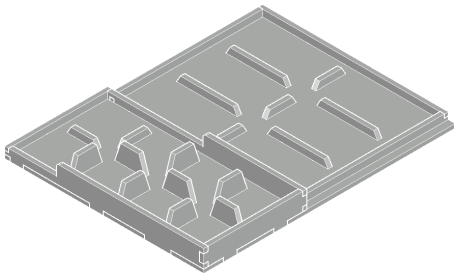
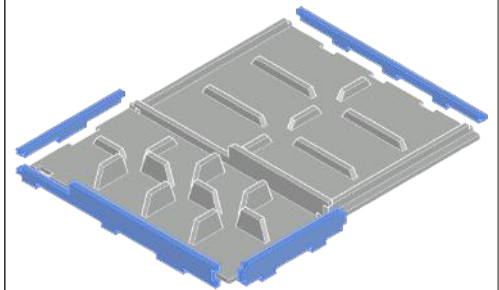
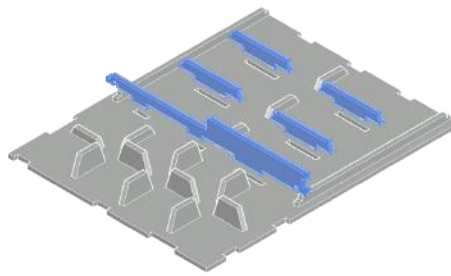
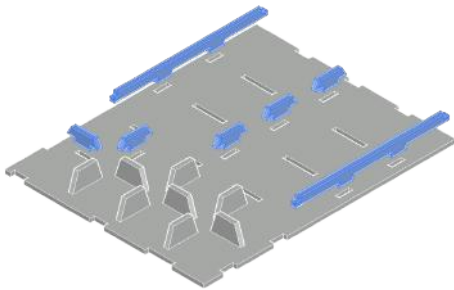
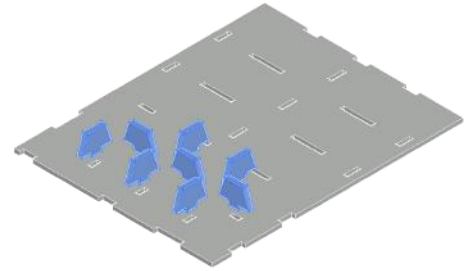
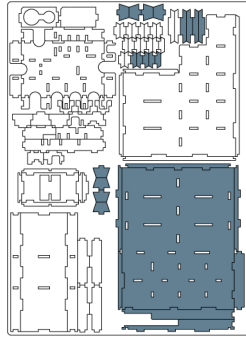

C



NOTE: This tray is for generator, citizen, hope/discontent cardboard tokens. Questo tray è per i token generatore, cittadini, speranza/malcontento in cartone.

DT-134A

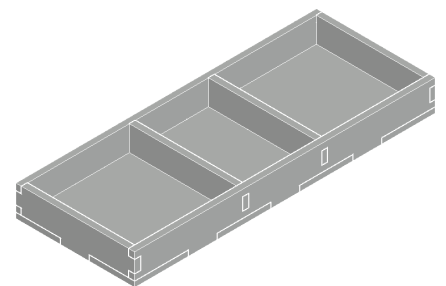
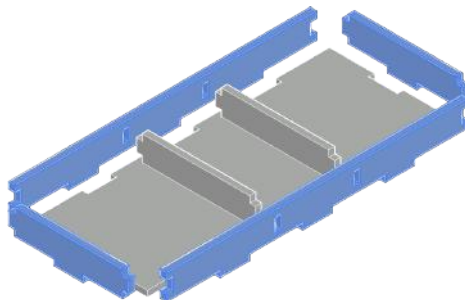
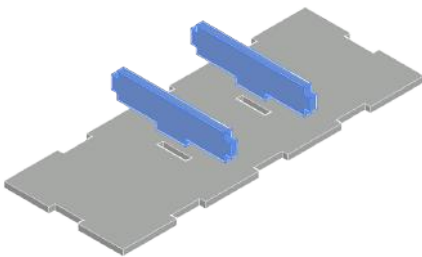
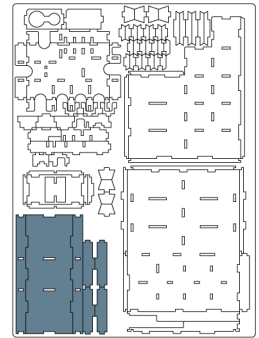

D



DT-134A

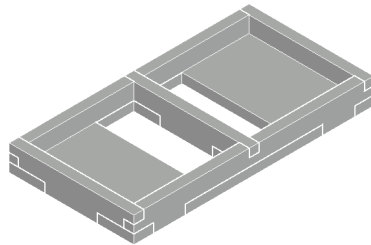
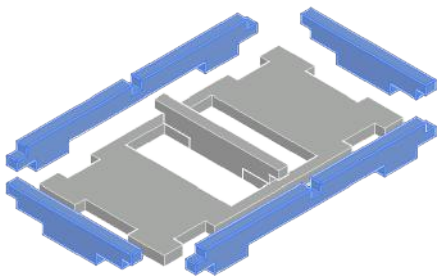
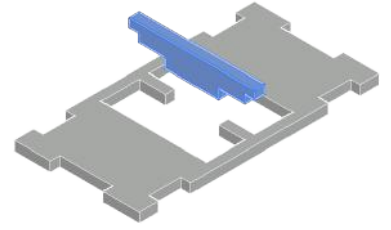
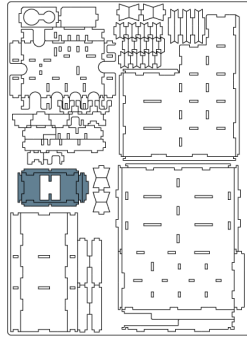

E



DT-134A

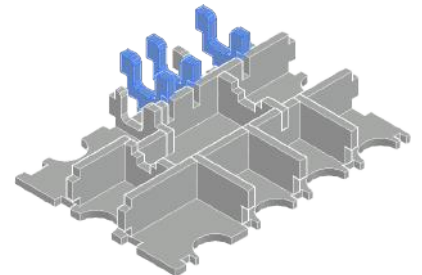
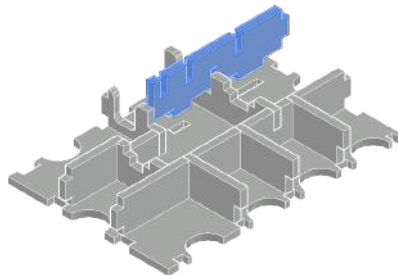
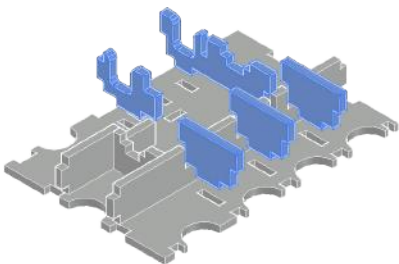
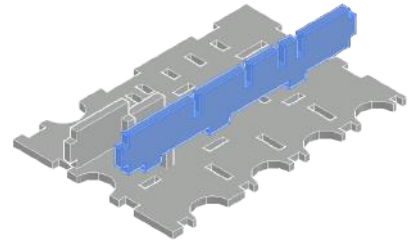
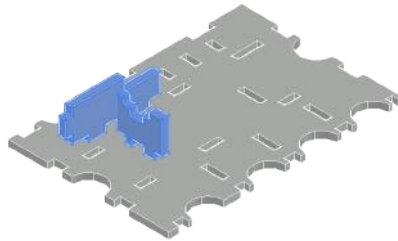
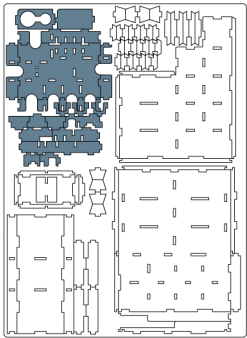

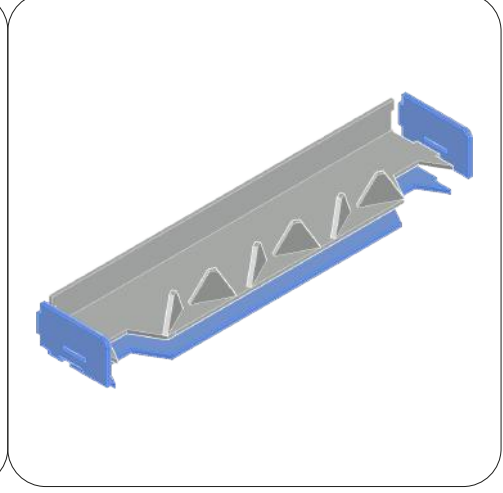
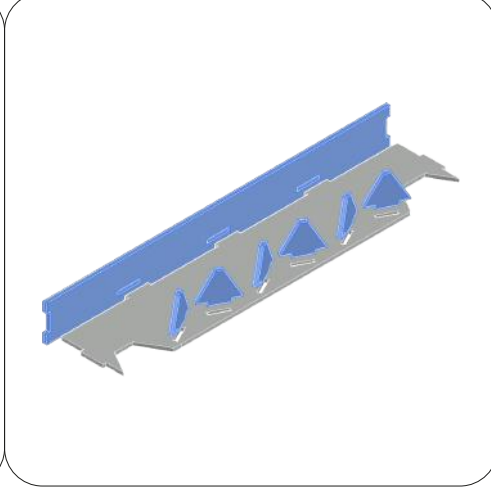
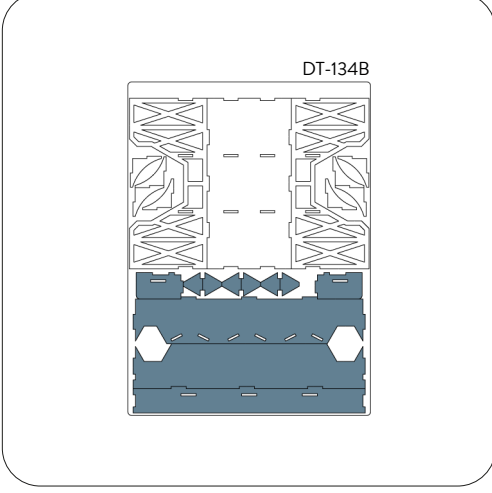
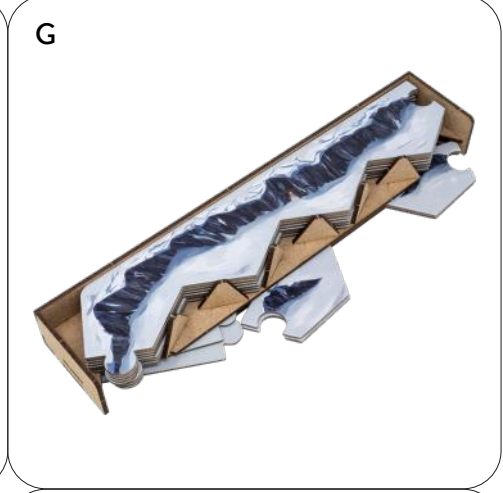
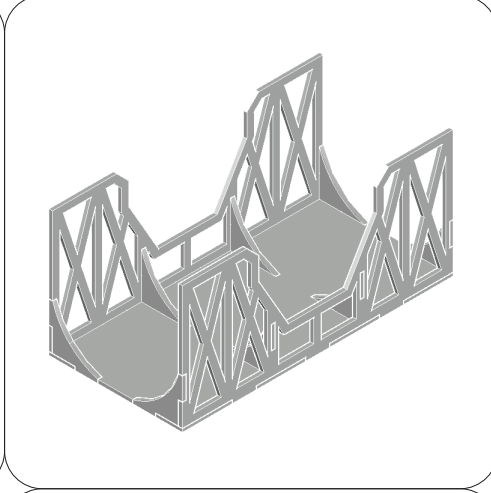
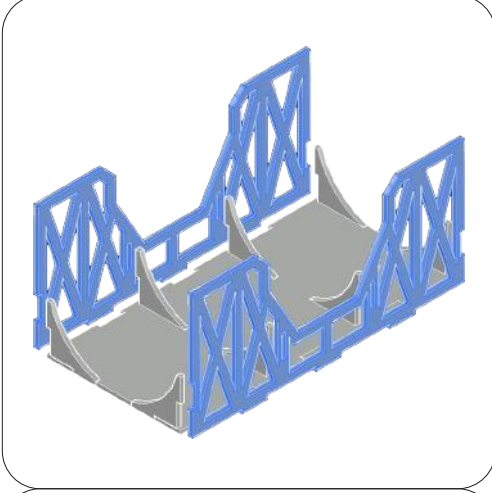
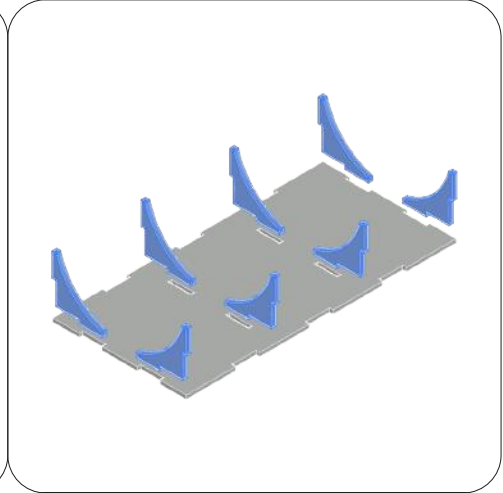
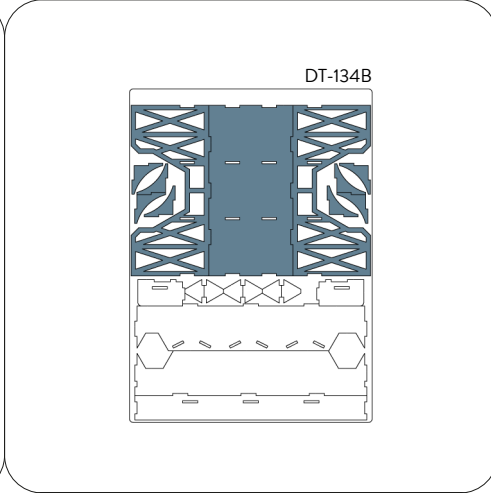
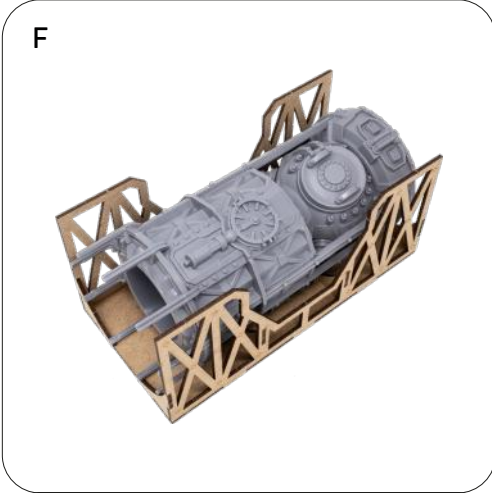
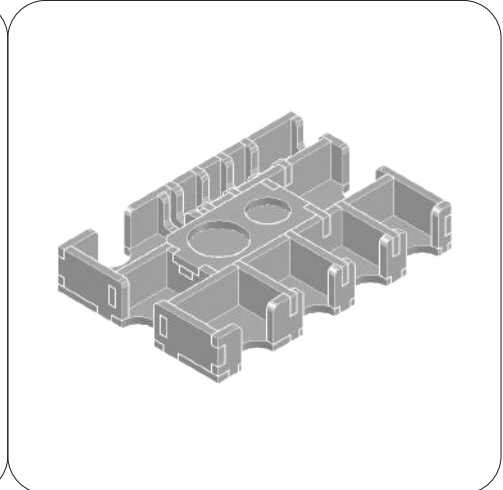
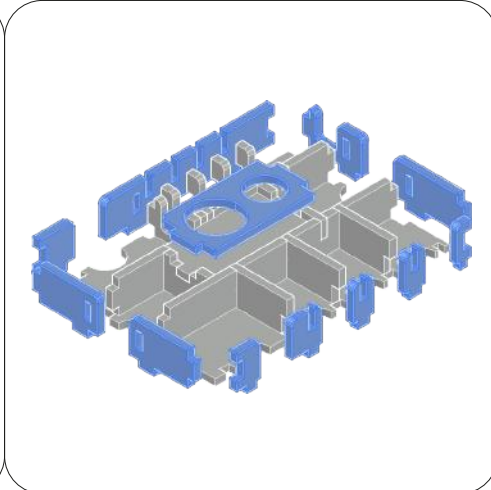
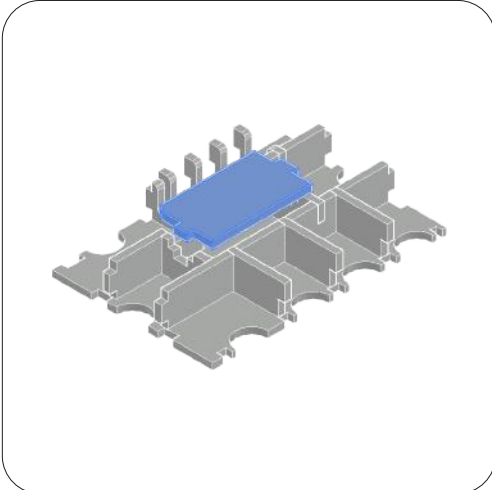

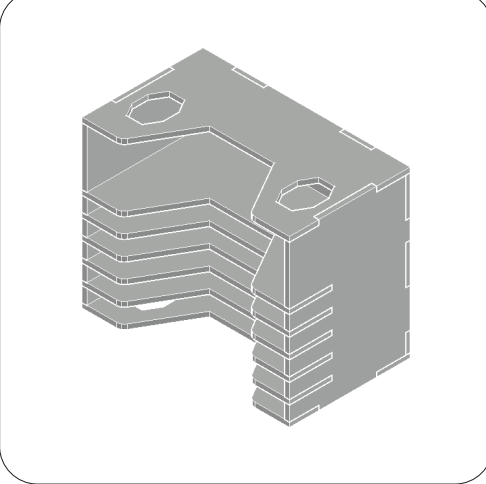
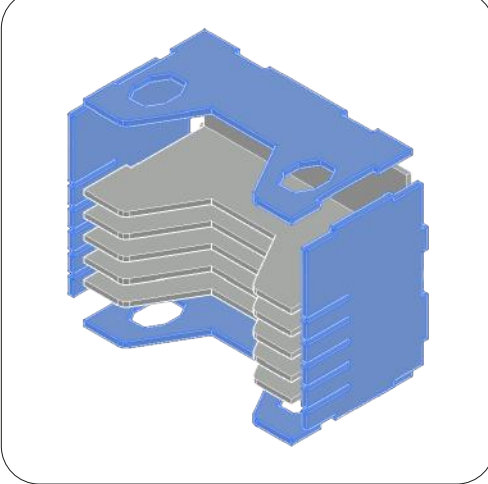
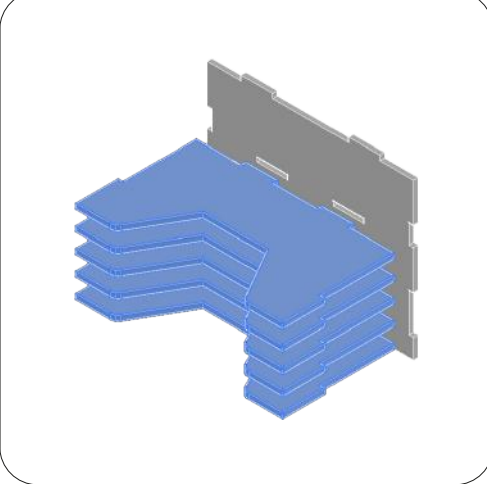
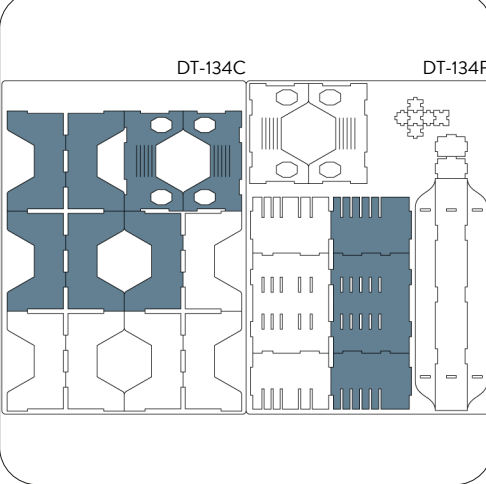
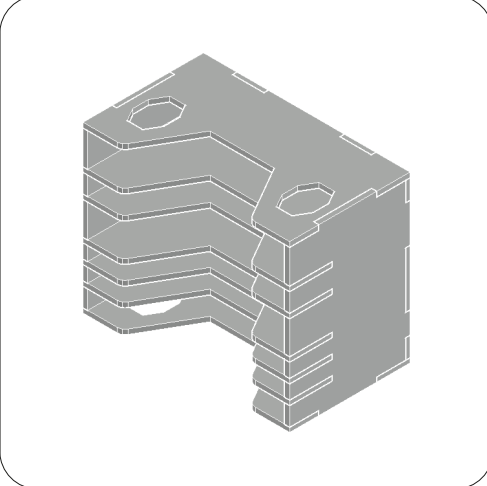
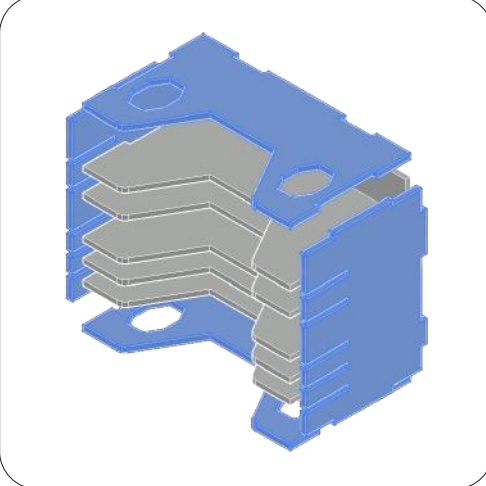
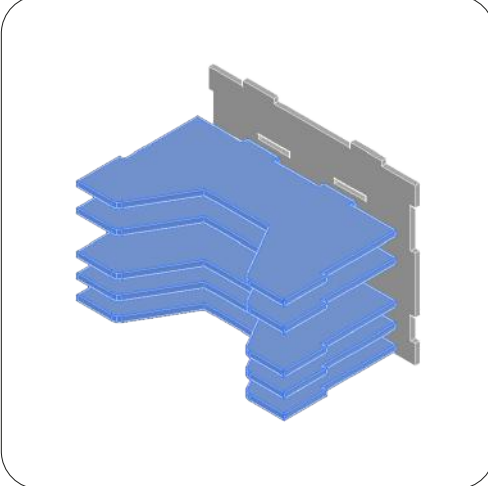
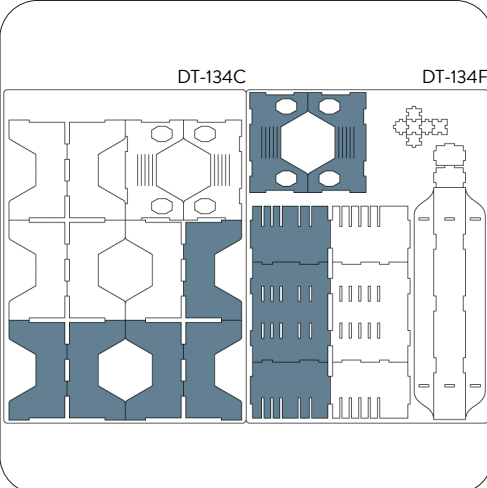
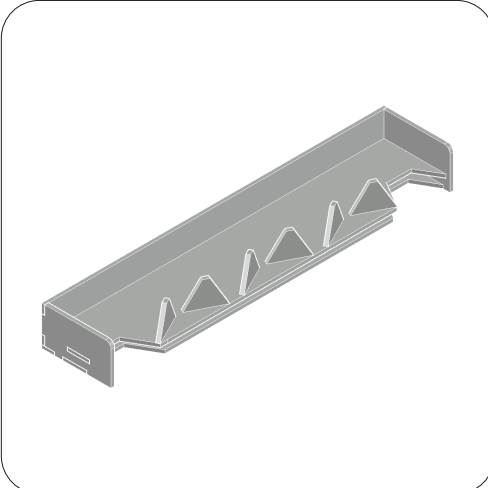

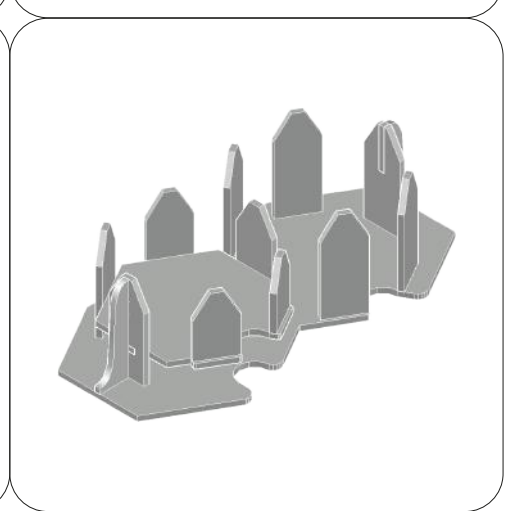
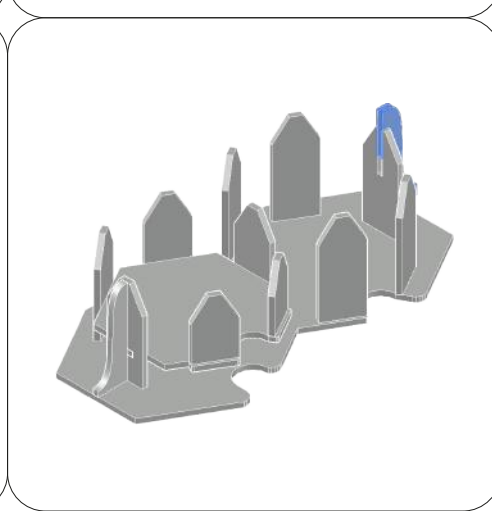
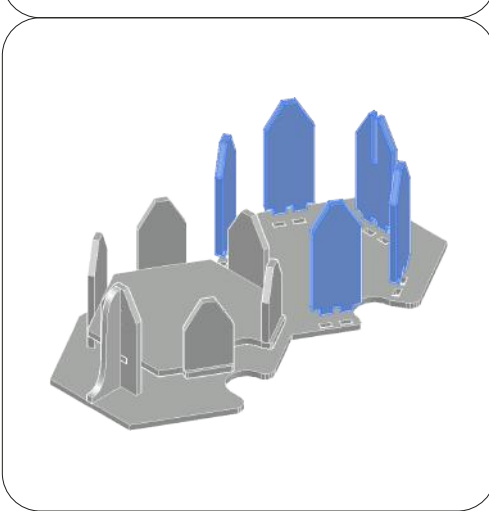
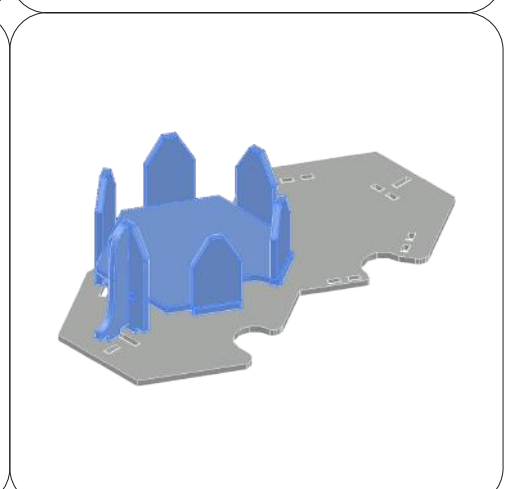
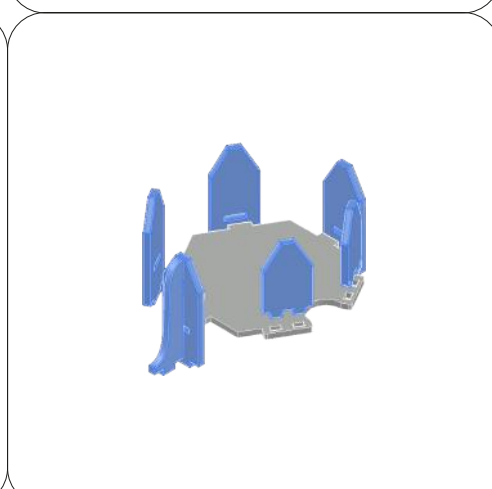
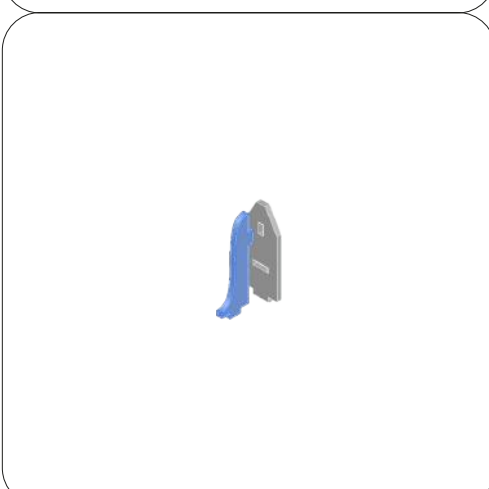
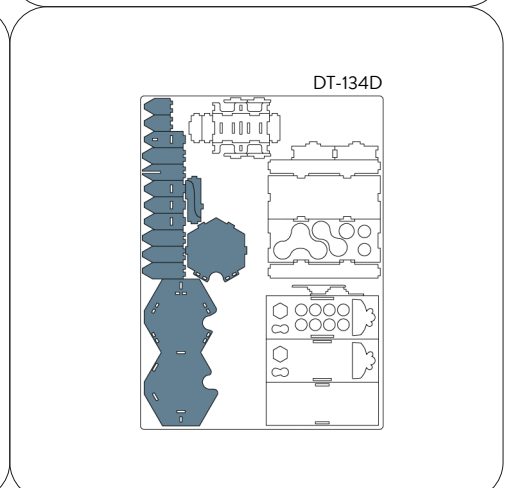
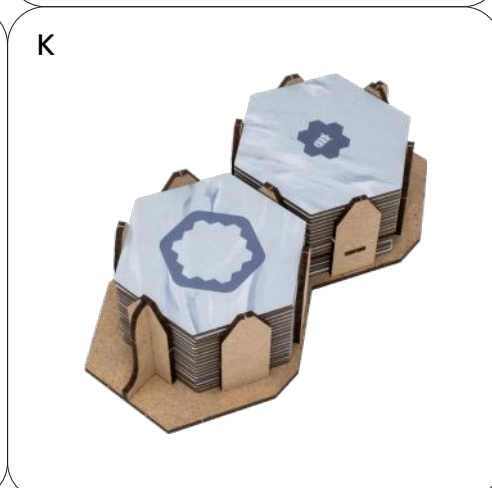
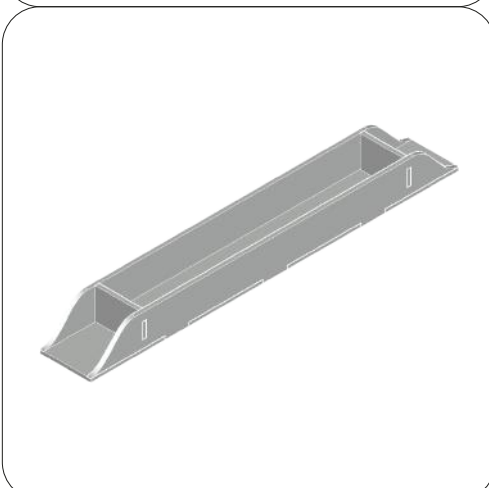
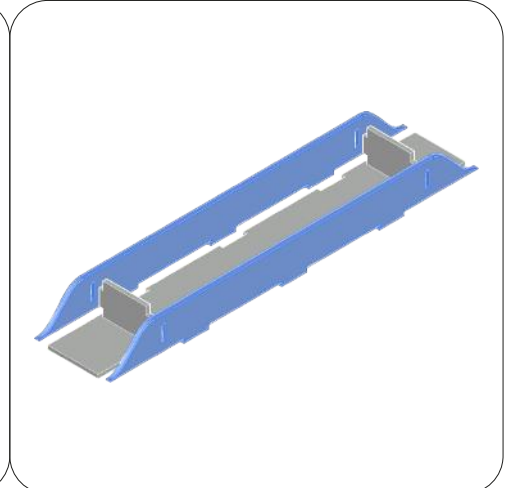
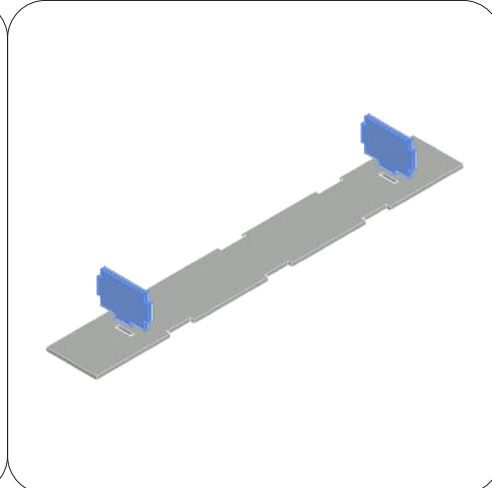
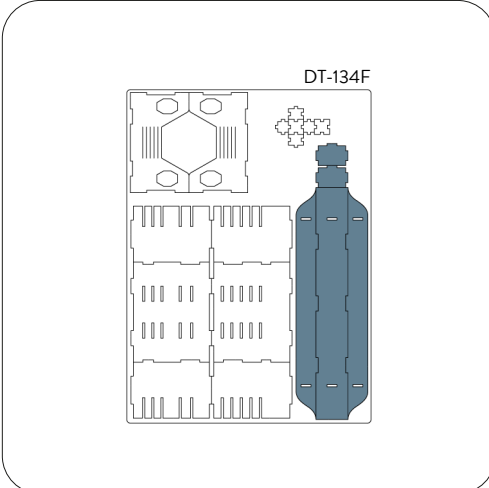

L

2x



DT-134D

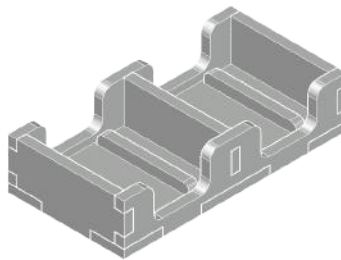
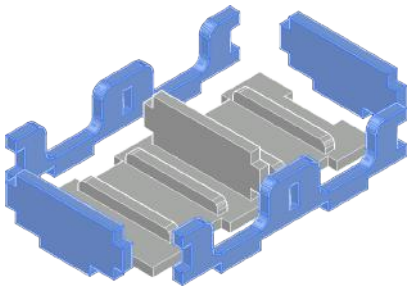
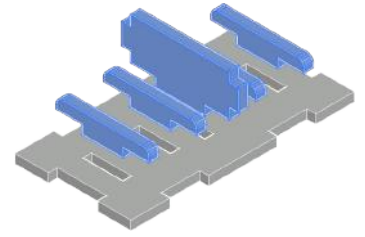
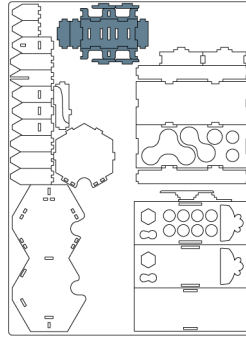

DT-134E

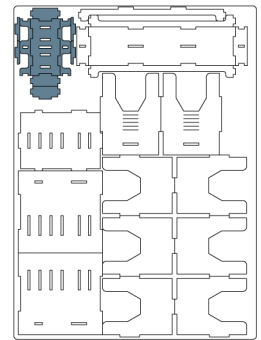

M



DT-134D

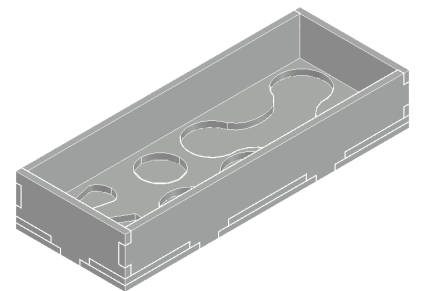
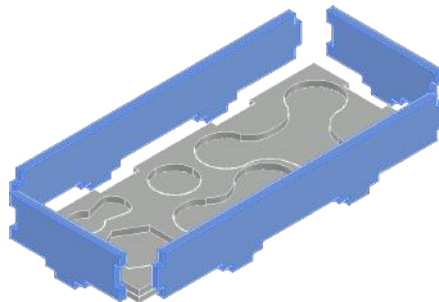
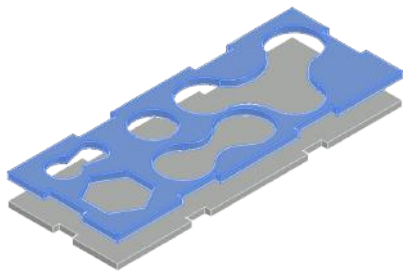
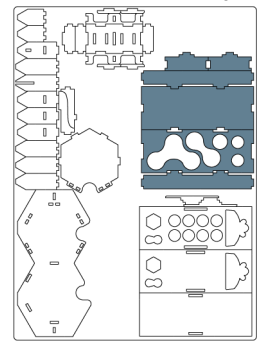

N



DT-134D

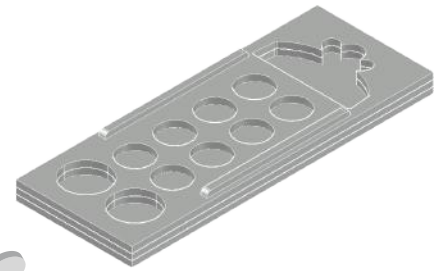
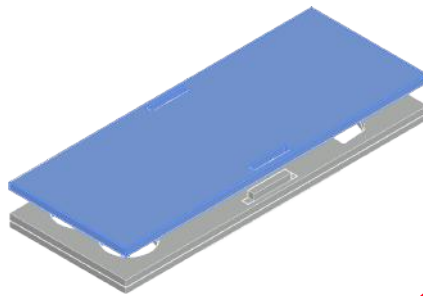
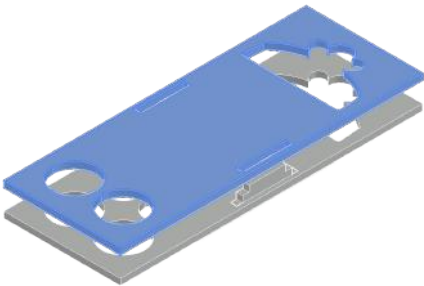
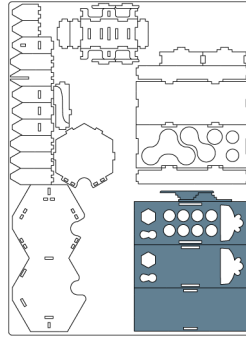

NOTE: In this step, the engravings must be facing downwards. In questo passaggio le incisioni devono essere rivolte verso il basso.

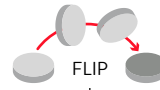

O



DT-134E

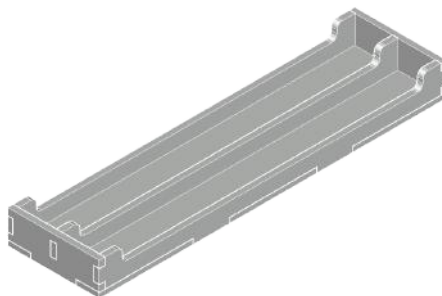
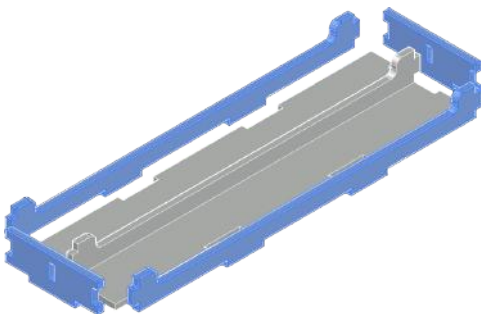
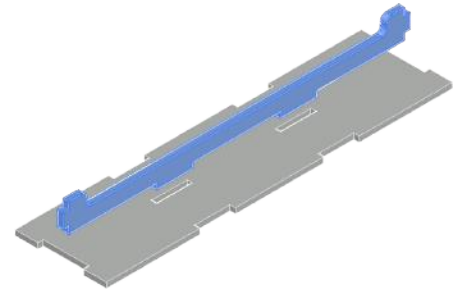
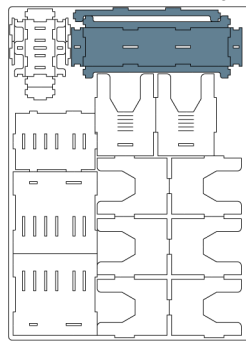

P



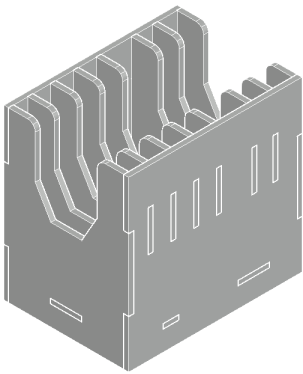
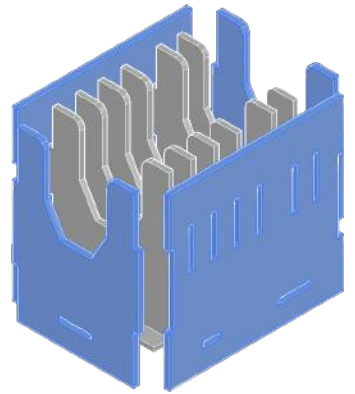
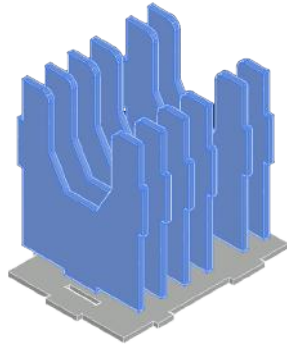
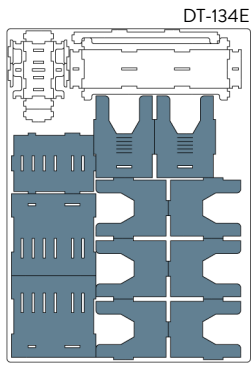

Q

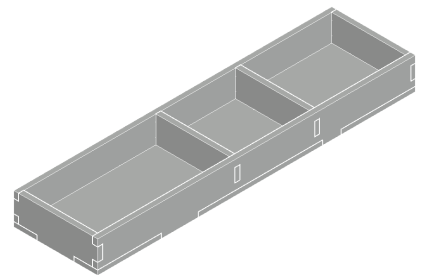
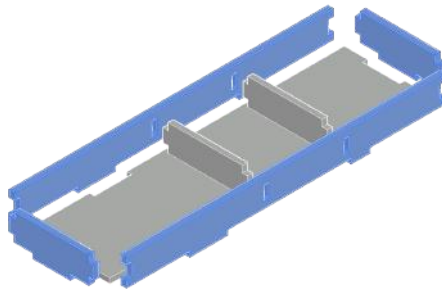
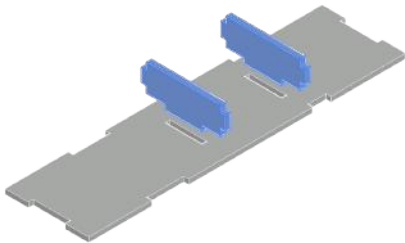
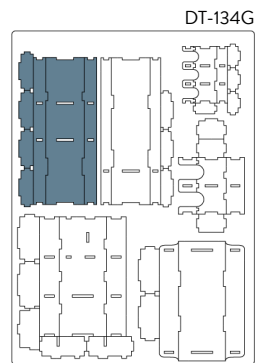

R

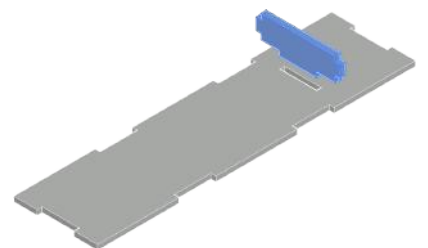
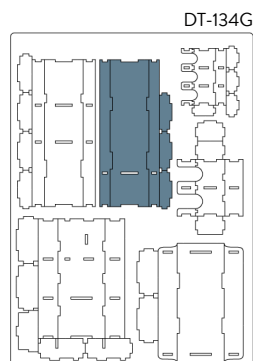

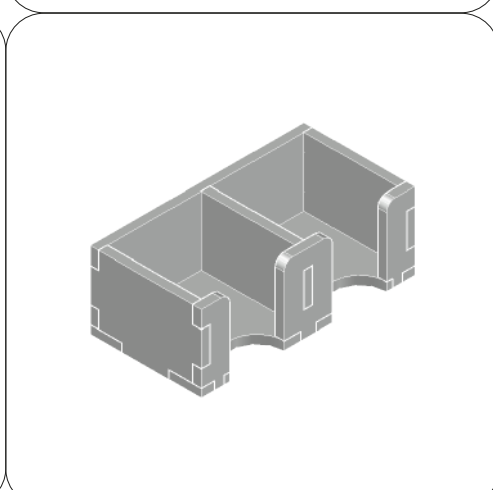
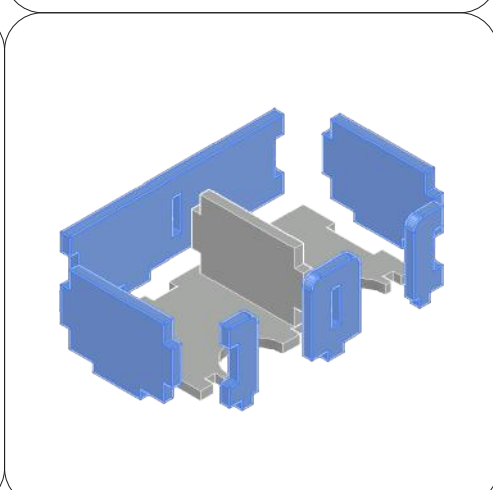
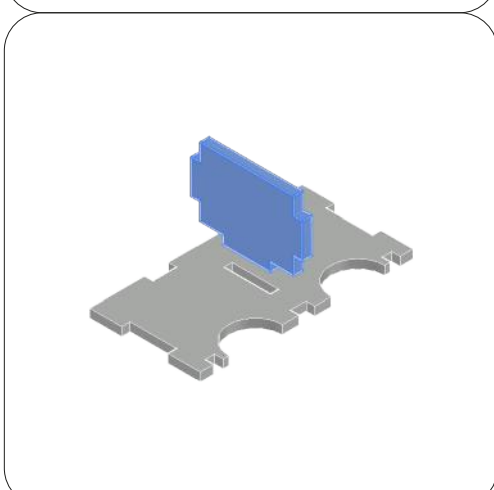
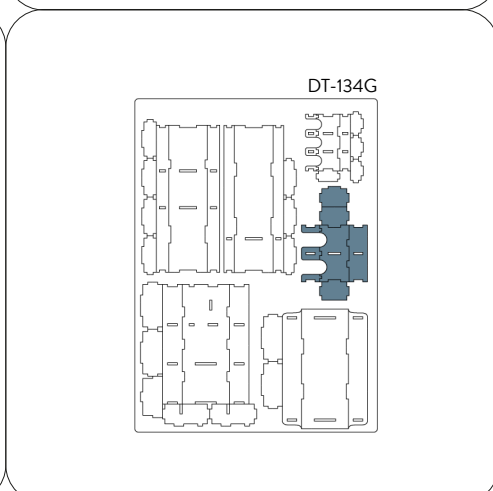
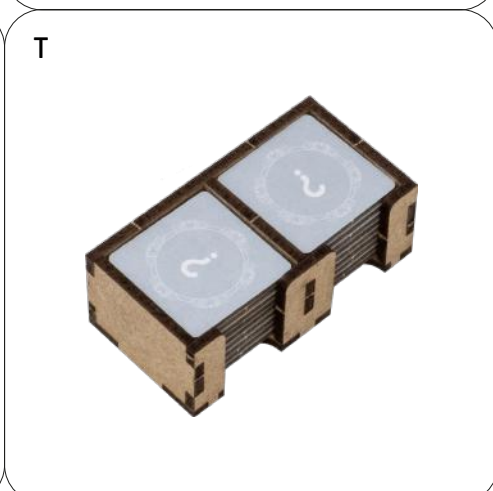
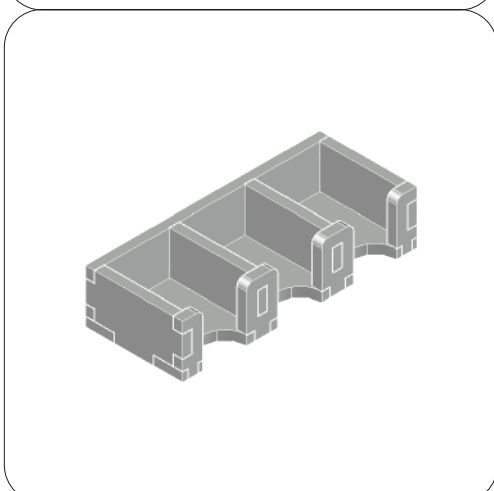
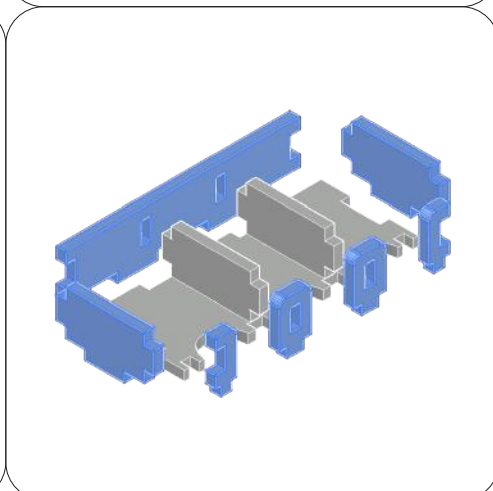
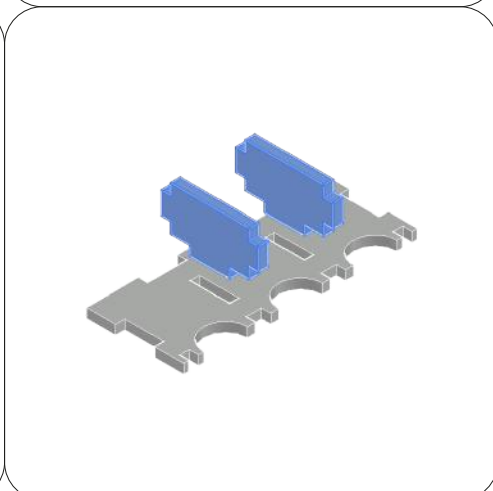
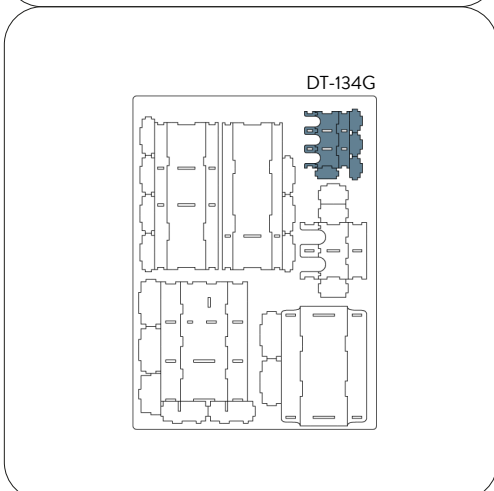
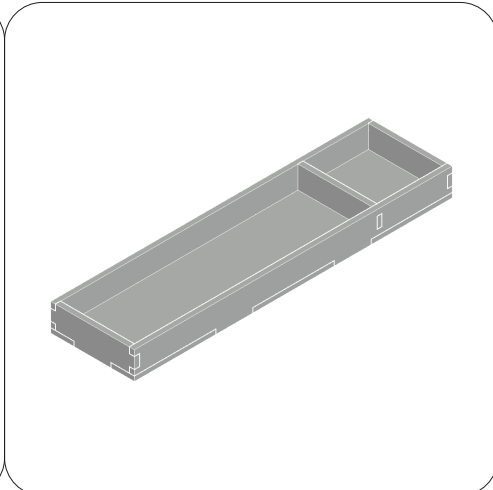
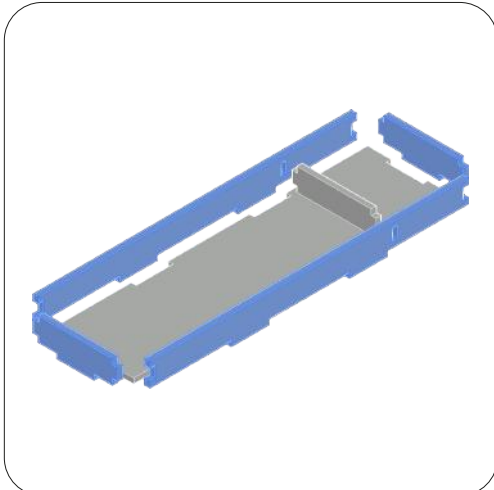

U



DT-134G

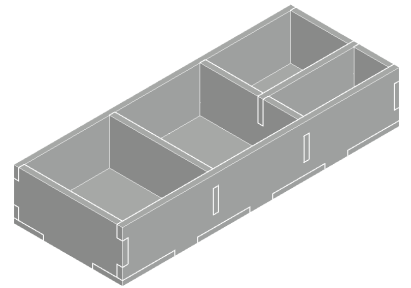
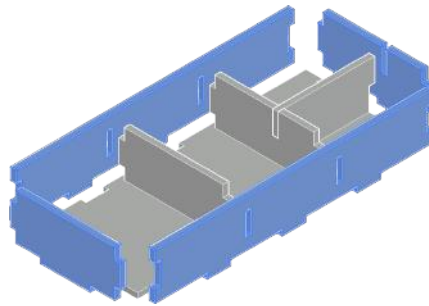
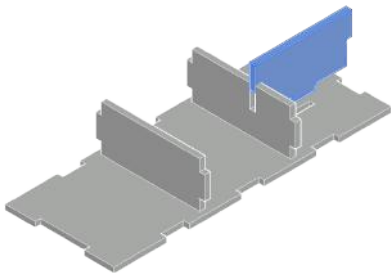
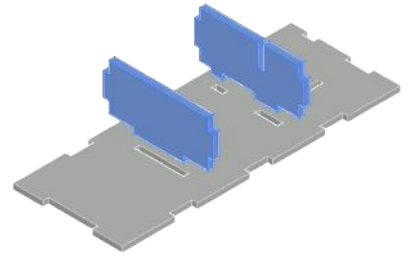
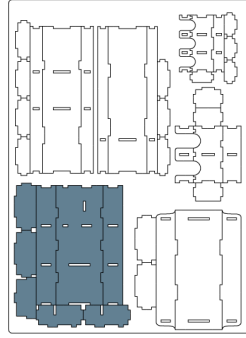

V



DT-134G

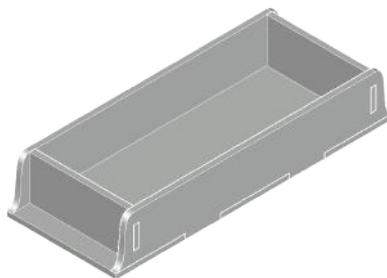
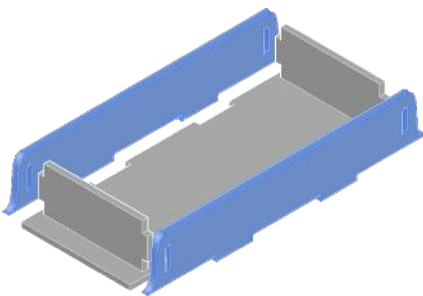
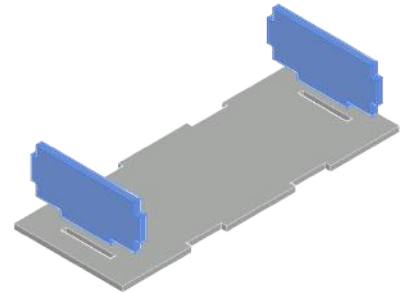
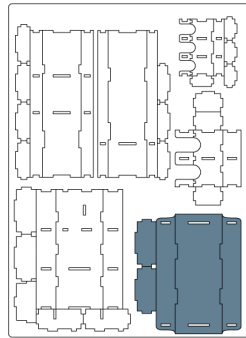

REBOXING SEQUENCE!

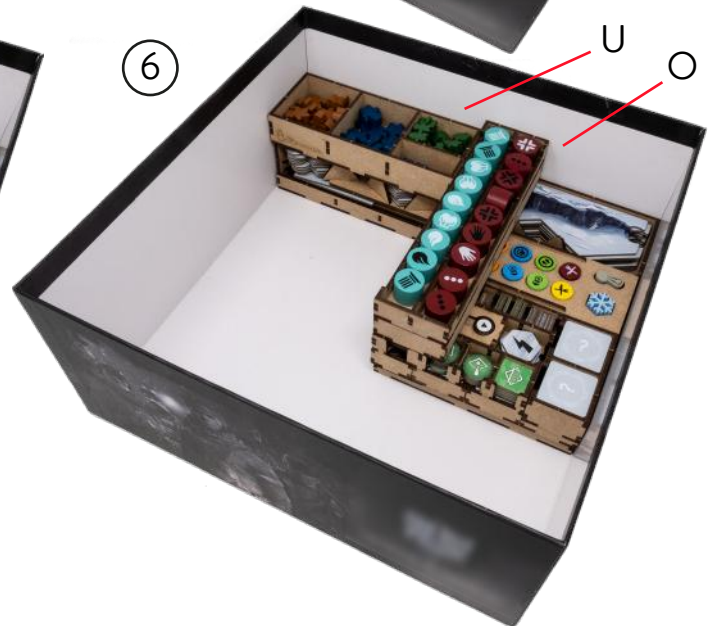
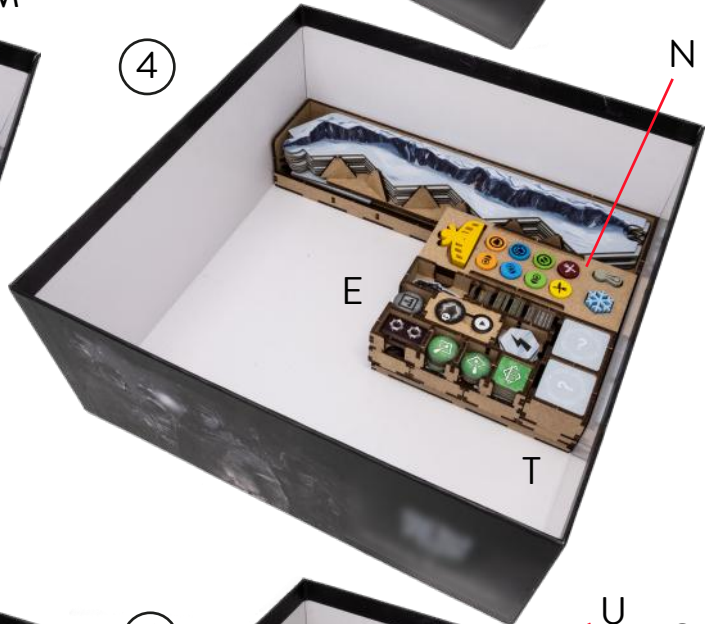
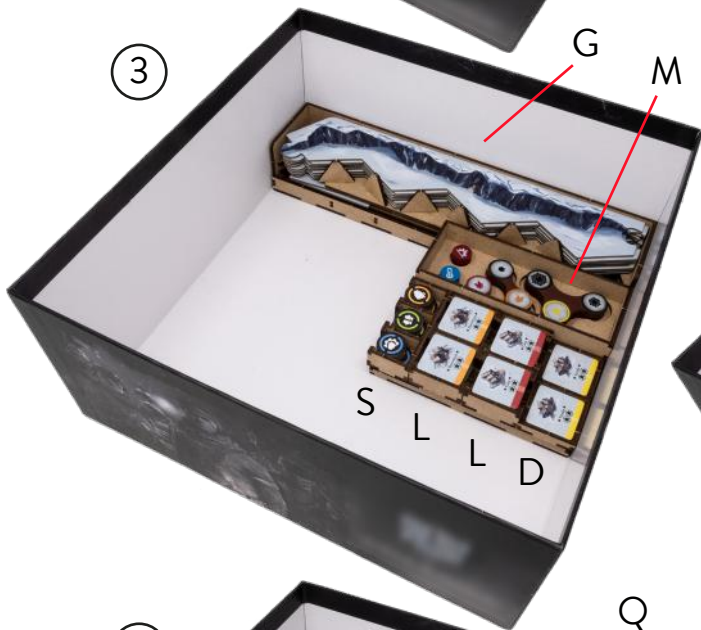
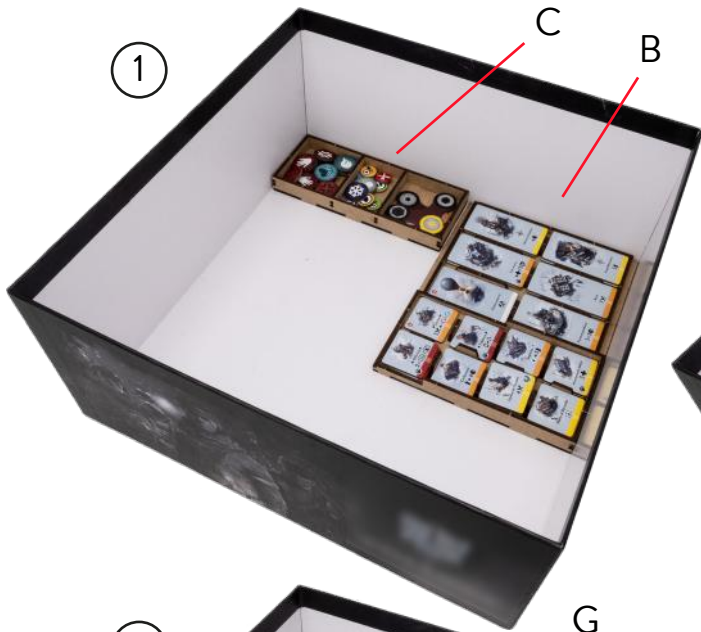

Continue on next page →

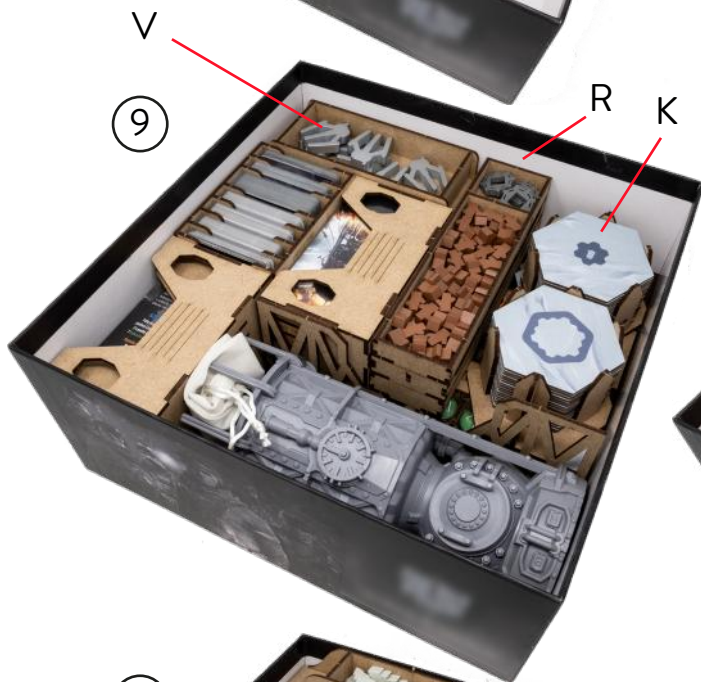
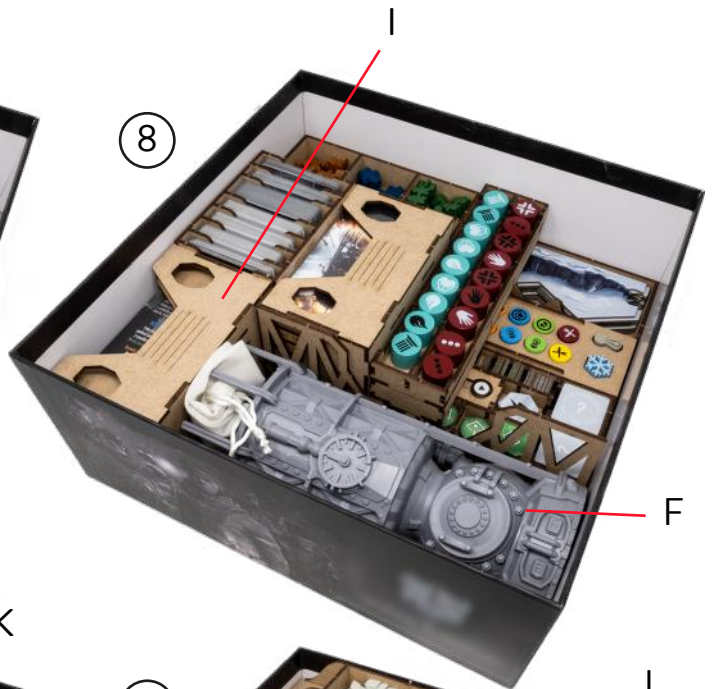
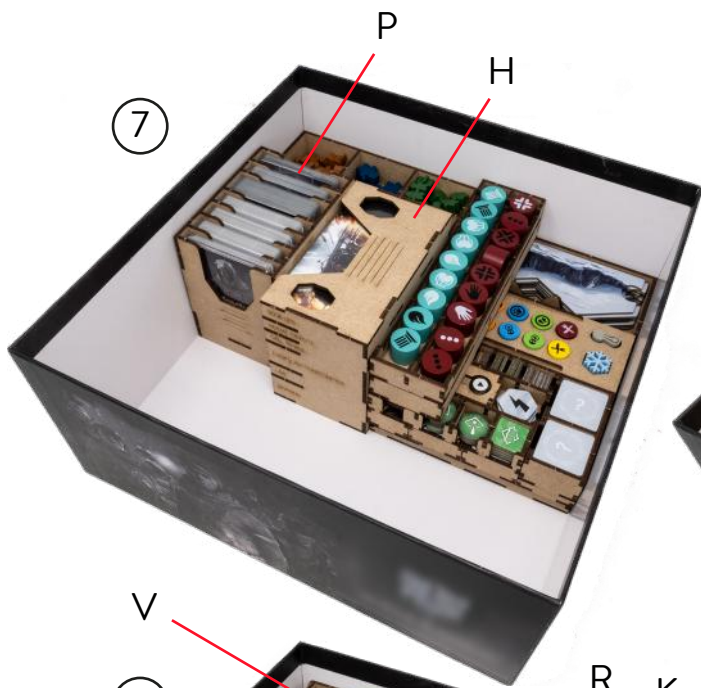

Continue on next page →

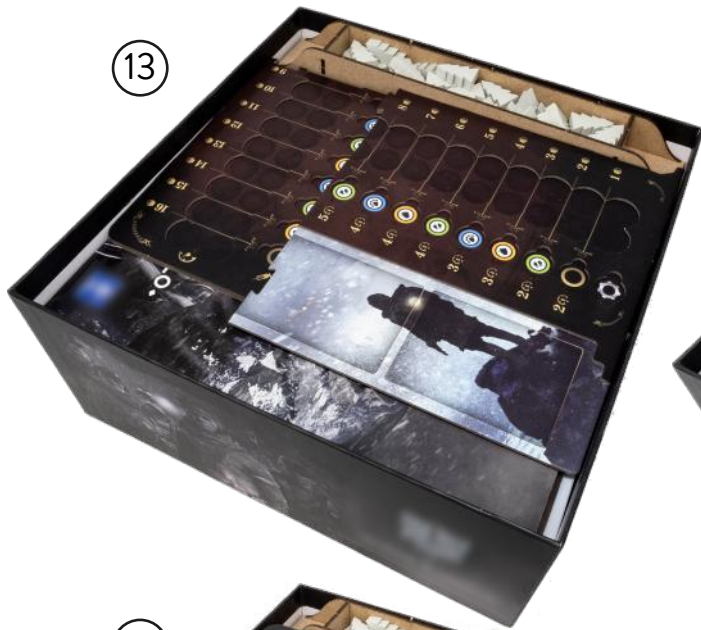

13



14



15



16



**VERTICAL
STORAGE
SAFETY**



Every piece will stay in its slot. Follow the reboxing sequence to properly store your organizer. We recommend using a h-band to avoid accidental box opening. Don't shake. Ogni componente rimarrà al suo posto. Segui la sequenza di reinserimento per riporre nella maniera corretta il tuo organizer. Consigliamo l'utilizzo di una h-band per evitare aperture accidentali. Non scuotere.



Non-recyclable waste.
Smaltire i materiali di scarto nell'indifferenziata.

All trademarks and copyrights are the property of their respective owners.
This product is not a toy. Contains small parts that can be swallowed or inhaled. 14+