

# FLAMECRAFT - PLAYER BOARD -



22.5 x 20.8 x 0.6 cm



Size once assembled  
Dimensioni da assemblata

Designed for both sleeved  
and unsleeved cards. Adatto sia  
per carte imbustate che non imbustate\*

## COMPONENTS

1x player board, with dedicated slots for resource tokens, coins, cards and end turn discards.  
1x plancetta giocatore, con slot dedicati per token merce, monete, carte e scarti di fine turno.

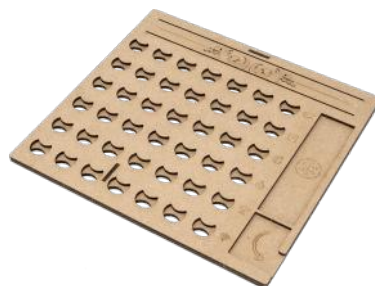

\* Any doubt?  
Check out our FAQ page  
or download the digital  
version of the instructions  
on our website!

All trademarks and copyrights are the property of their respective owners.  
This product is not a toy. Contains small parts that can be swallowed or inhaled. 14+

# FLAMECRAFT PLAYER BOARD

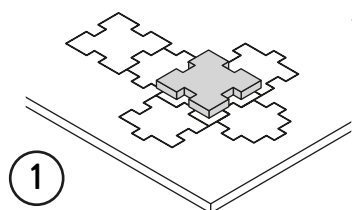

1

Gently take off  
all the pieces.  
Stacca delicatamente  
dal foglio tutti i pezzi.

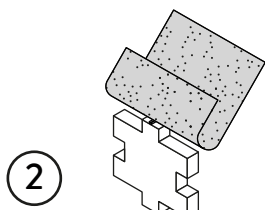

2

If necessary, use sand paper to  
smoothen the borders.  
Se necessario rifila con carta  
vetrata per legno eventuali  
imperfezioni dei pezzi.

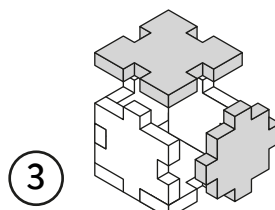

3

Get familiar with  
all the pieces  
and check the correct assembly  
sequence.  
Prendi familiarità con tutti  
i pezzi, per assicurarti  
che la sequenza di assemblaggio sia  
corretta.

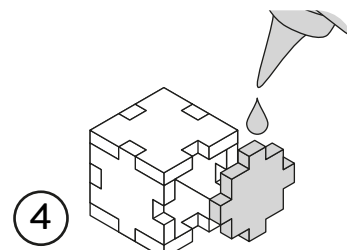

4

Once verified the correct assembly  
sequence, just add a small quantity  
of PVA glue on every joint.  
Dopo aver verificato  
la sequenza di assemblaggio  
aggiungi una piccola quantità di  
colla vinilica su tutti  
gli incastri per garantirne  
la durata nel tempo.

## INSTRUCTIONS

A



DT-125A

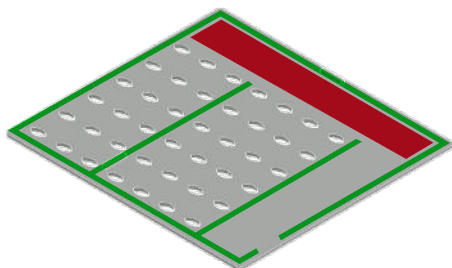
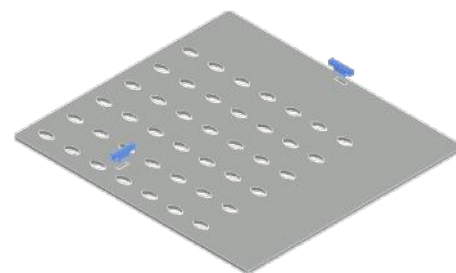
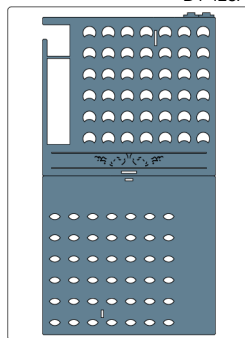

NOTE: Don't use glue on red areas. Stick the  
area marked in green. Non usare colla sulle  
aree rosse. Incollare l'area segnalata in verde.

