

THE CLOCK FLIP AND PICK STORAGE SYSTEM

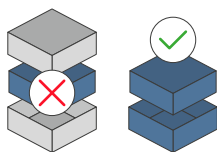

Designed to be an independent card holder Progettato per essere un box portacarte indipendente dalla scatola di gioco



Designed for both sleeved and unsleeved cards. Adatto sia per carte imbustate che non imbustate*

73



Pieces to assemble
Pezzi da assemblare

25.1 x 32.9 x 8.6 cm



Size of assembled organiser
Dimensioni organizer assemblato

ORGANIZER CAPACITY

6 rotating card holder + 4 lateral slots. Box Capacity: unsleeved cards 1667 cards; 40 micron sleeves (eg Mayday) 1400 cards; 60 micron sleeves (eg. Sapphire) 1250 cards; 100 micron sleeves (eg. Dragon Shield) 1000 cards. (The capacity is approximated and may vary depending on the thickness tolerance of used sleeves. The actual results may be different from the above); Lid with open/close rotating seal; 6 removable dividers. 6 spazi carte rotanti + 4 laterali. Capacità totale: non imbustate 1667 carte; buste 40micron (eg. Mayday) 1400 carte; buste 60micron (eg. Sapphire) 1250 carte; buste 100micron (eg. Dragon Shield) 1000 carte. (La capacità è approssimativa e può variare in funzione della tolleranza di spessore delle bustine utilizzate. Il risultato effettivo può risultare differente rispetto a quanto sopra riportato); Coperchio con sigillo di chiusura; 6 divisori rimovibili.



* Any doubt?
Check out our FAQ page
or download the digital
version of the instructions
on our website!

All trademarks and copyrights are the property of their respective owners.
This product is not a toy. Contains small parts that can be swallowed or inhaled. 14+



THE CLOCK - FLIP AND PICK STORAGE SYSTEM

TUTORIAL - THE DICETROYERS DICE!

Among the pieces to assemble, you'll find a dice. This is not part of the organizer, but it can be a good starting point to practice!

Tra i materiali da assemblare troverai un dado. Questo componente non fa parte dell'organizer, né del gioco, ma è un ottimo punto di partenza per fare un po' di pratica.

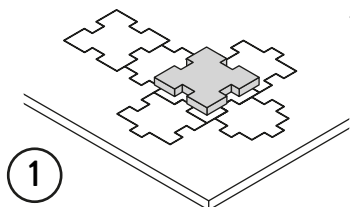

1
Gently take off all the pieces.
Stacca delicatamente dal foglio tutti i pezzi.

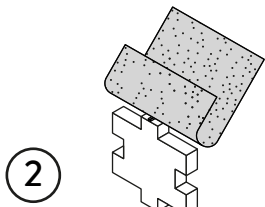

2
If necessary, use sand paper to smoothen the borders.
Se necessario rifa con carta vetrata per legno eventuali imperfezioni dei pezzi.

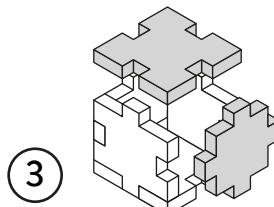

3
Get familiar with all the pieces and check the correct assembly sequence.
Prendi familiarità con tutti i pezzi, per assicurarti che la sequenza di assemblaggio sia corretta.

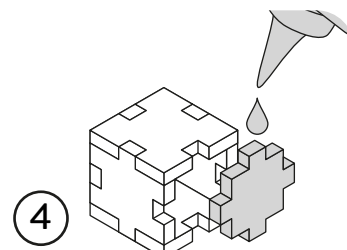

4
Once verified the correct assembly sequence, just add a small quantity of PVA glue on every joint.
Dopo aver verificato la sequenza di assemblaggio aggiungi una piccola quantità di colla vinilica su tutti gli incastri per garantirne la durata nel tempo.

INSTRUCTIONS

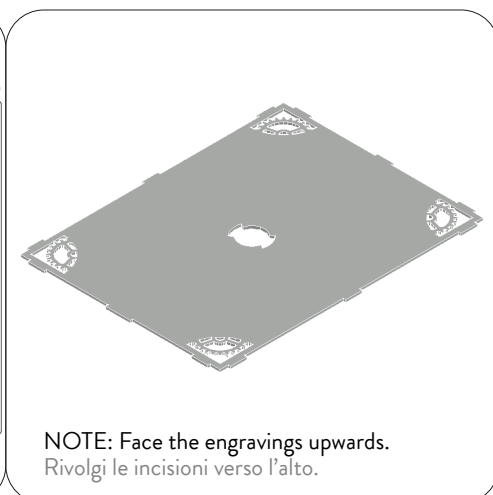
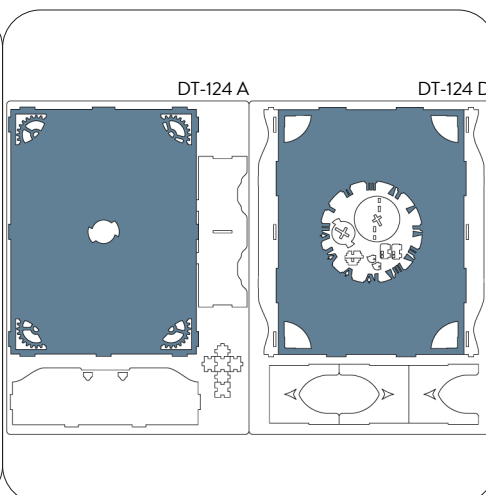

NOTE: Face the engravings upwards.
Rivolgì le incisioni verso l'alto.



NOTE: Face the engravings upwards. The number III engraving must overlap perfectly.
Rivolgì le incisioni verso l'alto. L'incisione del numero III si deve sovrapporre perfettamente.

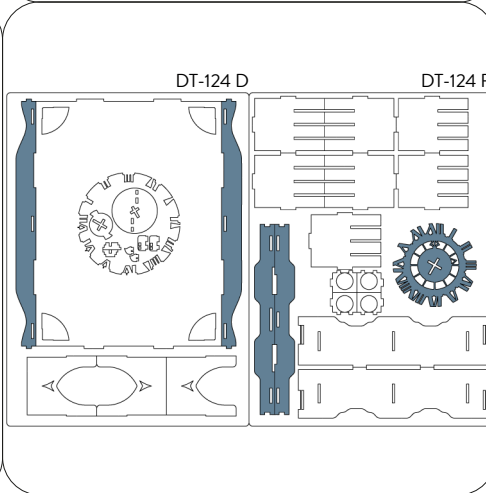

NOTE: Pay attention to the joints of the two pieces, they are different.
Presta attenzione agli incastri dei due pezzi, sono differenti tra loro.

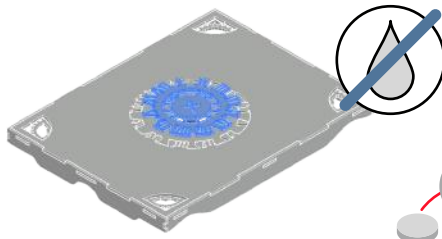
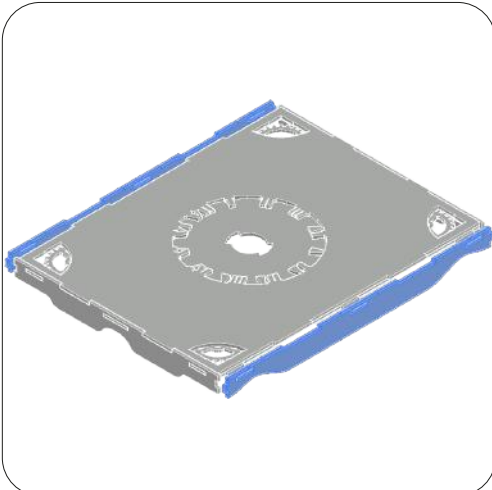

NOTE: Face the engravings upwards and make the this piece match the drawing in the lid. Don't use glue on this joint; rotating element. Rivolgi le incisioni verso l'alto e fai in modo che questo pezzo corrisponda al disegno nel coperchio. Non usare colla su questo incastro, elemento rotante.

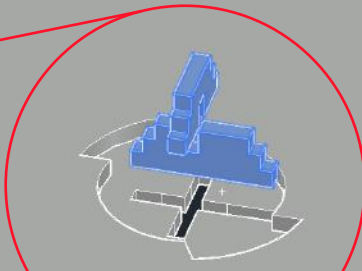
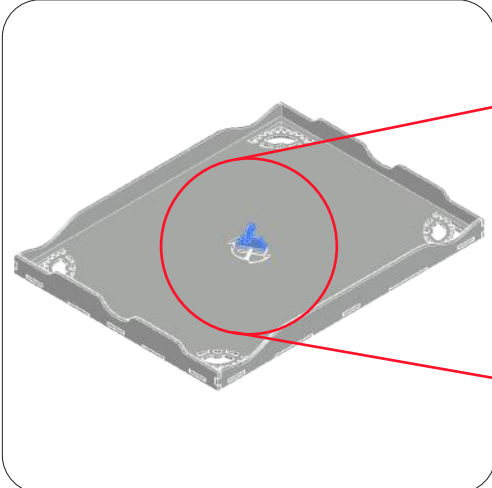
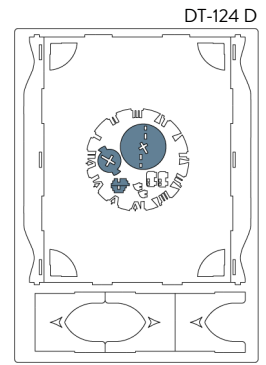
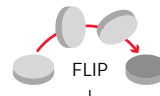

NOTE: Pay attention to glue only the joints; rotating element. Presta attenzione ad incollare solamente gli incastri; elemento rotante.



NOTE: Face the engravings upwards. Pay attention to glue only the joints; rotating element. Rivolgi le incisioni verso l'alto. Presta attenzione ad incollare solamente gli incastri; elemento rotante.

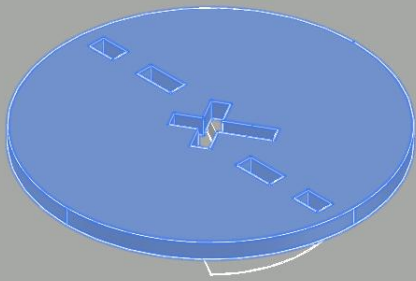

NOTE: Face the engravings upwards. Pay attention to glue only the joints; rotating element. Rivolgi le incisioni verso l'alto. Presta attenzione ad incollare solamente gli incastri; elemento rotante.

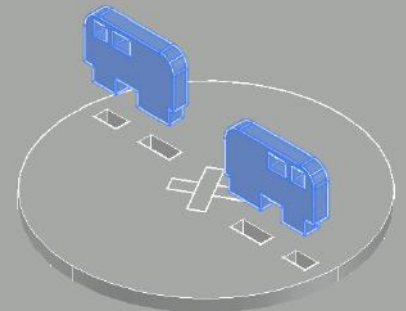
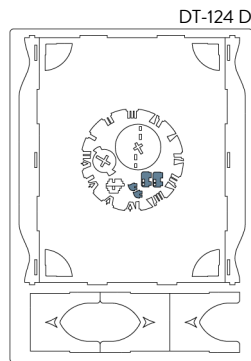

NOTE: match the engravings: square with square, circle with circle. Abbinare le incisioni: quadrato con quadrato, cerchio con cerchio.

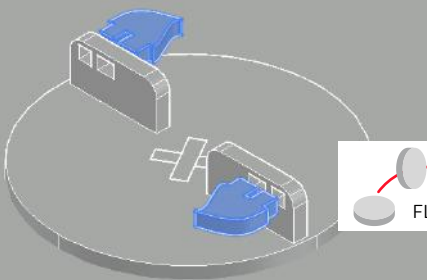

NOTE: match the engravings: square with square, circle with circle. Abbinare le incisioni: quadrato con quadrato, cerchio con cerchio.

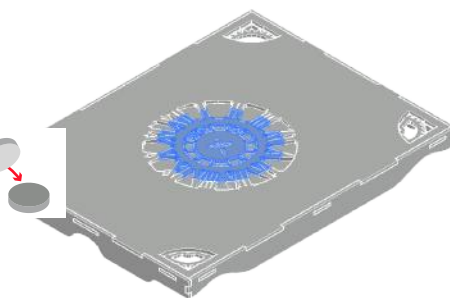
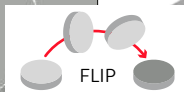

NOTE: Clock in closed position. Orologio in posizione chiusa.

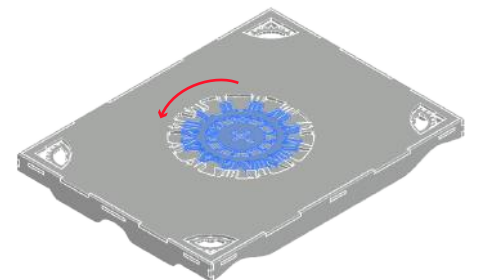

NOTE: Clock in open position. Hold in open position before proceeding. Orologio in posizione aperta. Mantieni in posizione aperta prima di procedere.

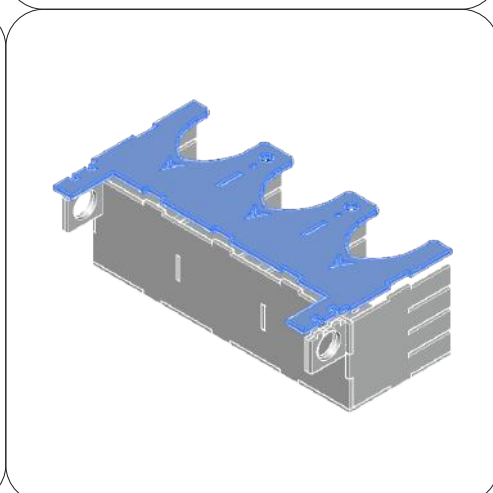
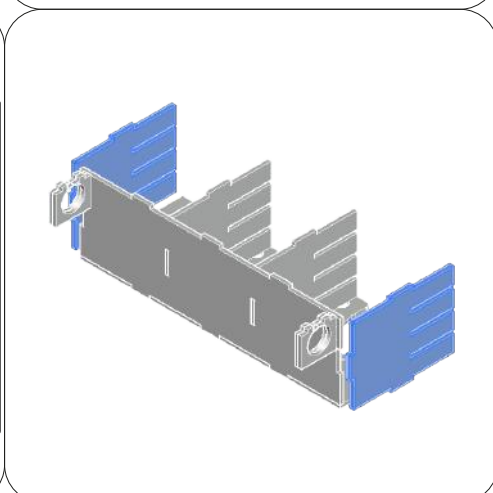
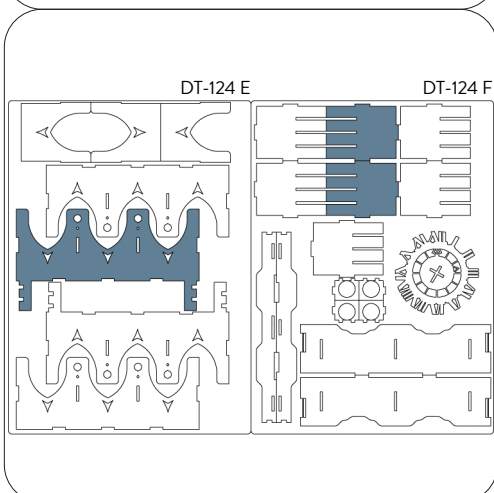
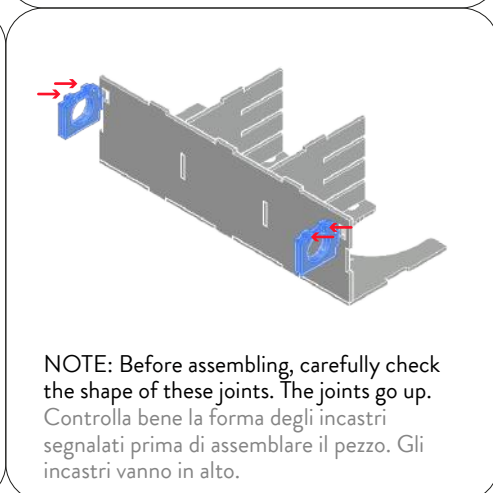
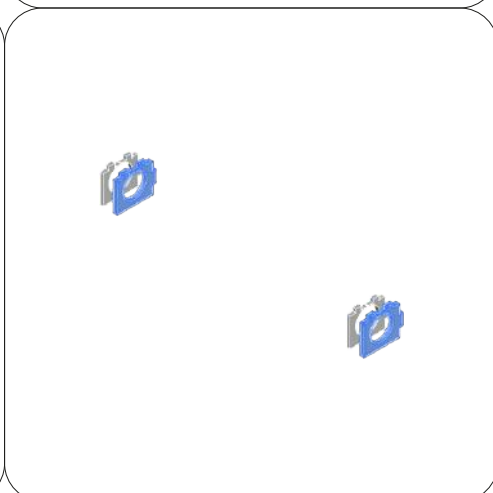
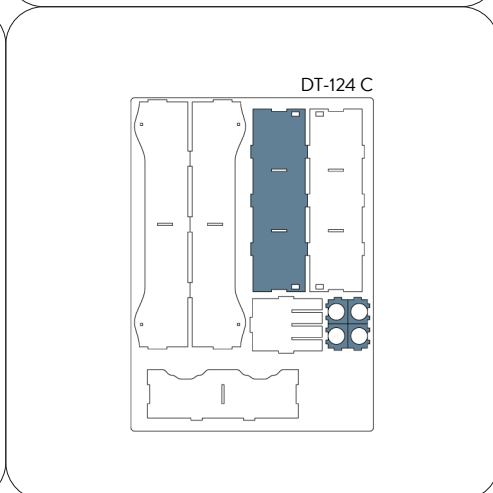
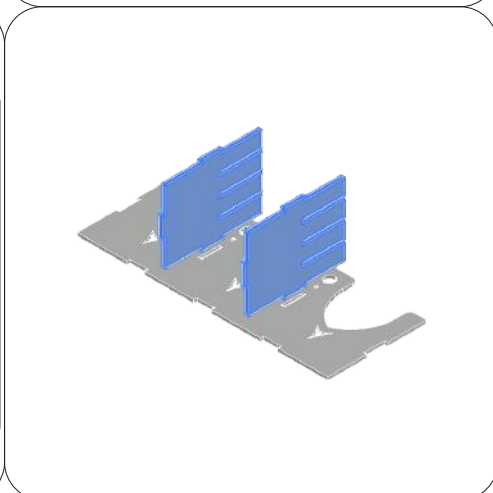
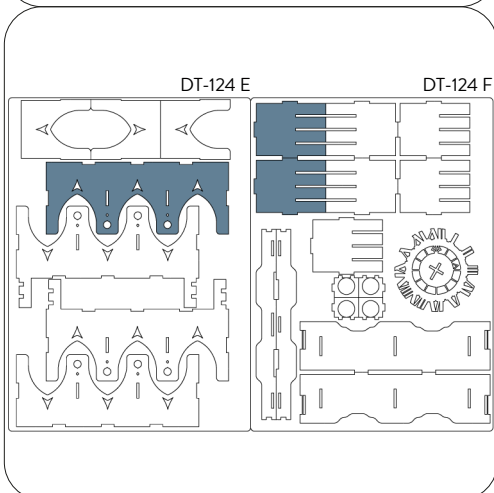

2x

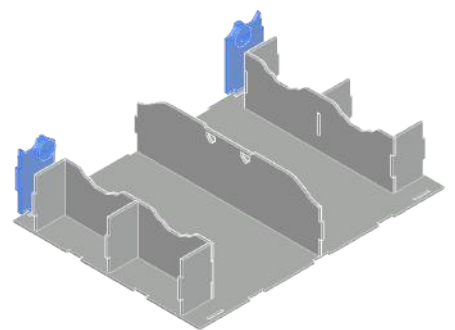
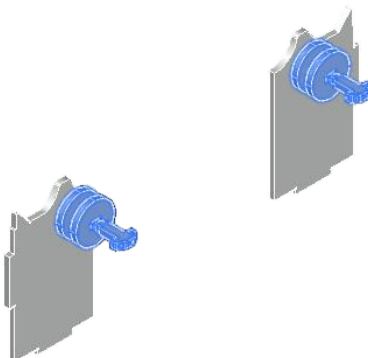
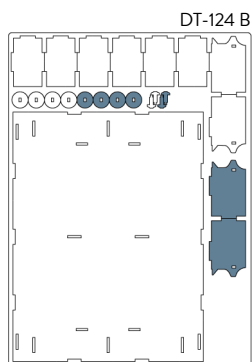
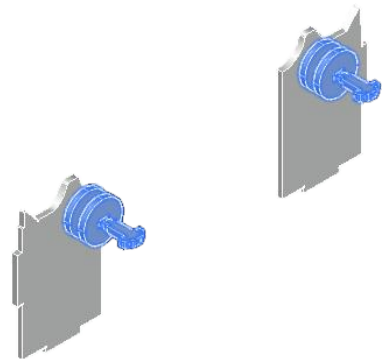
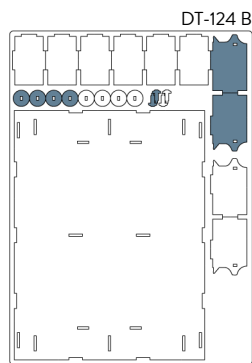
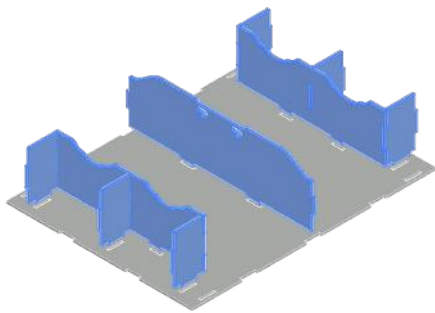
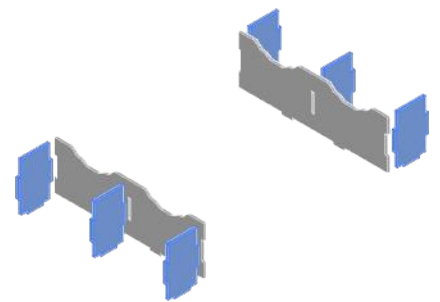
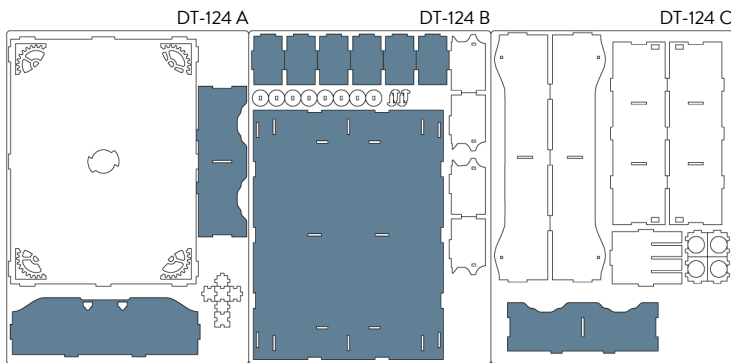
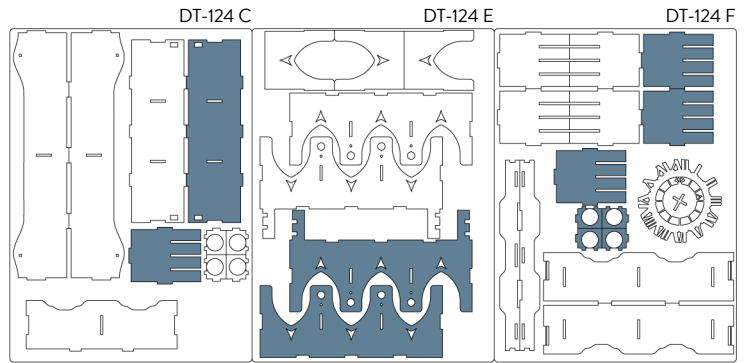
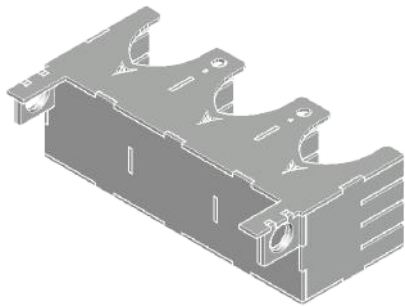

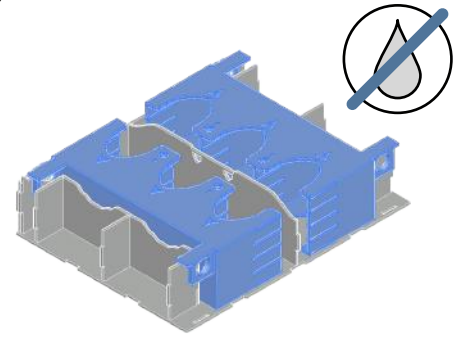
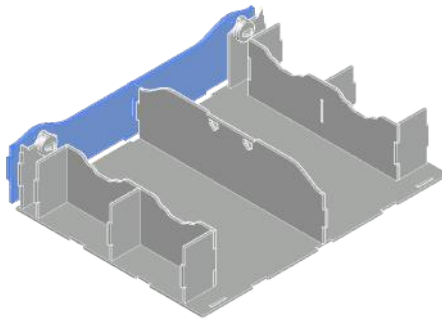
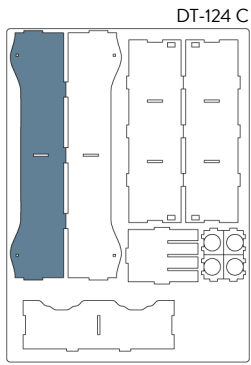

NOTE: Don't use glue on this joint; rotating element. Non usare colla su questo incastro, elemento rotante.

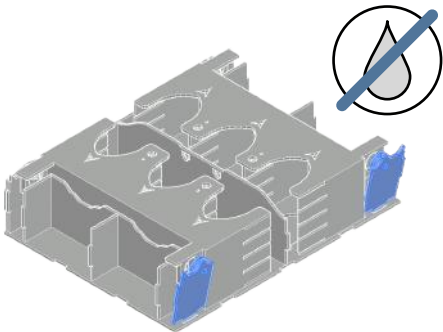

NOTE: Don't use glue on the rotating elements. Use glue only on the base. Non usare colla sui rotanti. Incollare solamente sulla base.

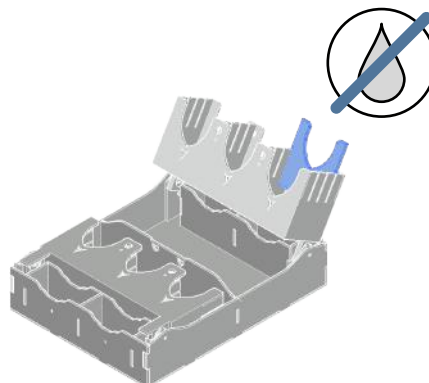
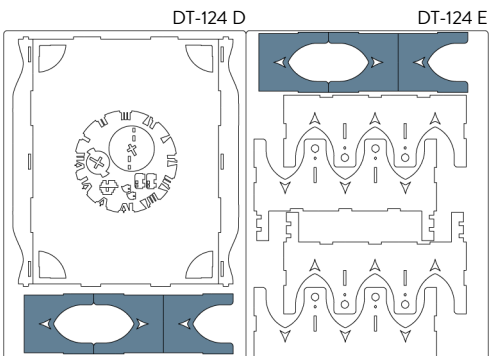
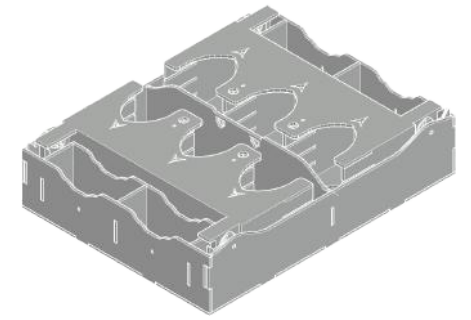
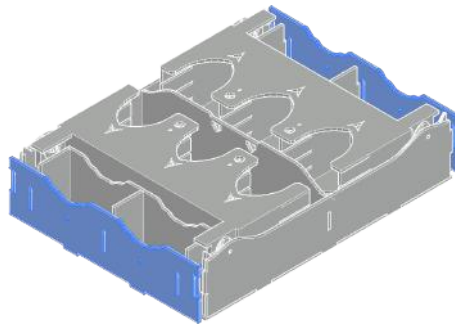
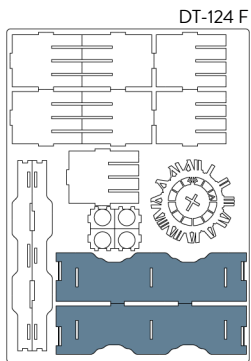
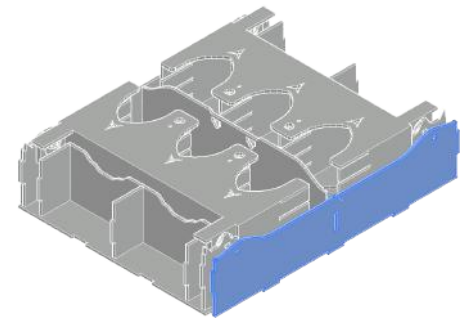
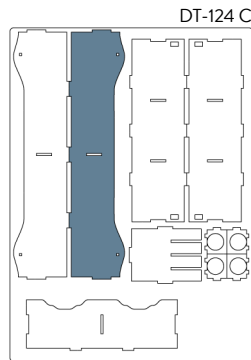

NOTE: Don't use glue on the movable dividers. Non usare colla sui divisori mobili.



CLOCK IN OPEN POSITION.
OROLOGIO IN POSIZIONE APERTA.



CLOCK IN CLOSED POSITION.
OROLOGIO IN POSIZIONE CHIUSA.



Take care, don't overturn the box!
Riporre con cura la scatola, non ribaltare!



Non-recyclable waste
Smaltire i materiali di scarto nell'indifferenziata

All trademarks and copyrights are the property of their respective owners.
This product is not a toy. Contains small parts that can be swallowed or inhaled. 14+