

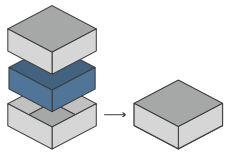

## ORGANIZER - COMPATIBLE WITH GLOOMHAVEN: JAWS OF THE LION (SPOILER FREE)



Designed to fit into the game box; flush closure is guaranteed. Progettato per inserirsi all'interno della scatola del gioco; garantisce chiusura a filo\*



Designed for both sleeved and unsleeved cards. Adatto sia per carte imbustate che non imbustate\*

120

Pieces to assemble  
Pezzi da assemblare

27.9 x 21.5 x 7.7 cm

Size of assembled organiser  
Dimensioni organizer assemblato

### ORGANIZER CAPACITY

2x trays for monster and boss tokens; 1x coin tray; 2x card holders with dedicated slots; 1x tray for monster description cards and sleeves; 1x white and yellow standees tray; 1x box for traps, ambient and trunk tokens; 1x status tokens box; 1x wound tokens tray; 1x board for monster and character names, and element tokens. 2x vassoi per token mostri e boss; 1x vassoio per monete; 2x portacarte con slot dedicati; 1x vassoio per carte descrizione mostri e sleeves; 1x vassoio per standee bianchi e gialli; 1x contenitore per token trappole, ambiente, bauli; 1x contenitore per token status; 1x vassoio per token ferita; 1x plancetta per token nomi mostro, personaggi e elementi.

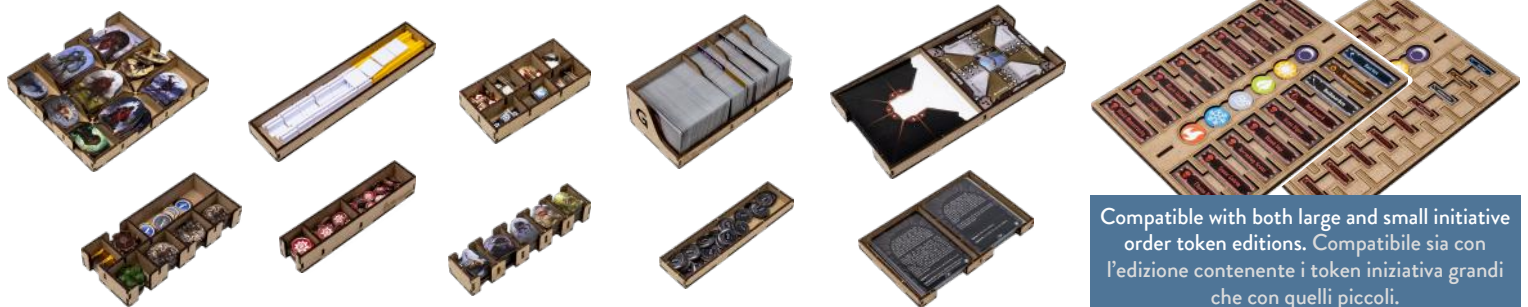

Compatible with both large and small initiative order token editions. Compatibile sia con l'edizione contenente i token iniziativa grandi che con quelli piccoli.

\* Any doubt?  
Check out our FAQ page or download the digital version of the instructions on our website!

All trademarks and copyrights are the property of their respective owners.  
This product is not a toy. Contains small parts that can be swallowed or inhaled. 14+

[thedictroyers.com](http://thedictroyers.com) /thedictroyers /thedictroyers [info@thedictroyers.com](mailto:info@thedictroyers.com)





ORGANIZER - COMPATIBLE WITH  
**GLOOMHAVEN: JAWS OF THE LION**  
 (SPOILER FREE)



## TUTORIAL - THE DICETROYERS DICE!

Among the pieces to assemble, you'll find a dice. This is not part of the organizer, but it can be a good starting point to practice!

Tra i materiali da assemblare troverai un dado. Questo componente non fa parte dell'organizer, né del gioco, ma è un ottimo punto di partenza per fare un po' di pratica.

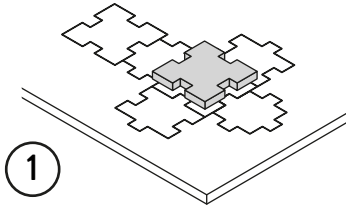

1

Gently take off  
all the pieces.  
Stacca delicatamente  
dal foglio tutti i pezzi.

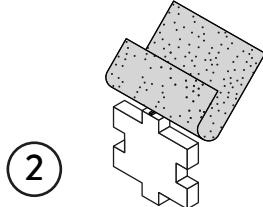

2

If necessary, use sand paper to  
smoothen the borders.  
Se necessario rifila con carta  
vetrata per legno eventuali  
imperfezioni dei pezzi.

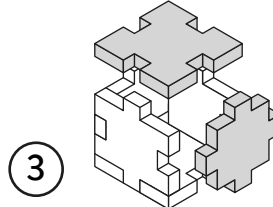

3

Get familiar with  
all the pieces  
and check the correct assembly  
sequence.  
Prendi familiarità con tutti  
i pezzi, per assicurarti  
che la sequenza di assemblaggio sia  
corretta.

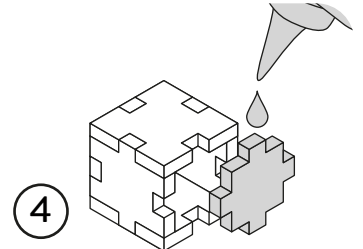

4

Once verified the correct assembly  
sequence, just add a small quantity  
of PVA glue on every joint.  
Dopo aver verificato  
la sequenza di assemblaggio  
aggiungi una piccola quantità di  
colla vinilica su tutti  
gli incastri per garantirne  
la durata nel tempo.

## INSTRUCTIONS

A



DT-87A

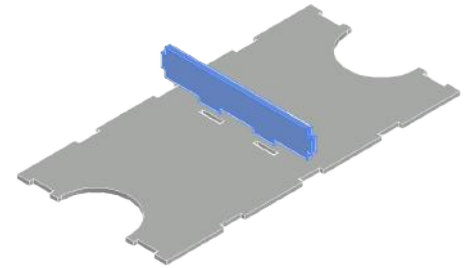
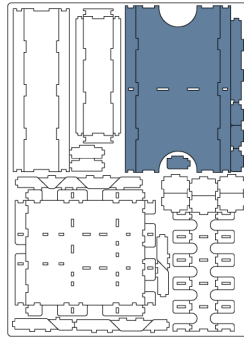

B

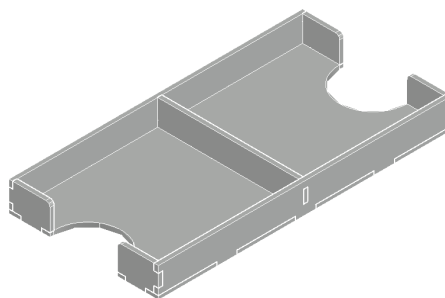
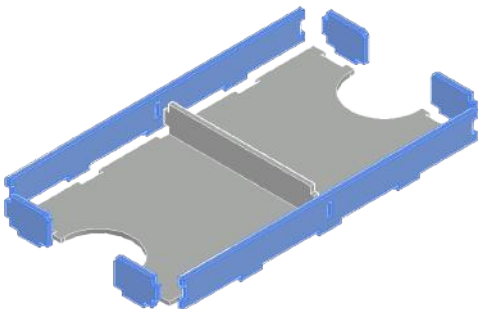

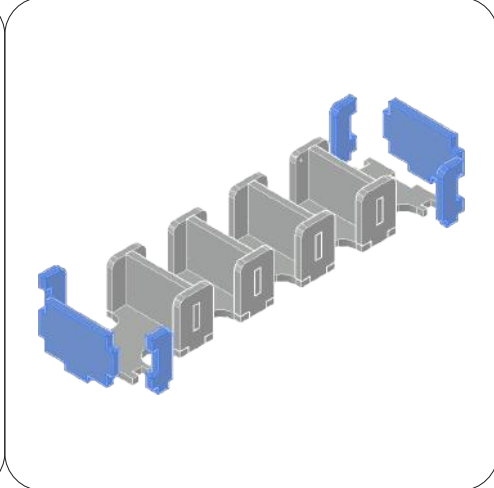
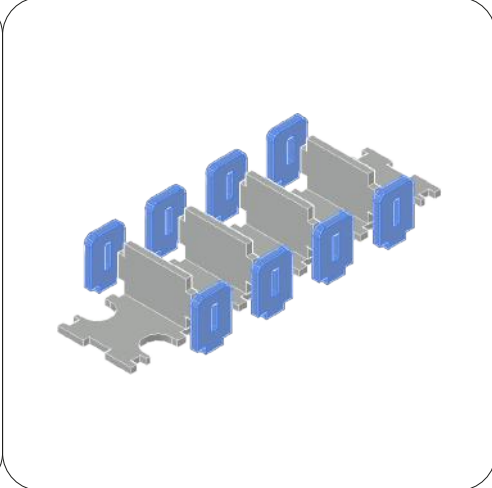
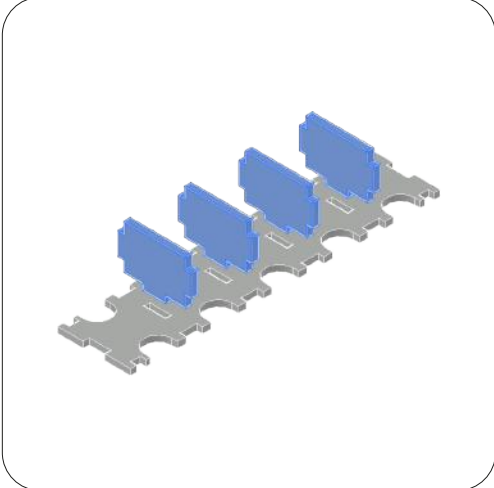
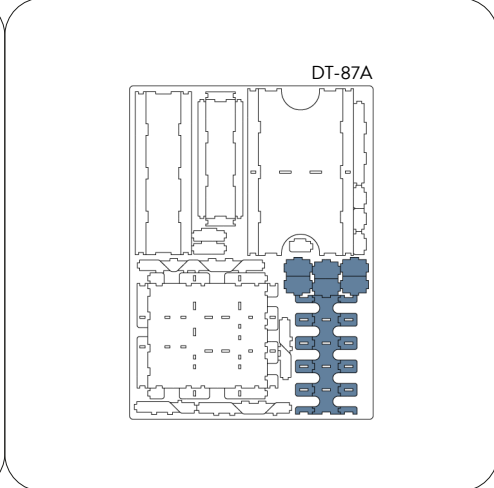
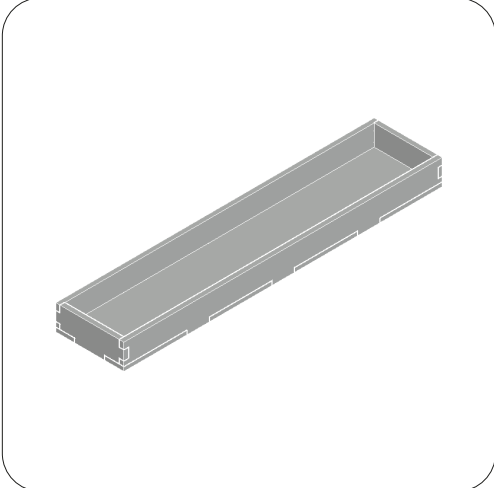
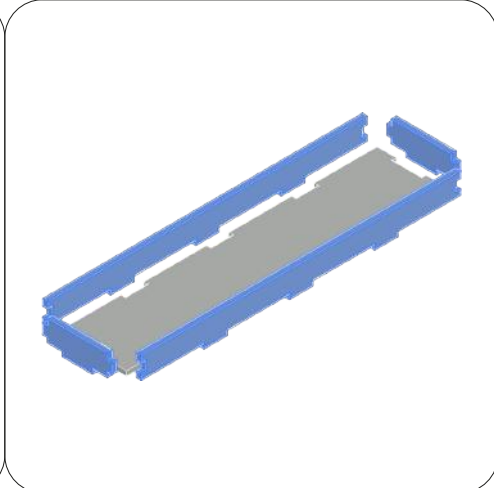
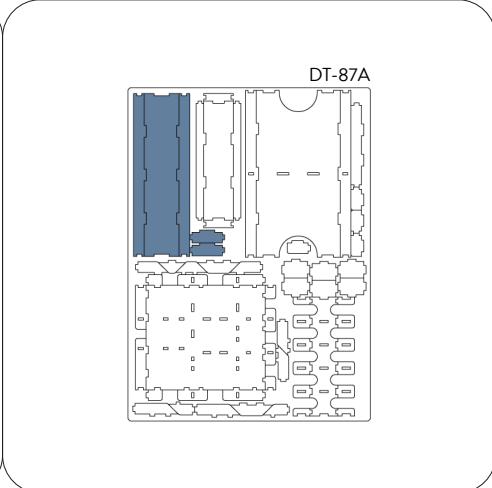
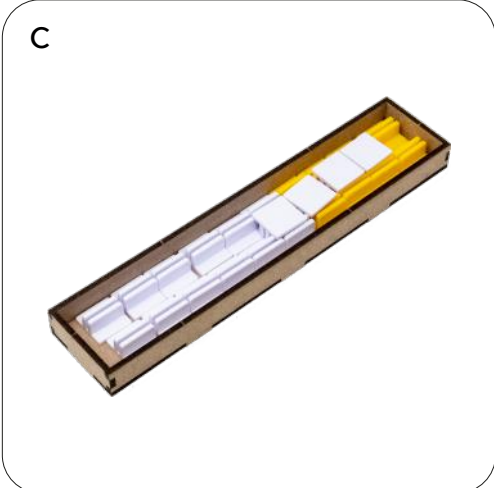
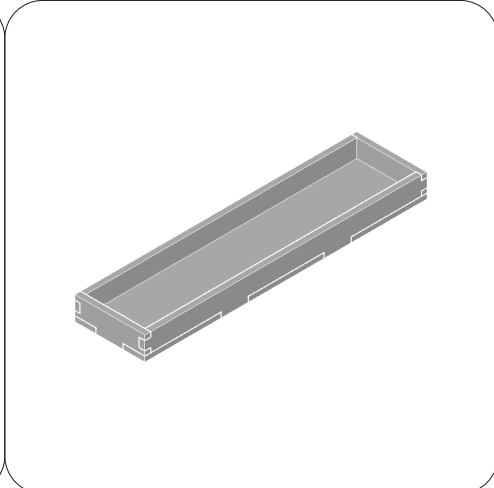
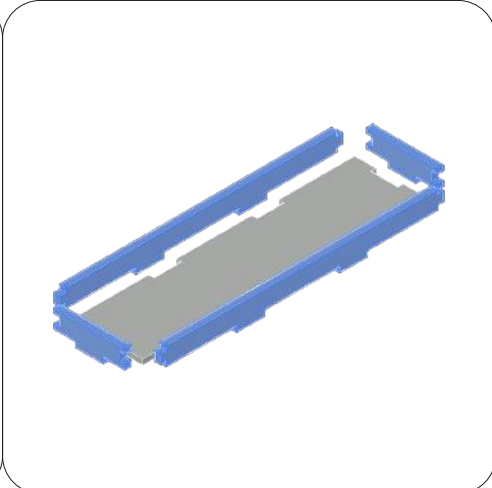
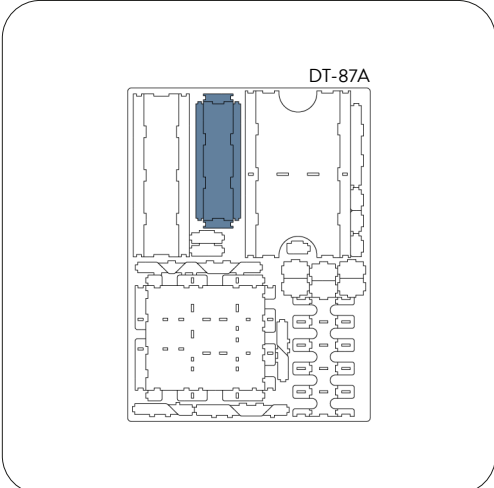

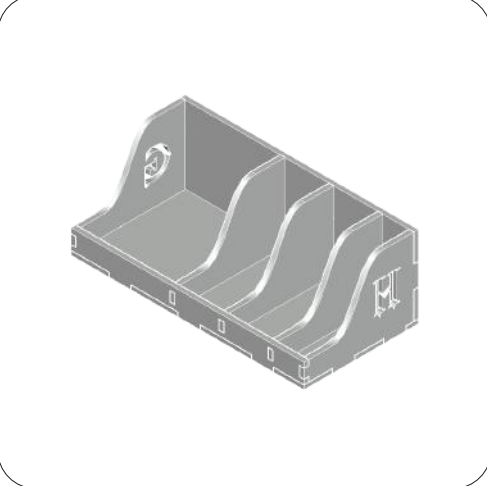
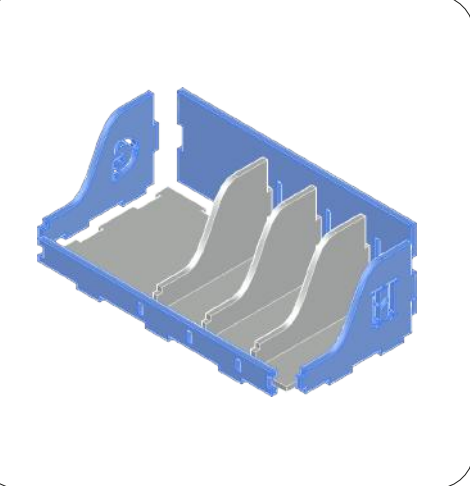
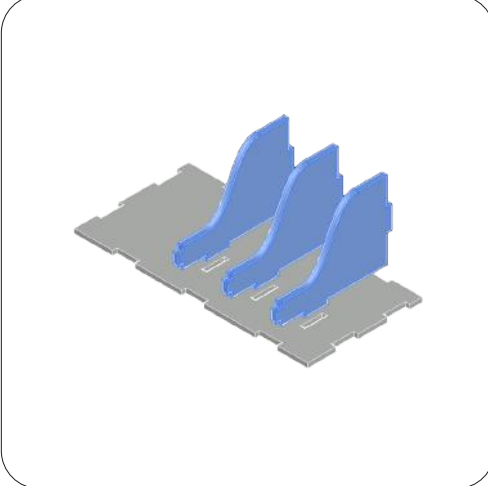
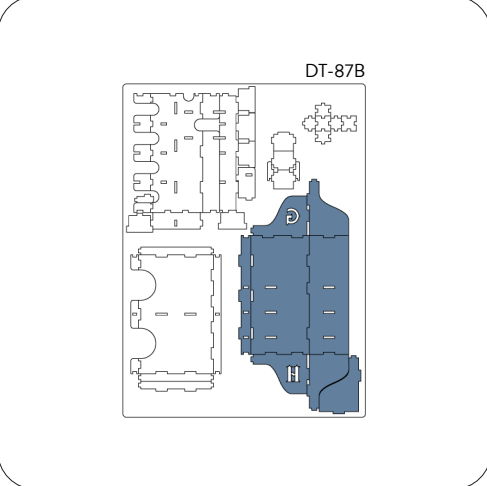
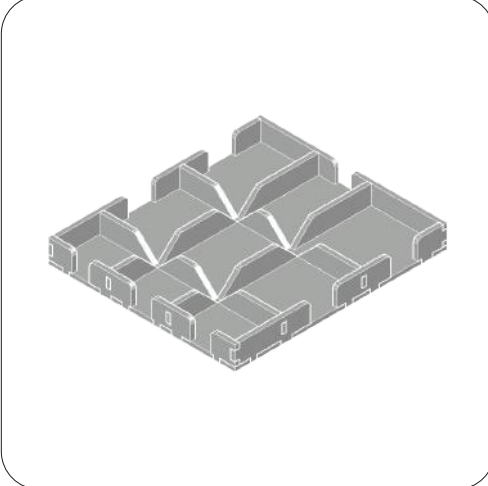
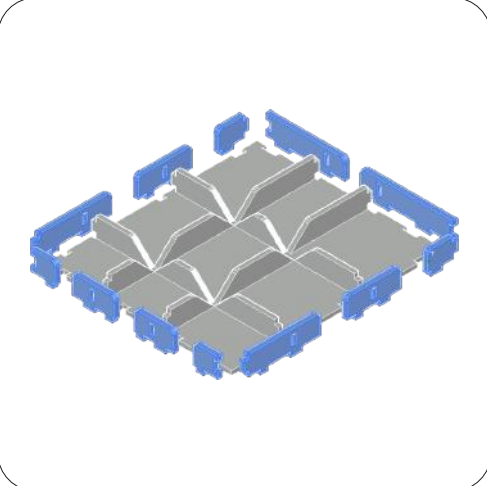
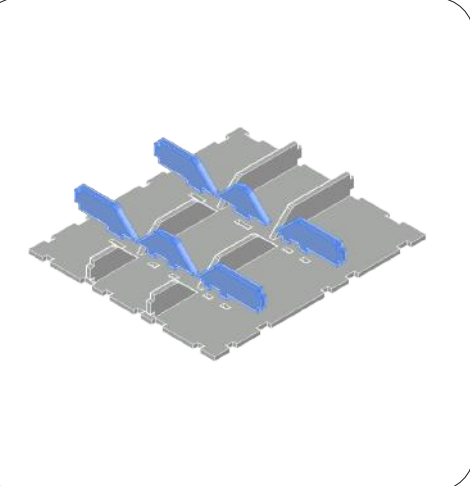
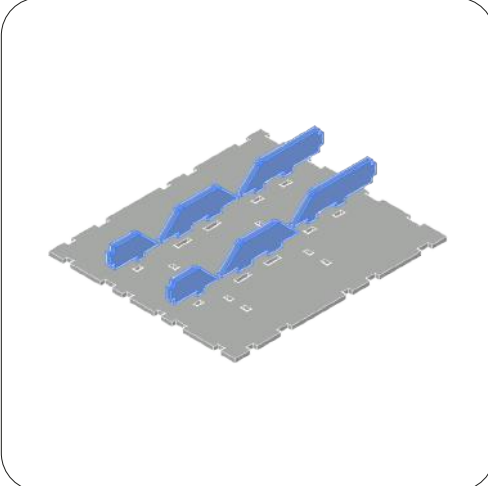
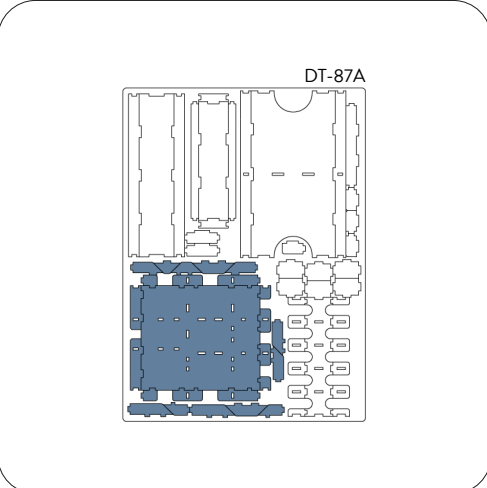
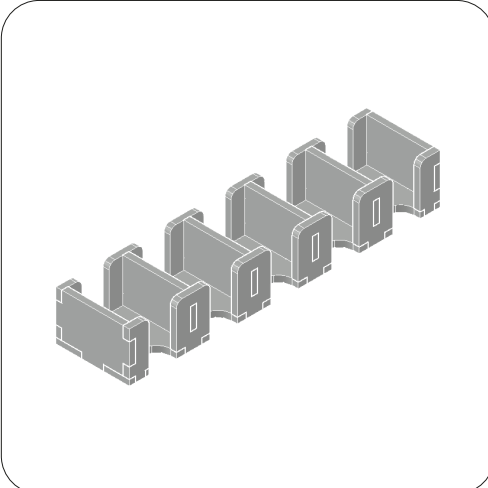

G



DT-87B

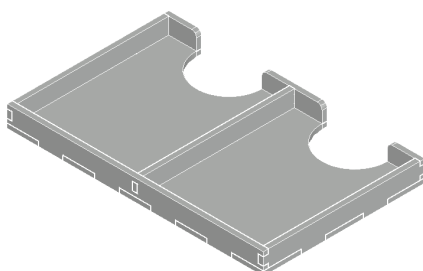
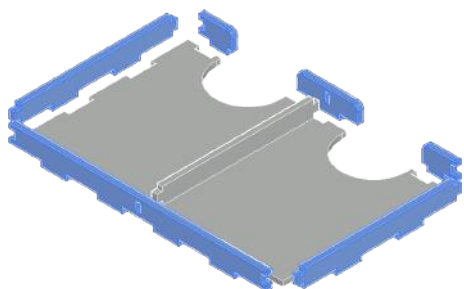
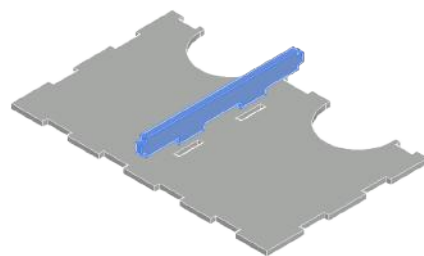
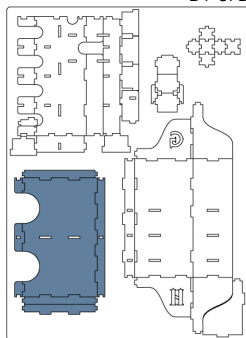

H



DT-87B

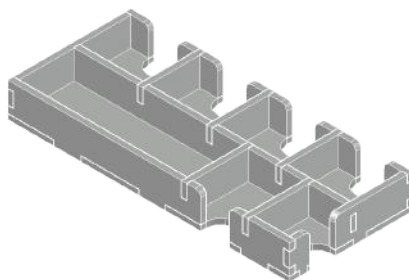
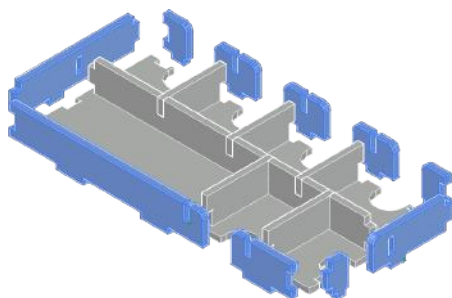
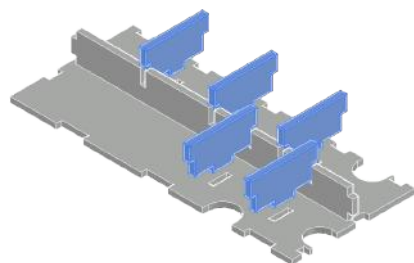
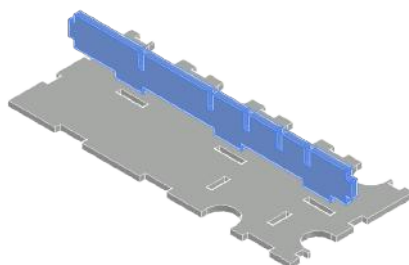
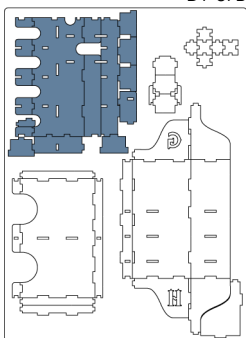

I



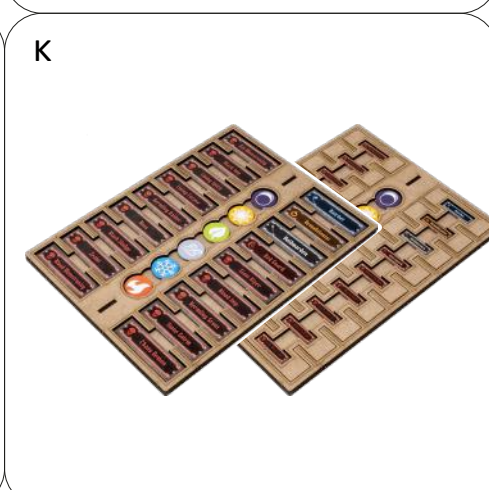
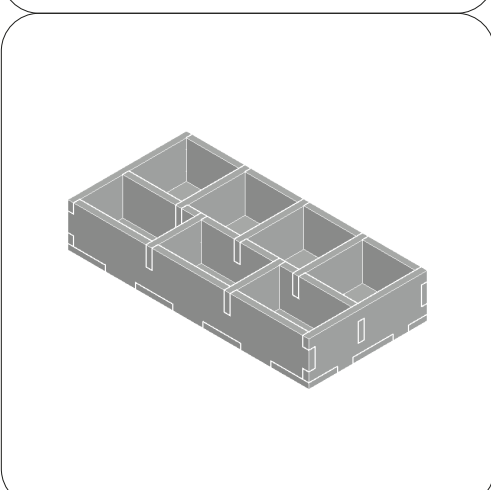
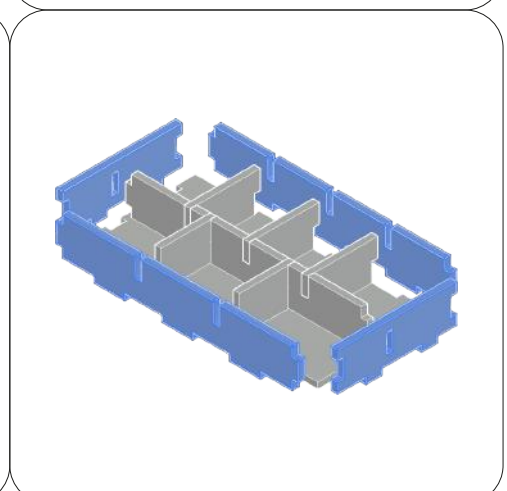
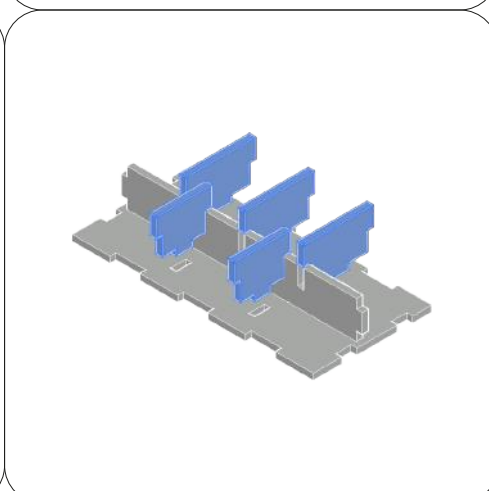
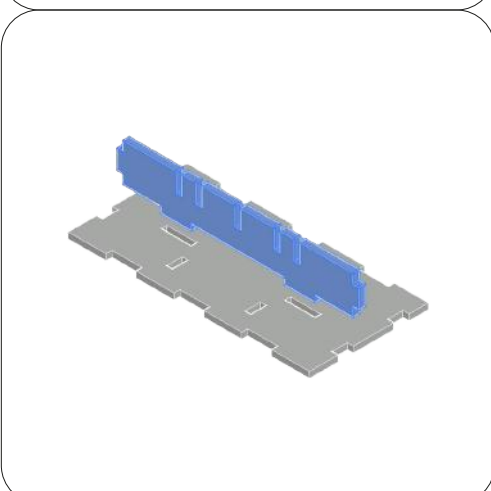
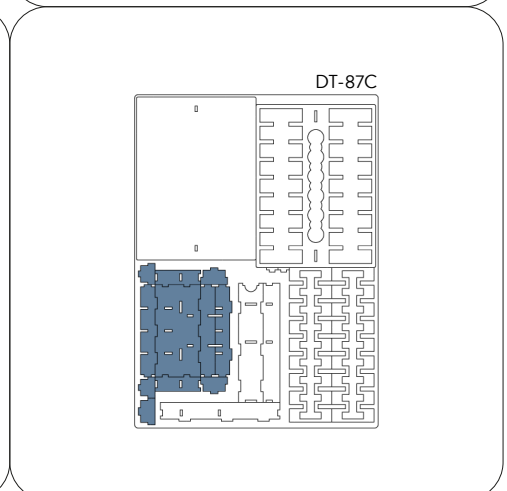
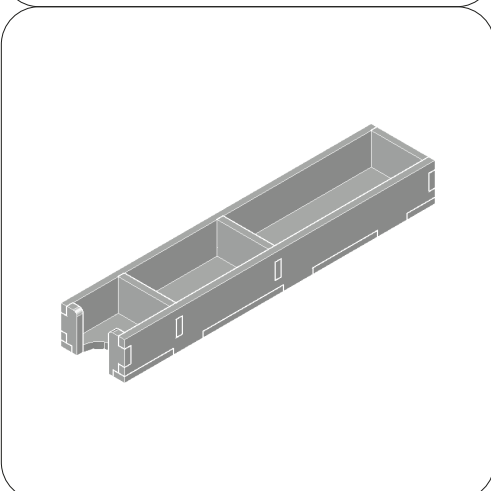
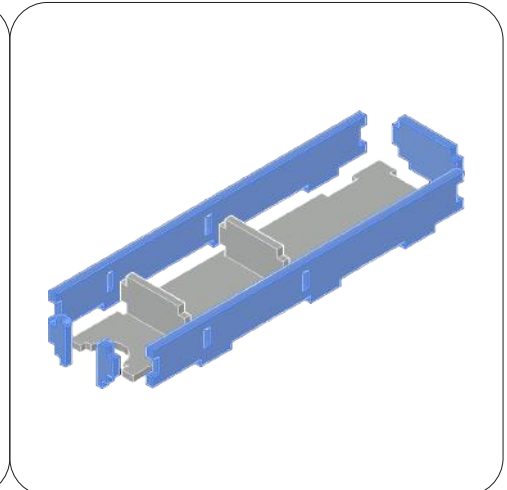
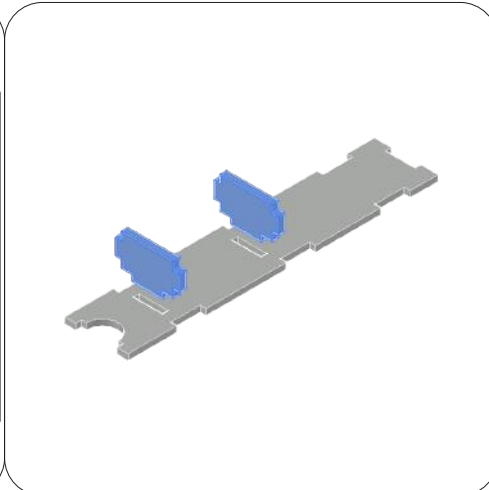

**NOTE**  
 Our organizer is compatible with both large and small initiative order token editions. If you have the large one follow only the K.1 sequence, if you have the small one follow K.1 + K.2 sequences. Il nostro organizer è compatibile sia con l'edizione contenente i token iniziativa grandi che con quelli piccoli. Se hai l'edizione con i token grandi segui solamente la sequenza al punto K.1, se hai l'edizione con i token piccoli segui entrambe le sequenze: K.1 + K.2

K.1



DT-87C

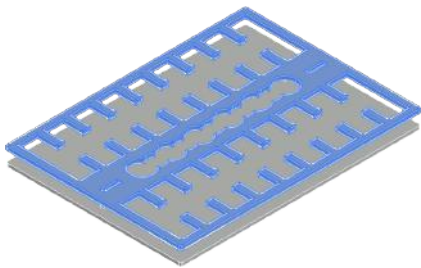
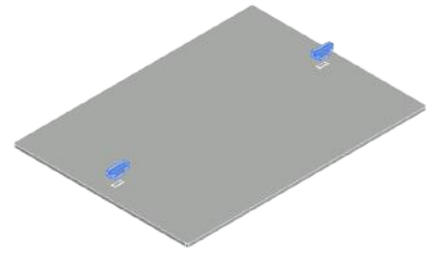
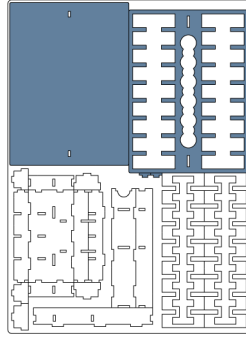

NOTE: Place the engraved sides facing upwards. Presta attenzione ai lati incisi, vanno rivolti verso l'alto.

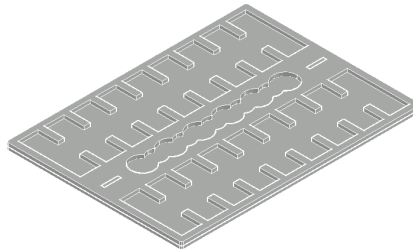

K.2



DT-87C

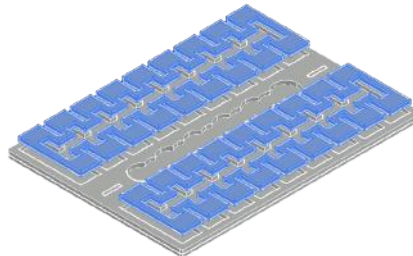
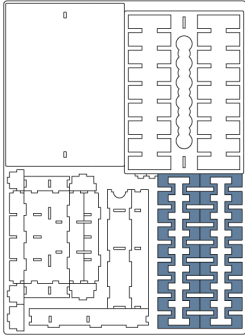

NOTE: Place the engraved sides facing upwards. Presta attenzione ai lati incisi, vanno rivolti verso l'alto.

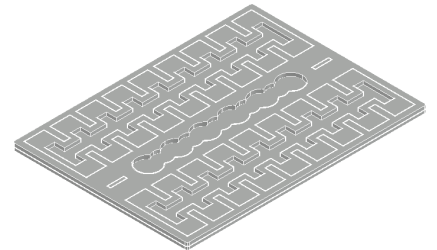

## PIECE INSERTION REFERENCE

Please see this reference, which guides you for pieces insertion in our organizer. Pieces without references (eg coin tokens) have their drawing directly in place. Questa è una guida per l'inserimento dei componenti nei giusti alloggiamenti. Qualora non vi sia riferimento qui, troverete la sagoma del pezzo incisa nello spazio corrispondente.

I	Blood Tumor; Blood Horror; First of the order
II	Zealot; Chaos Demon; Stone Golem; Blood Monstrosity
III	Vermiling Raider; Living Corpse; Living Spirit; Black Sludge
IV	Vermiling Scout; Giant Viper; Blood Imp; Rat Monstrosity; Black Imp

V	Destruction Token
VI	Poison Trap Tiles
VII	Trap Tiles
VIII	Treasure Tiles

## REBOXING SEQUENCE!



Every piece will stay in its slot. Follow the reboxing sequence to properly store your organizer. We recommend using a h-band to avoid accidental box opening. Don't shake. Ogni componente rimarrà al suo posto. Segui la sequenza di reinserimento per riporre nella maniera corretta il tuo organizer. Consigliamo l'utilizzo di una h-band per evitare aperture accidentali. Non scuotere.



All trademarks and copyrights are the property of their respective owners.  
This product is not a toy. Contains small parts that can be swallowed or inhaled. 14+