

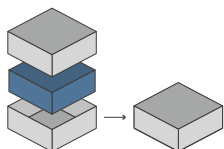

## ORGANIZER - COMPATIBLE WITH ZOMBICIDE



Designed to fit into the game box; flush closure is guaranteed. Progettato per inserirsi all'interno della scatola del gioco; garantisce chiusura a filo\*



Designed for both sleeved and unsleeved cards. Adatto sia per carte imbustate che non imbustate\*

66

Pieces to assemble  
Pezzi da assemblare

29.5 x 29.5 x 9.8 cm

Size of assembled organiser  
Dimensioni organizer assemblato

### ORGANIZER CAPACITY

1x zombie box, with room for 88 miniatures, "biohazard" lid and shutter closure (space for all the zombies in core box and for zombies from expansions or other seasons, except abominations and large miniatures); 1x card holder with space for 60 microns (eg Sapphire) sleeved cards or not, additional space for expansion cards (equipment and zombie generation), removable dividers; 1x box for tokens, dice and character cards, with 4 slots, for map setup; 1x token box for pieces to be used during the match; 1x character and abomination minis box. 1x box portaminature zombie, con spazio per 88 miniature totali, coperchio "biohazard" e chiusura a saracinesca (spazio per tutti gli zombie del gioco base e per ulteriori zombie delle espansioni varie o altre seasons, tranne abomini e miniature grandi); 1x portacarte con spazio per carte imbustate 60 micron (eg Sapphire) e non, spazio aggiuntivo per carte da espansione (equipaggiamento e generazione zombie), divisori rimovibili; 1x scatola portatoken, dadi e schede personaggi, con 4 alloggiamenti, per setup plancia e mappa; 1x scatola portatoken per pezzi da usare in game; 1x portaminature personaggi e abominio.



\* Any doubt?  
Check out our FAQ page or download the digital version of the instructions on our website!

All trademarks and copyrights are the property of their respective owners.  
This product is not a toy. Contains small parts that can be swallowed or inhaled. 14+

[thedictroyers.com](http://thedictroyers.com) [/thedictroyers](https://www.facebook.com/thedictroyers) [/thedictroyers](https://www.instagram.com/thedictroyers) [info@thedictroyers.com](mailto:info@thedictroyers.com)





## ORGANIZER - COMPATIBLE WITH ZOMBICIDE

### TUTORIAL - THE DICETROYERS DICE!

Among the pieces to assemble, you'll find a dice. This is not part of the organizer, but it can be a good starting point to practice!

Tra i materiali da assemblare troverai un dado. Questo componente non fa parte dell'organizer, né del gioco, ma è un ottimo punto di partenza per fare un po' di pratica.

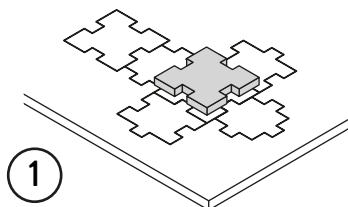

1

Gently take off  
all the pieces.  
Stacca delicatamente  
dal foglio tutti i pezzi.

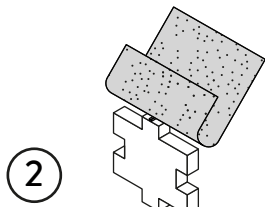

2

If necessary, use sand paper to  
smoothen the borders.  
Se necessario rifila con carta  
vetrata per legno eventuali  
imperfezioni dei pezzi.

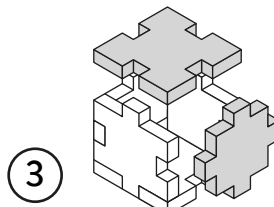

3

Get familiar with  
all the pieces  
and check the correct assembly  
sequence.  
Prendi familiarità con tutti  
i pezzi, per assicurarti  
che la sequenza di assemblaggio sia  
corretta.

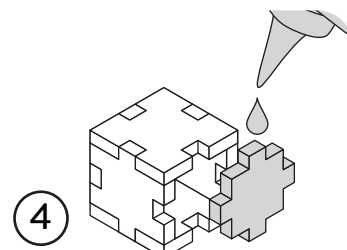

4

Once verified the correct assembly  
sequence, just add a small quantity  
of PVA glue on every joint.  
Dopo aver verificato  
la sequenza di assemblaggio  
aggiungi una piccola quantità di  
colla vinilica su tutti  
gli incastri per garantirne  
la durata nel tempo.

## INSTRUCTIONS

A

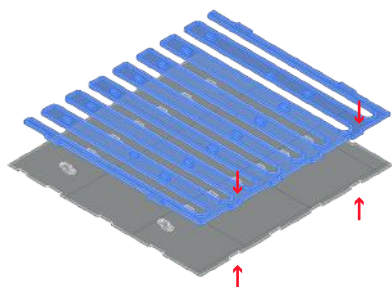
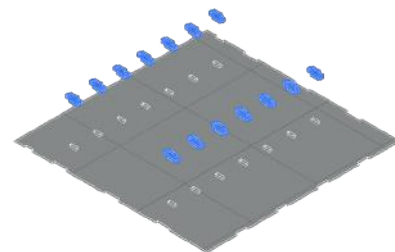
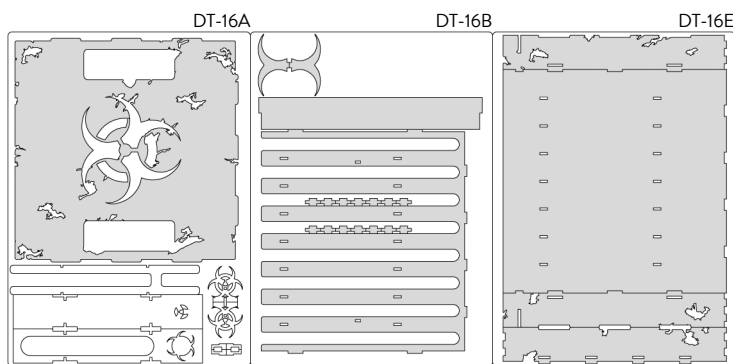

NOTE: Before assembling, carefully check  
the shape of these joints. Controlli bene la  
forma degli incastri segnalati prima di  
assemblare il pezzo.

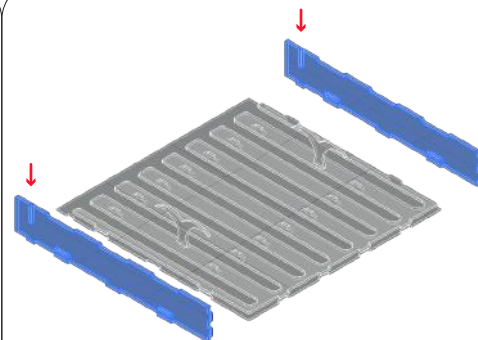
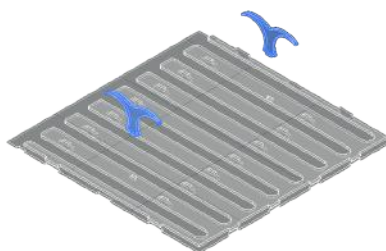

NOTE: Before assembling, carefully check  
the shape of these joints. Controlli bene la  
forma degli incastri segnalati prima di  
assemblare il pezzo.

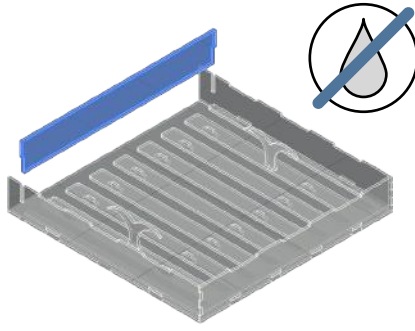
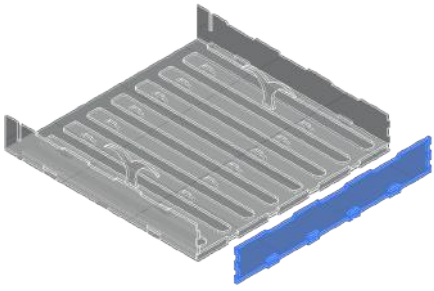

NOTE: Don't use glue on this joint; this piece can be removed during the game. Non usare colla su questo incastro, pezzo rimovibile durante il gioco.

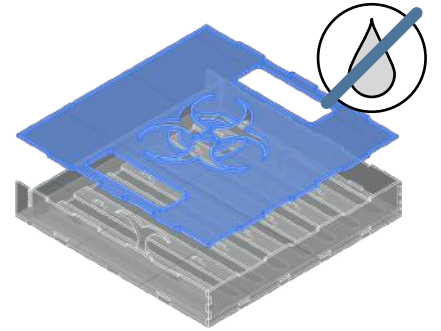

NOTE: Don't use glue on this joint; this piece can be removed during the game. Non usare colla su questo incastro, pezzo rimovibile durante il gioco.

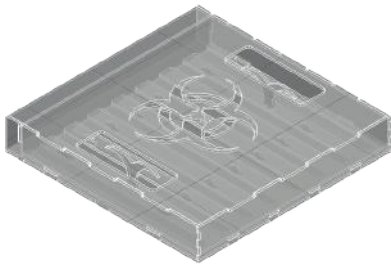

B

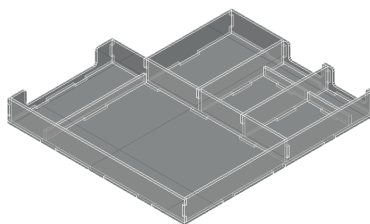
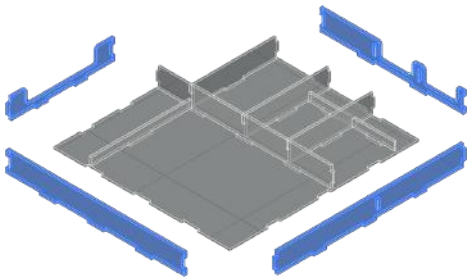
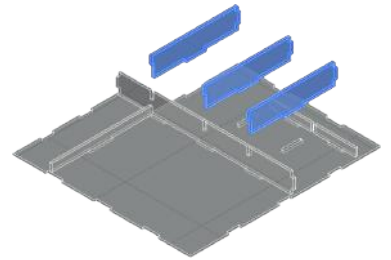
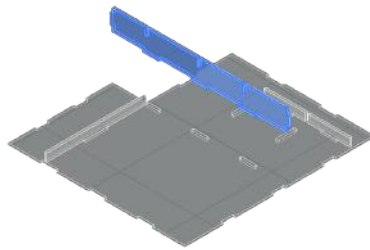
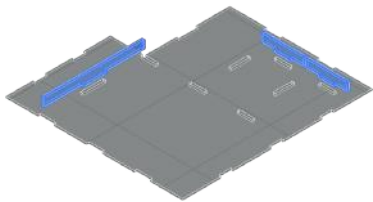
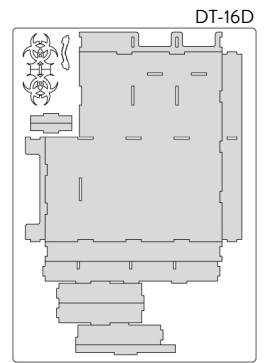

C

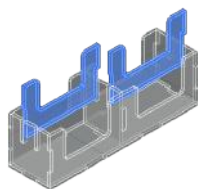
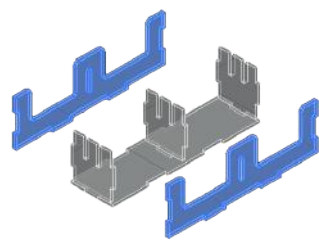
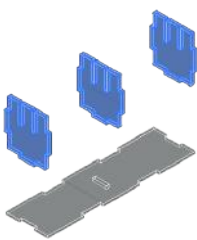
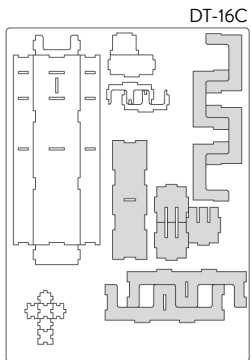

**NOTE:** Don't use glue on this joint; this piece can be removed during the game. Non usare colla su questo incastro, pezzo rimovibile durante il gioco.

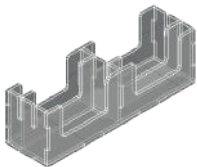

D

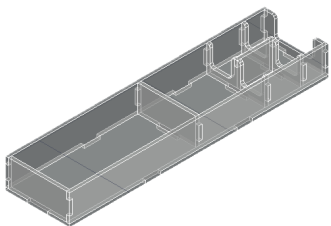
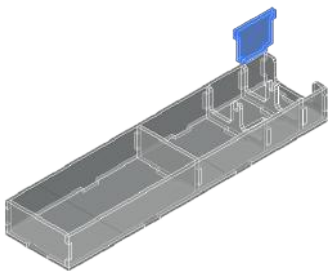
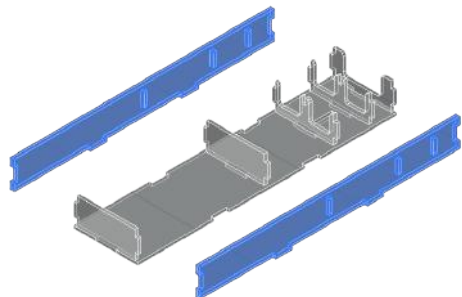
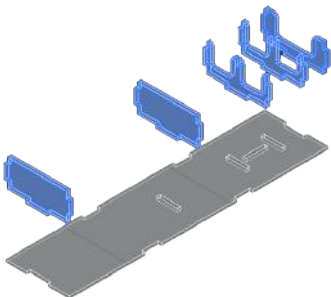
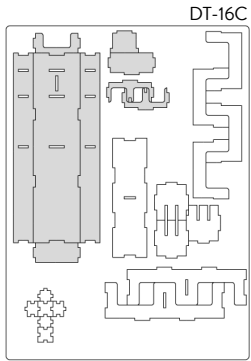

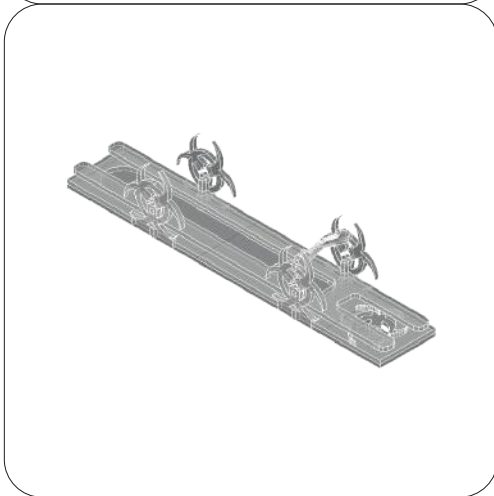
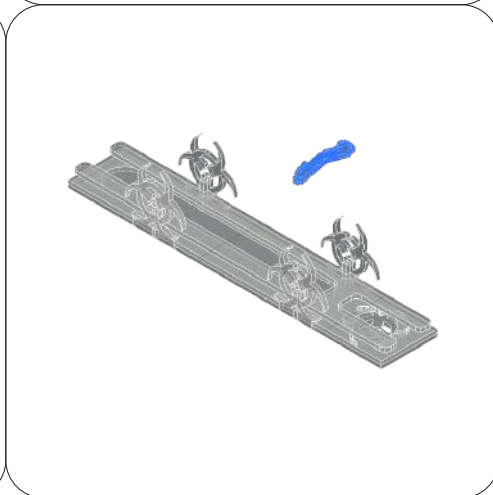
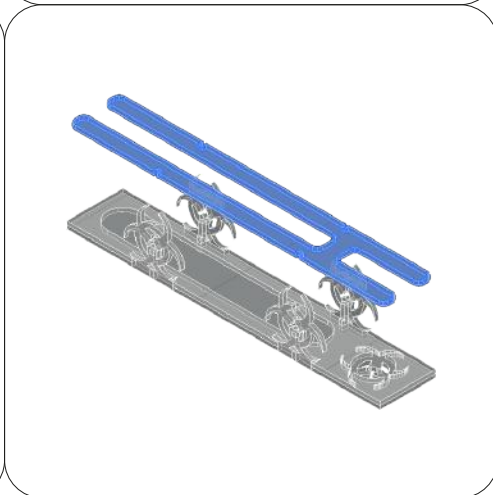
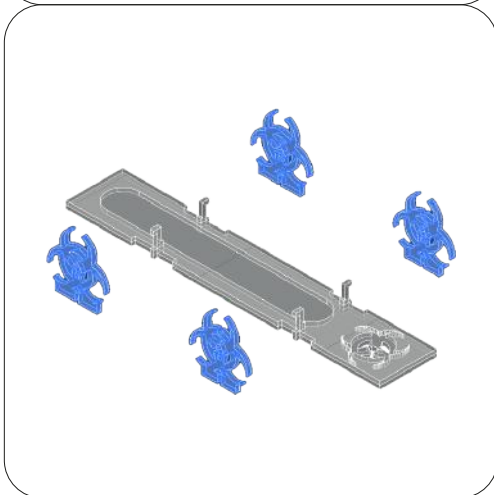
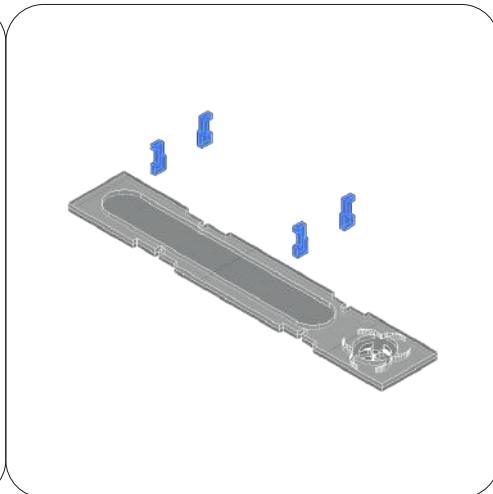
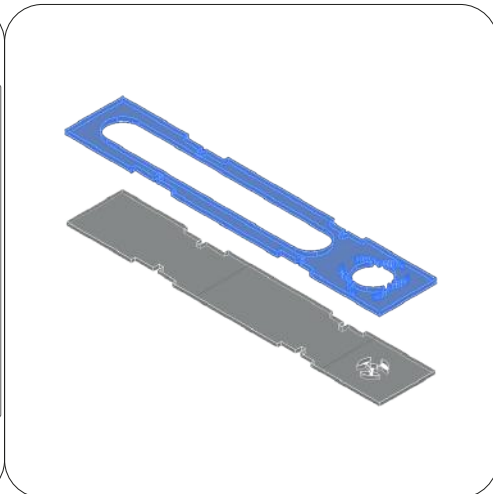
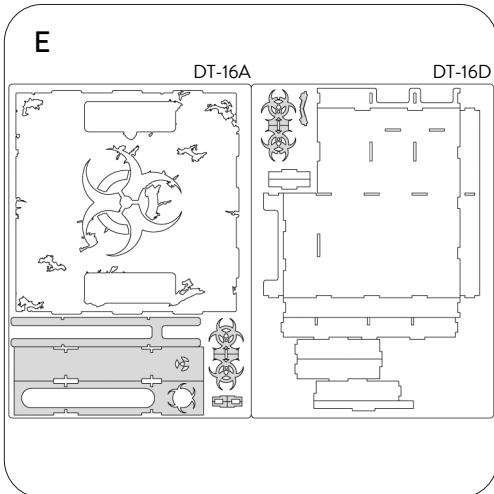

## REBOXING SEQUENCE!



Every piece will stay in its slot. Follow the reboxing sequence to properly store your organizer. We recommend using a h-band to avoid accidental box opening. Don't shake. Ogni componente rimarrà al suo posto. Segui la sequenza di reinserimento per riporre nella maniera corretta il tuo organizer. Consigliamo l'utilizzo di una h-band per evitare aperture accidentali. Non scuotere.



All trademarks and copyrights are the property of their respective owners.  
This product is not a toy. Contains small parts that can be swallowed or inhaled. 14+