

ORGANIZER - COMPATIBLE WITH IMPERIAL ASSAULT

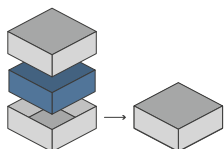

Designed to fit into the game box; flush closure is guaranteed. Progettato per inserirsi all'interno della scatola del gioco; garantisce chiusura a filo*

70

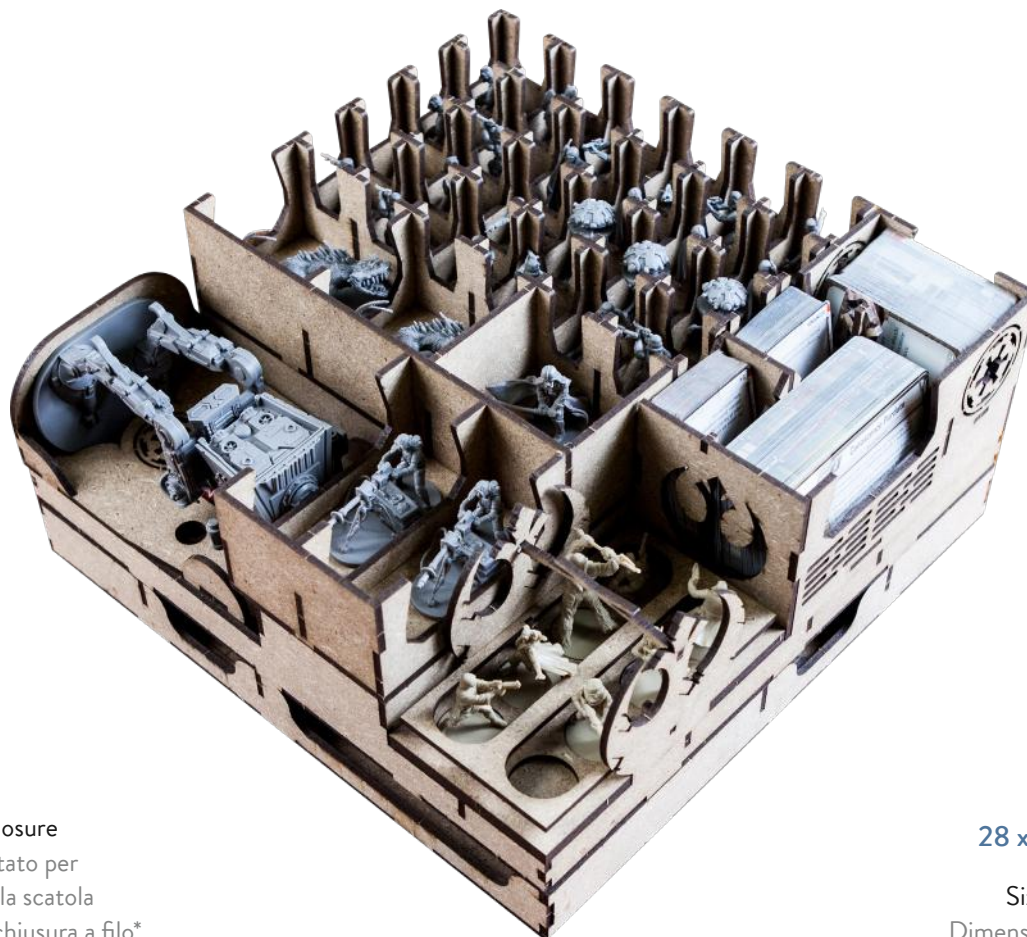

Pieces to assemble
Pezzi da assemblare

28 x 28 x 12.6 cm



Size of assembled organiser
Dimensioni organizer assemblato

ORGANIZER CAPACITY

1x box with 8 spaces for map pieces; 1x box with 1 slot for map pieces and 9 spaces for tokens and dices; 1x holder for AT-ST; 1x card holder for both big sized and small sized cards; 1x box for Imperial minis with 29 spaces; 1x box for Rebel Alliance minis with 8 spaces.

1x contenitore con 8 alloggiamenti per contenere i pezzi di mappa; 1x contenitore con 1 alloggiamento grande per contenere i pezzi di mappa e 9 alloggiamenti per token e dadi; 1x alloggiamento per AT-ST; 1x portacarte piccole e grandi; 1x portaminature imperiali, con 29 alloggiamenti; 1x portaminature ribelli, con 8 alloggiamenti.



* Any doubt?
Check out our FAQ page
or download the digital
version of the instructions
on our website!

All trademarks and copyrights are the property of their respective owners.
This product is not a toy. Contains small parts that can be swallowed or inhaled. 14+



ORGANIZER - COMPATIBLE WITH IMPERIAL ASSAULT

TUTORIAL - THE DICETROYERS DICE!

Among the pieces to assemble, you'll find a dice. This is not part of the organizer, but it can be a good starting point to practice!

Tra i materiali da assemblare troverai un dado. Questo componente non fa parte dell'organizer, né del gioco, ma è un ottimo punto di partenza per fare un po' di pratica.

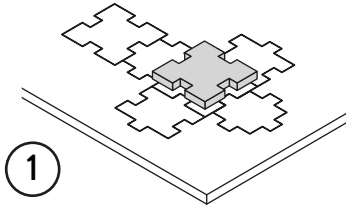

1

Gently take off
all the pieces.
Stacca delicatamente
dal foglio tutti i pezzi.

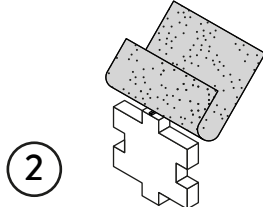

2

If necessary, use sand paper to
smoothen the borders.
Se necessario rifila con carta
vetrata per legno eventuali
imperfezioni dei pezzi.

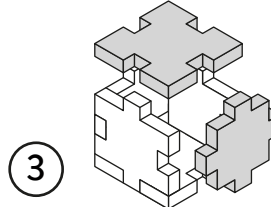

3

Get familiar with
all the pieces
and check the correct assembly
sequence.
Prendi familiarità con tutti
i pezzi, per assicurarti
che la sequenza di assemblaggio sia
corretta.

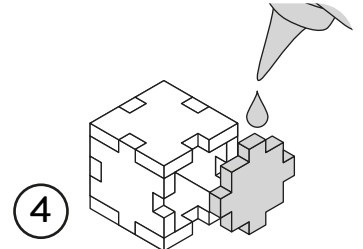

4

Once verified the correct assembly
sequence, just add a small quantity
of PVA glue on every joint.
Dopo aver verificato
la sequenza di assemblaggio
aggiungi una piccola quantità di
colla vinilica su tutti
gli incastri per garantirne
la durata nel tempo.

INSTRUCTIONS

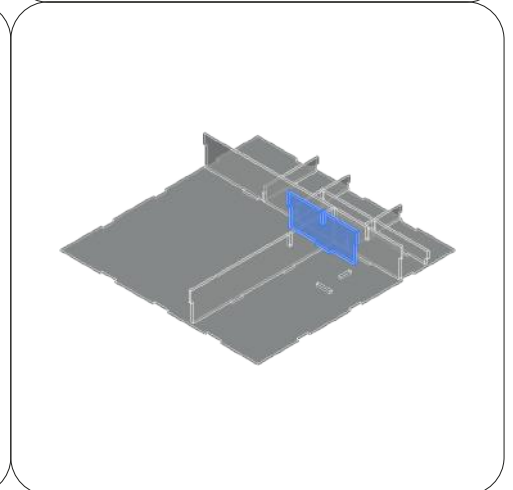
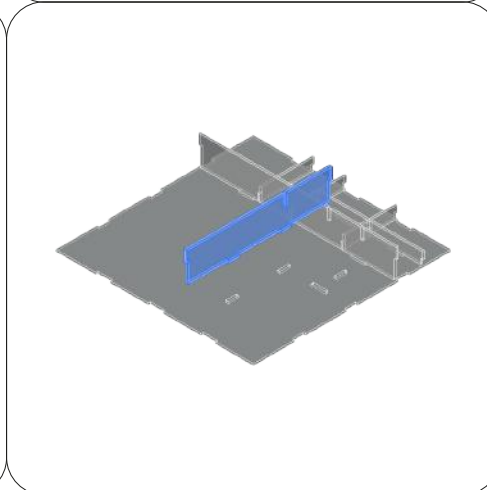
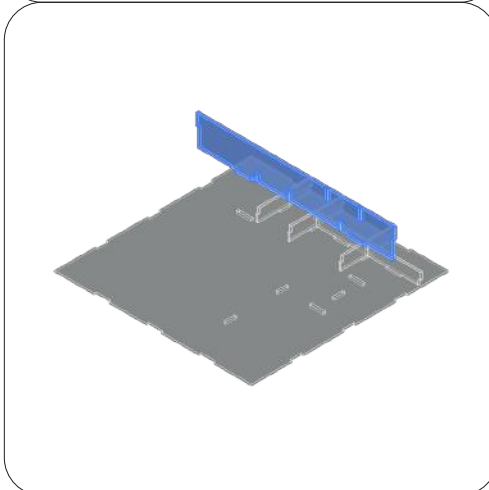
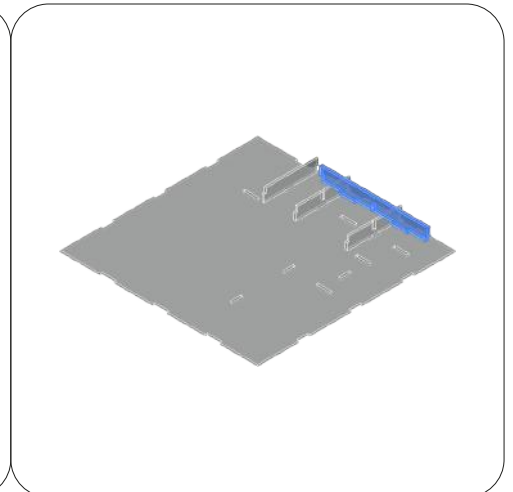
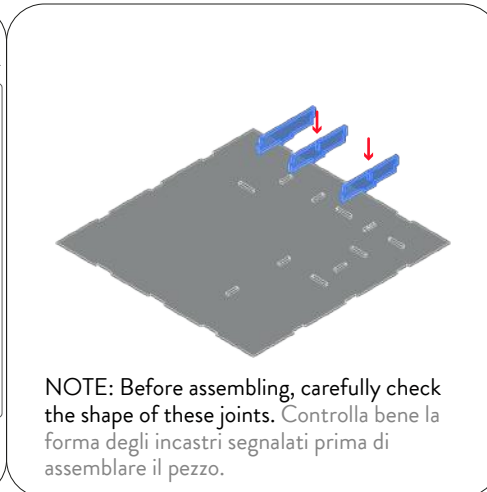
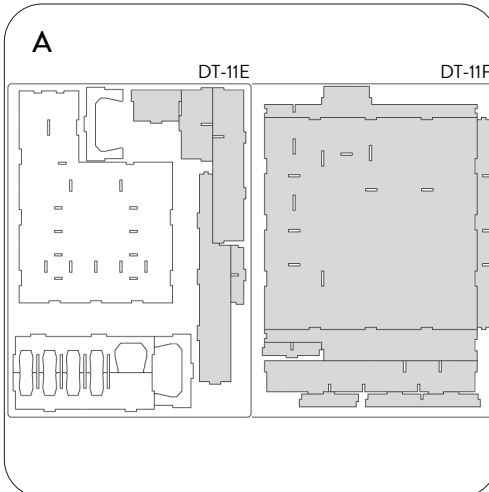

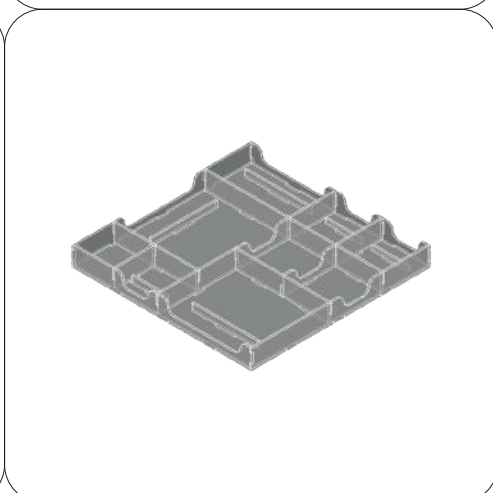
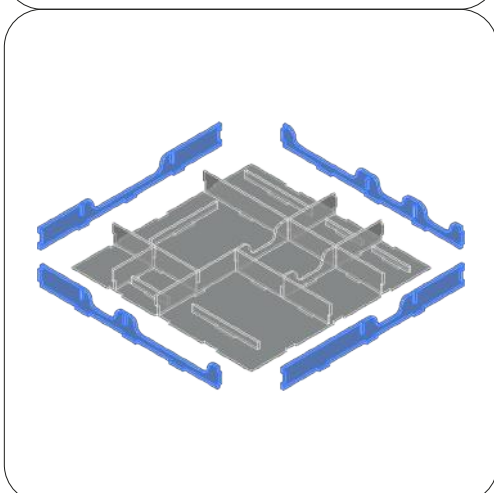
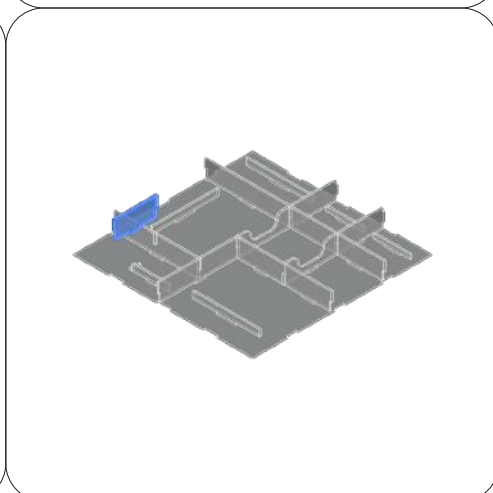
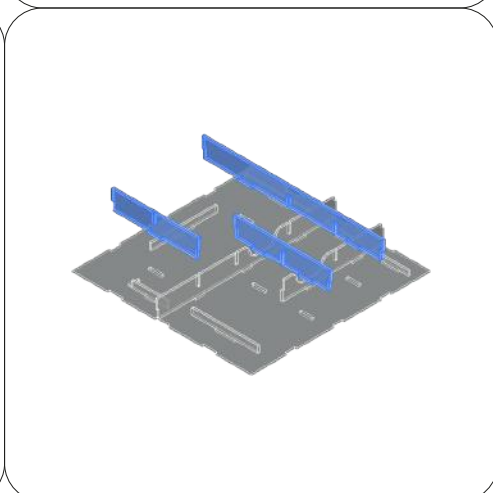
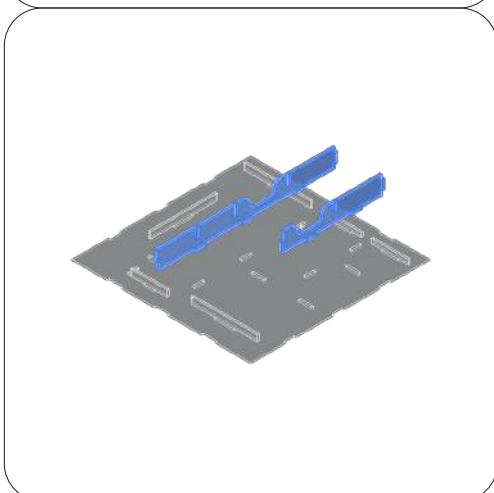
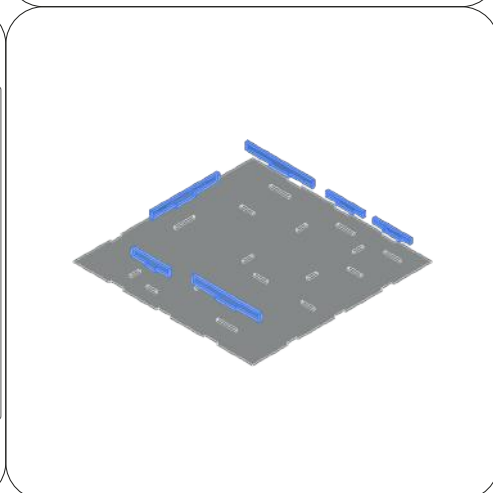
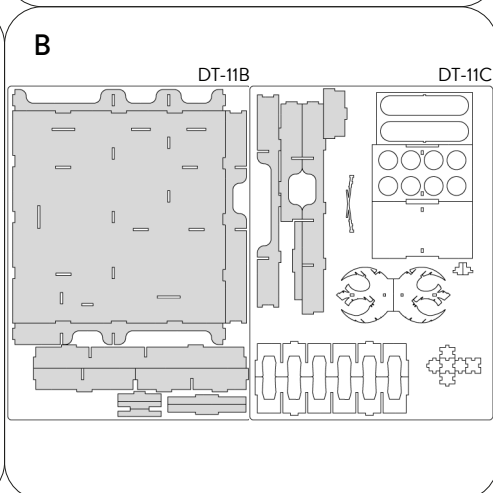
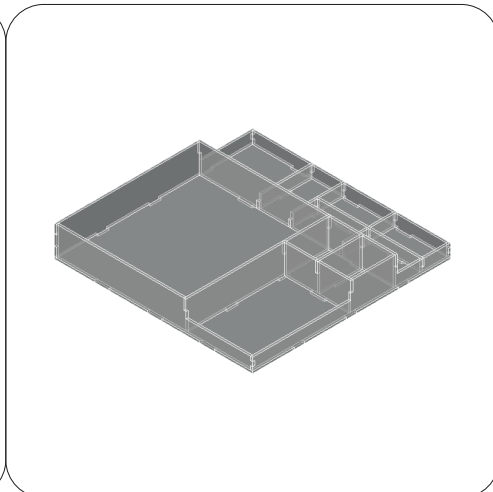
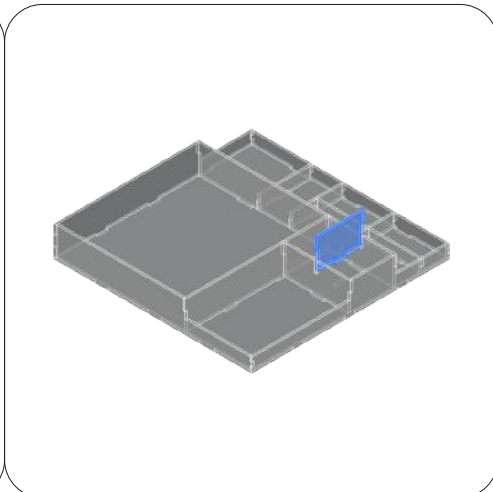
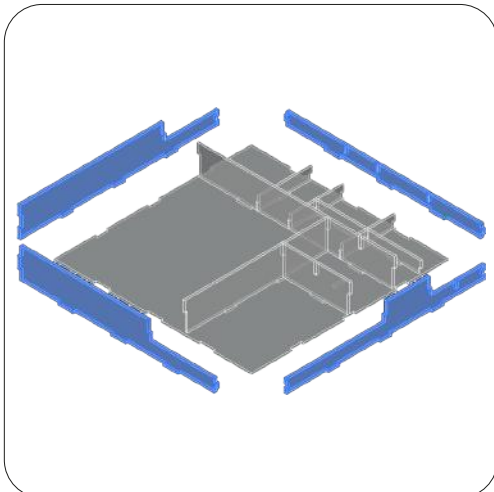

C

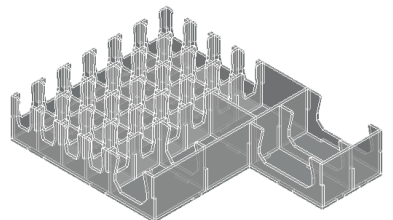
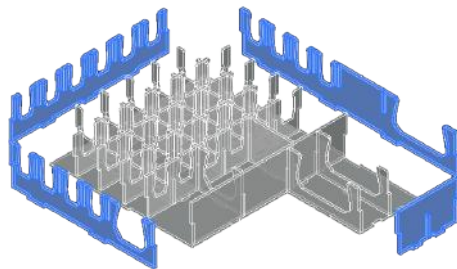
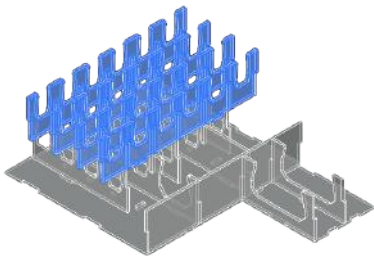
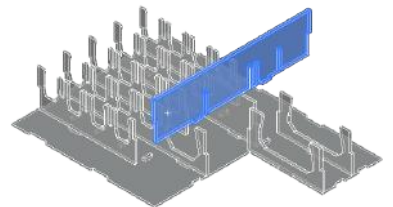
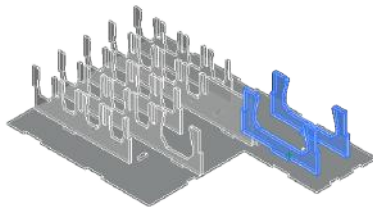
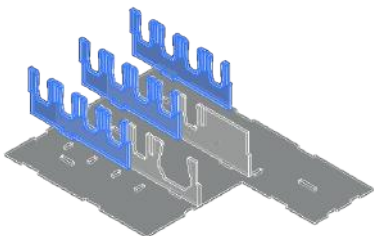
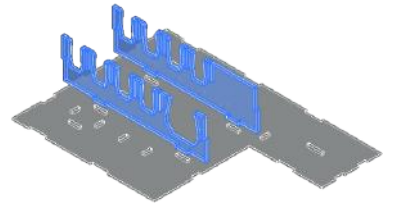
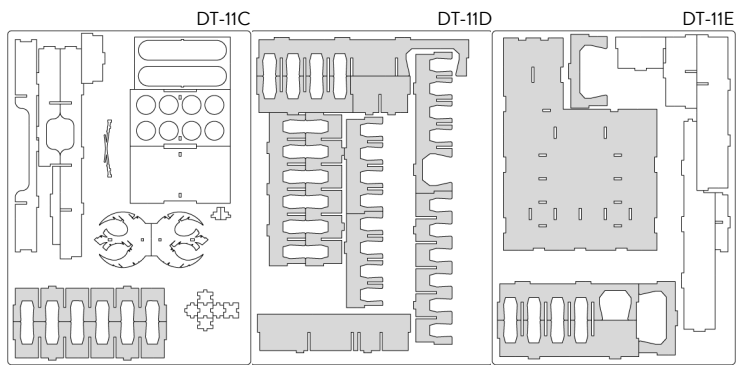

D

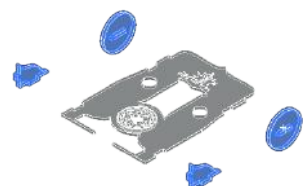
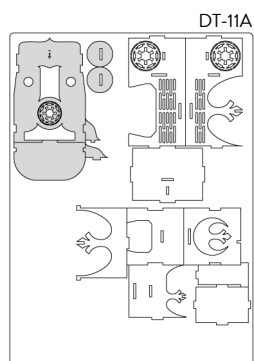

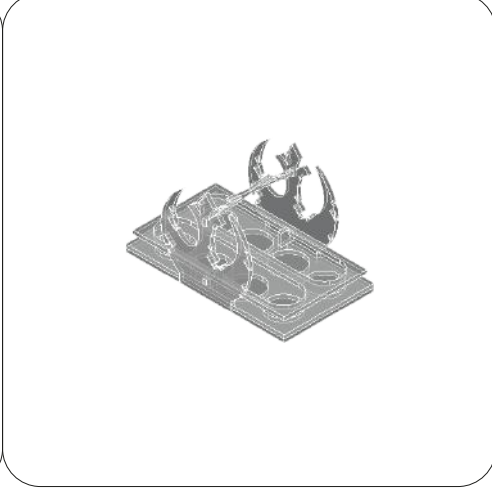
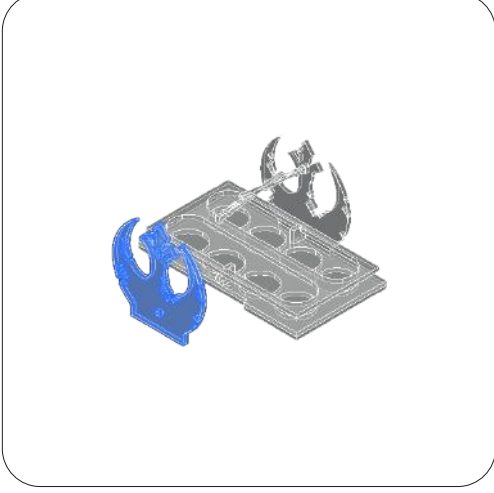
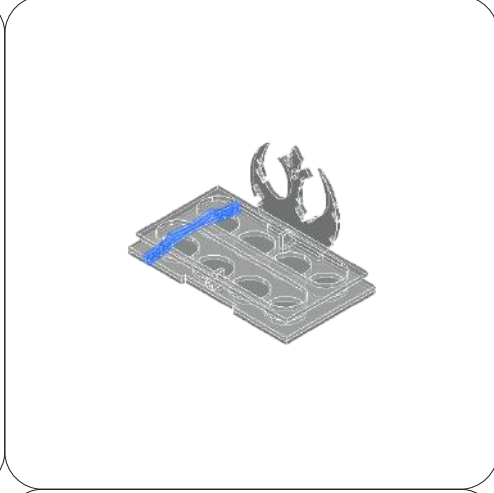
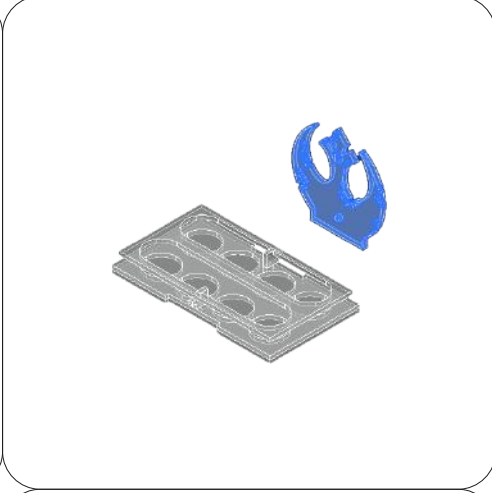
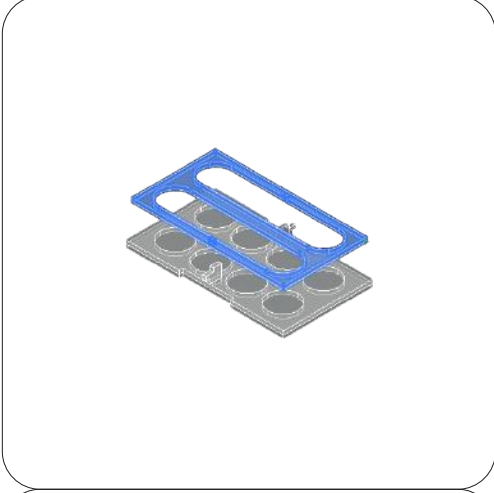
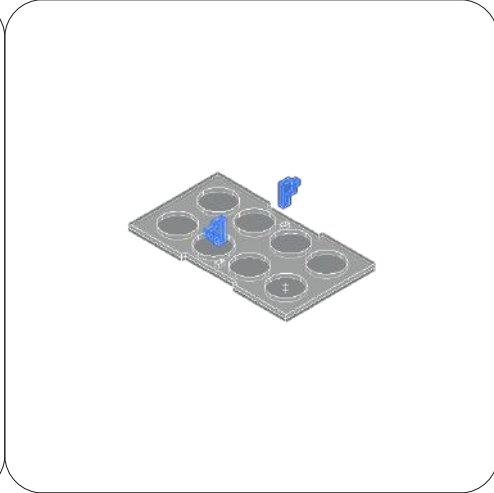
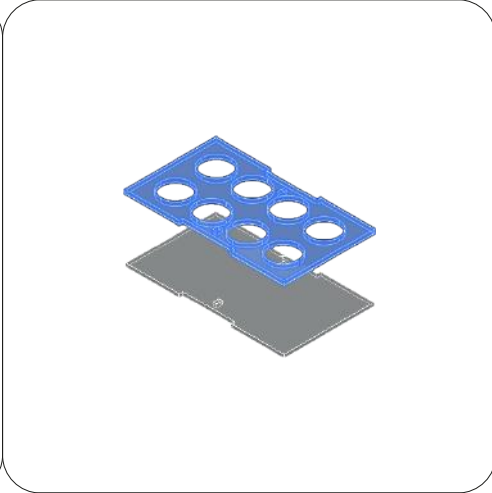
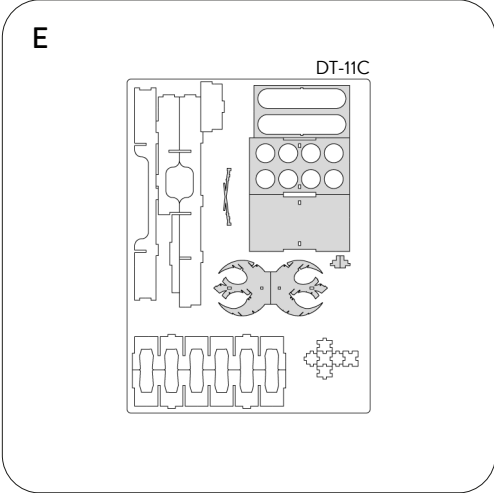
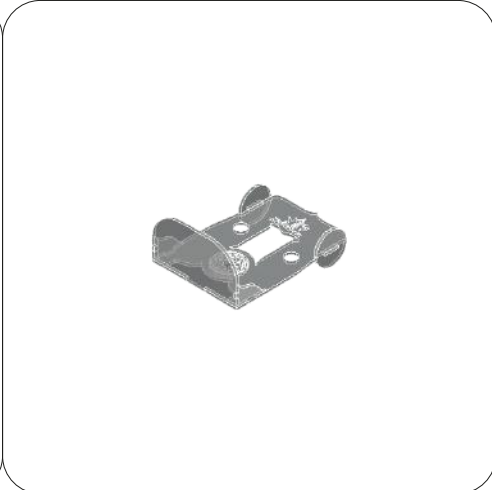
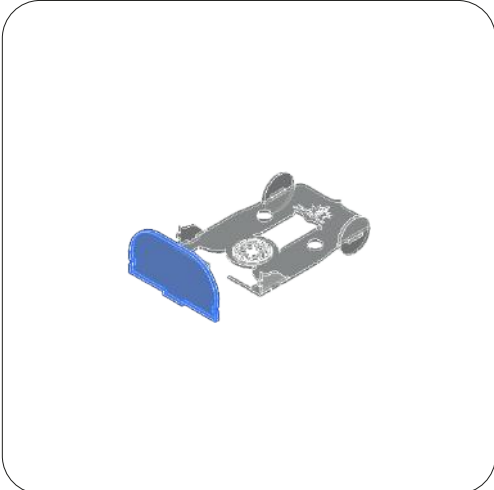

F

DT-11A

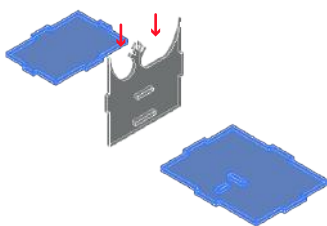
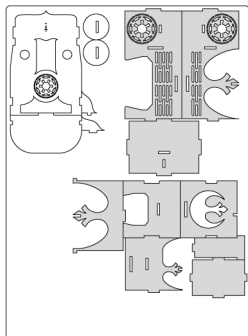

NOTE: Before assembling, carefully check the shape of these joints. Controllate bene la forma degli incastrati segnalati prima di assemblare il pezzo.

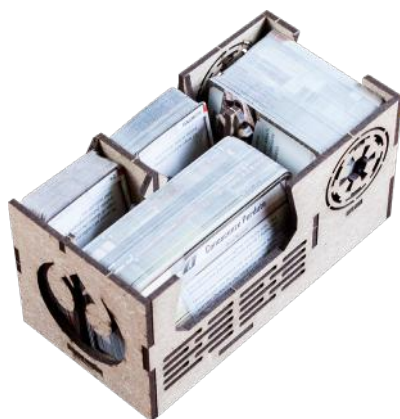
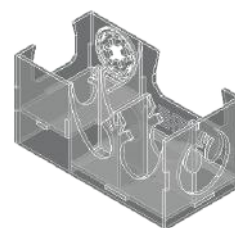
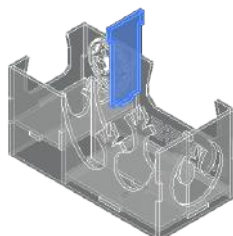
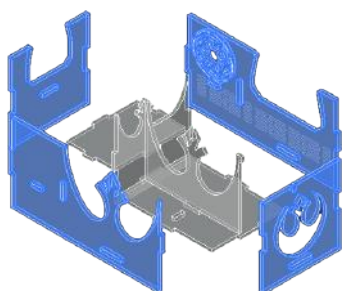
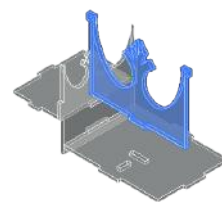

REBOXING SEQUENCE!



Take care, don't overturn the box!
Riporre con cura la scatola, non ribaltare!



Non-recyclable waste
Smaltire i materiali di scarto nell'indifferenziata

All trademarks and copyrights are the property of their respective owners.
This product is not a toy. Contains small parts that can be swallowed or inhaled. 14+